

Block 33., Original Town, McPherson, Kansas.

Woodside Street

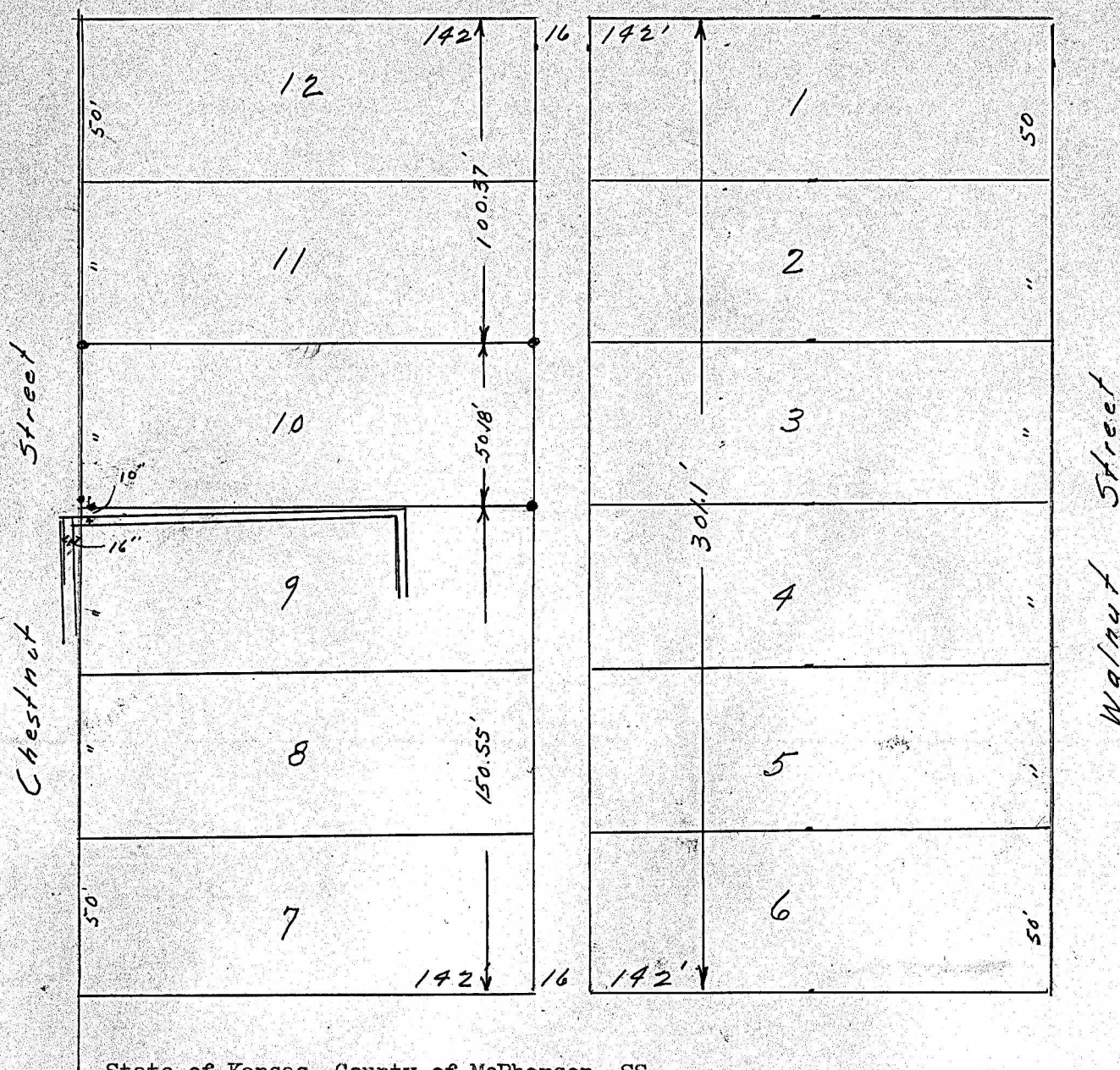

State of Kansas, County of McPherson, SS.

I, G.D.Johnson, Licensed Civil Engineer of the State of Kansas do hereby certify that I did on the 6th, day of February, 1958 survey lot 10, Block Original Town of McPherson, Kansas and that accompanying plat is a true exhibit of said survey.

Ed Johnson

**MICROFILM**

