

A SURVEY OF LOTS 1,2,3,4,5 and 6,  
and lots 7,8, and 9, block 18  
original town of McPherson, Kansas

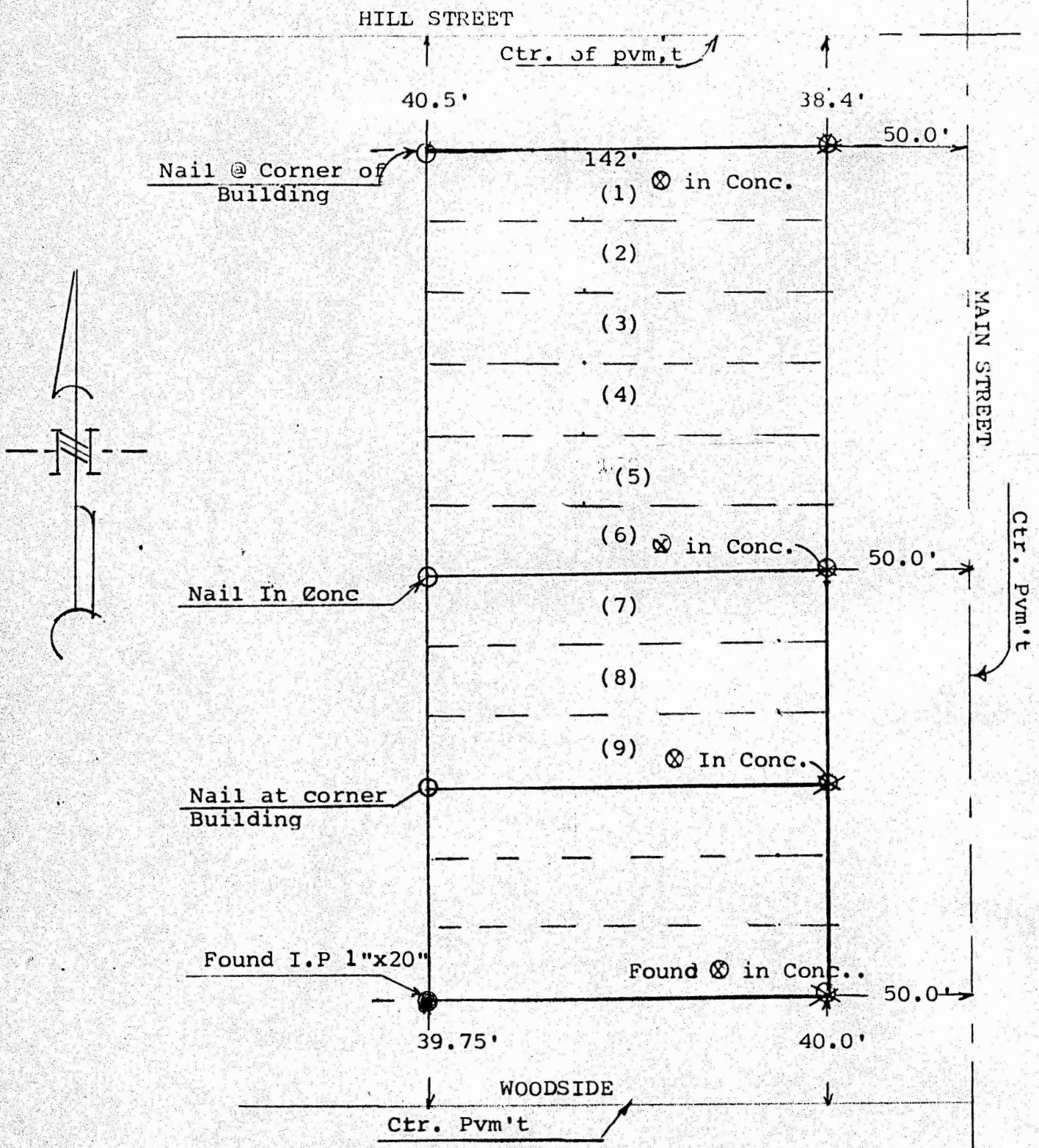

Legend

- I.P. Found
- Nails Set
- ⊗ In Conc.

This survey called for by Gene Copeland for the purpose of determining if any of the buildings were incroaching on other property. I found the north line of the north building to be on the property line. On the south building on 9 and 8, I found the east corner to be 0.15 feet north of the south line of lot (9) and the SW corner of said building to be exactly on the line. I F.R. Rankin a licensed professional engineer in the State of Kansas, Hereby certify the above plat to be a representative survey of said survey performed by me this 21st. day of July 1980.

Signed this 21 day of July 1980 at McPherson, Kansas

F.R. Rankin P.E. #799

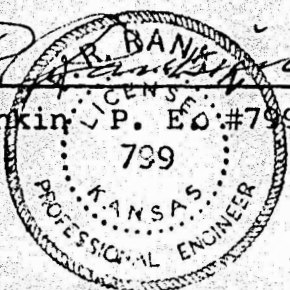

**Franlo Ltd.**  
647 E. Simpson  
McPherson, KS 67460