

A SURVEY OF LOTS 5 & 6 BLOCK TEN(10) ORIGINAL TOWNSITE
 LOTS 5 & 6 BLOCK TEN(10) CASSEL ADDITION

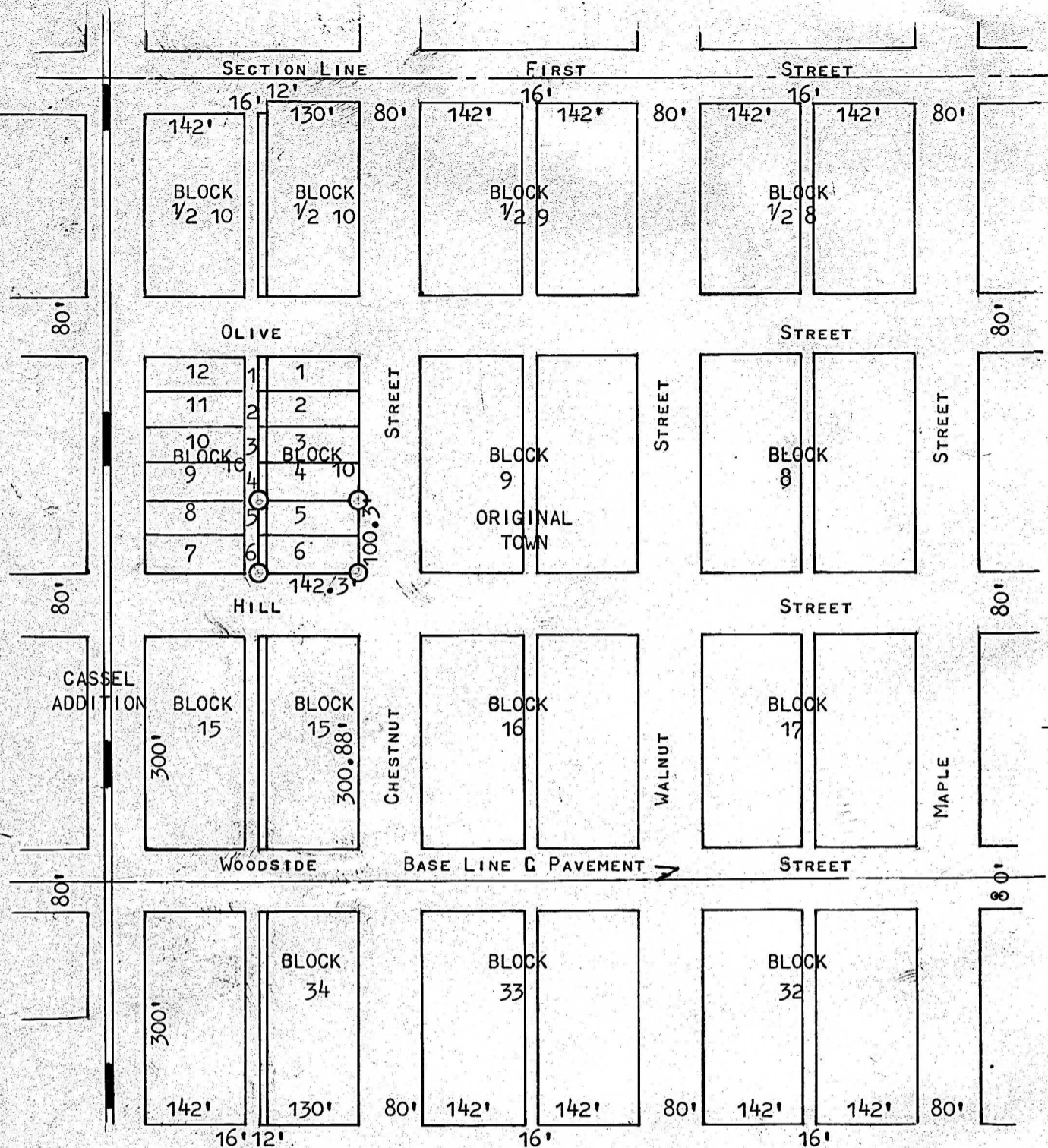

○ PINS SET THIS SURVEY

STATE OF KANSAS)
 COUNTY OF McPHERSON) SS

I, FRANCIS D. WAGNER, COUNTY ENGINEER OF McPHERSON COUNTY, KANSAS,
 DO HEREBY CERTIFY THAT I DID CAUSE TO BE DONE ON THE 18TH DAY OF
 APRIL, 1960 A SURVEY OF LOTS FIVE (5) AND SIX (6) BLOCK TEN (10)
 ORIGINAL TOWNSITE AND LOTS FIVE (5) AND SIX (6) BLOCK TEN (10)
 CASSEL ADDITION TO THE CITY OF McPHERSON, KANSAS, AND THAT THE
 ACCOMPANYING PLAT IS A TRUE EXHIBIT OF SAID SURVEY.

MICROFILM

APRIL 21, 1960

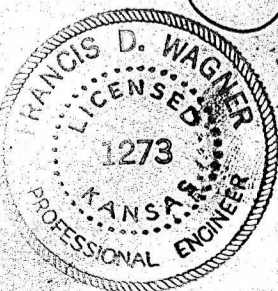

Francis D. Wagner

FRANCIS D. WAGNER
 COUNTY ENGINEER
 McPHERSON COUNTY