

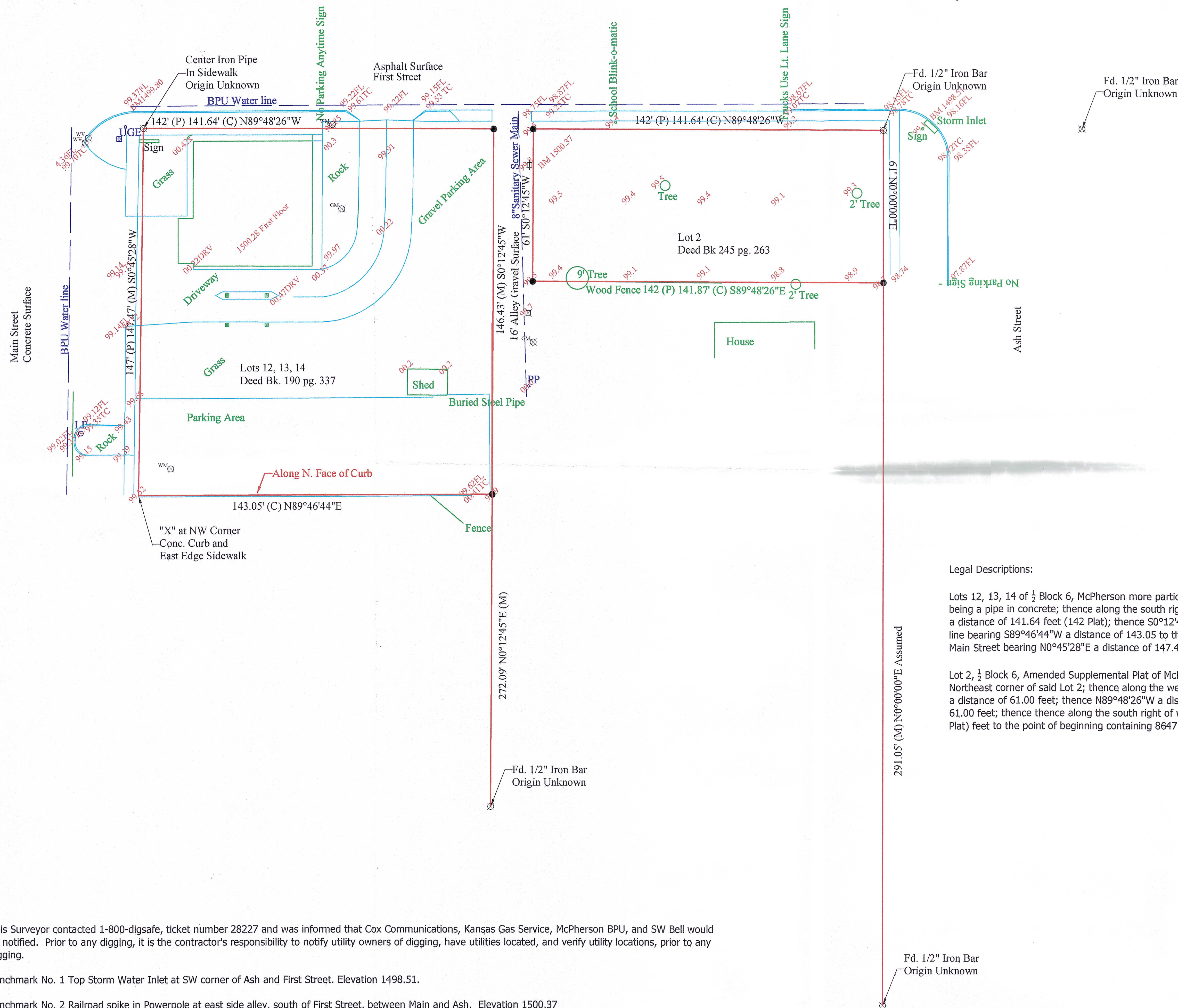











Plat of Survey



LEGEND

- | | |
|--|----------------------------------|
|  | - 1/2" x 24" Iron Rebar Set Cap |
|  | - Survey Monument Found |
|  | - Fence |
| GM  | - Gas Meter |
|  | - Light Pole |
|  | - Power Pole |
| FH  | - Fire Hydrant |
| WM  | - Water Meter |
| WV  | - Water Valve |
|  | - Underground Telephone Pedestal |
| MH  | - Sanitary Sewer Manhole |
| Calc. | - Calculated |
| Desc. | - Described |
| M. | - Measured |
| Pl. | - Platted |

Scale 1 inch = 20 feet

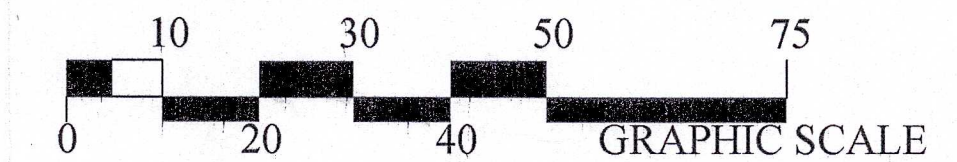

Legal Descriptions:

Lots 12, 13, 14 of $\frac{1}{2}$ Block 6, McPherson more particularly described as follows: Beginning at the NW corner of $\frac{1}{2}$ Block 6 being a pipe in concrete; thence along the south right-of-way of East First Street with an assumed bearing S89°48'26"E a distance of 141.64 feet (142 Plat); thence S0°12'45"W a distance of 146.43 feet (147' Plat); thence along a north curb line bearing S89°46'44"W a distance of 143.05 to the west end of the curb; thence along the east right of way of North Main Street bearing N0°45'28"E a distance of 147.47' (147' Plat) to the point of beginning containing 20,916 sq. ft.

Lot 2, ½ Block 6, Amended Supplemental Plat of McPherson more particularly described as follows: Beginning at the Northeast corner of said Lot 2; thence along the west right of way line of Ash Street on an assumed bearing S0°00'00"W a distance of 61.00 feet; thence N89°48'26"W a distance of 141.87 feet (142 Plat); thence N00°12'45"E a distance of 61.00 feet; thence thence along the south right of way line of East First Street N89°48'26"E a distance of 141.64 (142 Plat) feet to the point of beginning containing 8647 sq. ft.

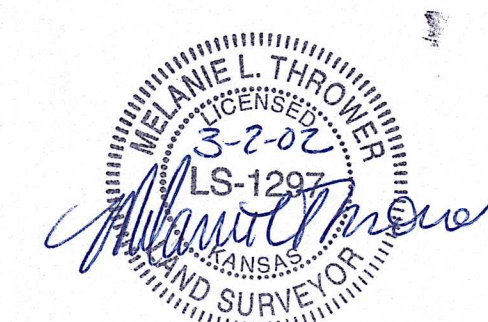

This Surveyor contacted 1-800-digsafe, ticket number 28227 and was informed that Cox Communications, Kansas Gas Service, McPherson BPU, and SW Bell would be notified. Prior to any digging, it is the contractor's responsibility to notify utility owners of digging, have utilities located, and verify utility locations, prior to any digging.

Benchmark No. 1 Top Storm Water Inlet at SW corner of Ash and First Street. Elevation 1498.51.

Benchmark No. 2 Railroad spike in Powerpole at east side alley, south of First Street, between Main and Ash. Elevation 1500.37

Benchmark No. 3 East edge SE curb return at intersection of First and Main, painted white. Elevation 1499.80

**GREAT PLAINS FEDERAL
CREDIT UNION
720 N. Main
McPherson, Kansas**

SURVEY DATE: JAN 26, 2002	Melanie L. Thrower, P.E., L.S.
DESIGNED: MLT DETAILED: MLT	P.O. Box 662 McBriston, Iowa 52160 Phone: (620)241-4950 FAX: (620)241-5086