

9/12/41

PROPERTY OF THE
PIONEER SAVINGS AND LOAN CORP.
McPherson, Kansas

Beginning at a point at the south east corner of Block 103, Original Town, thence North 100.56 Ft. as place of beginning thence North 100.56 Ft., thence West 142.0 ft. , thence South 100.56 ft., thence East 142.0 ft., to place of beginning.

Neal Harr
City Engineer.

SOUTHERLAND

ST

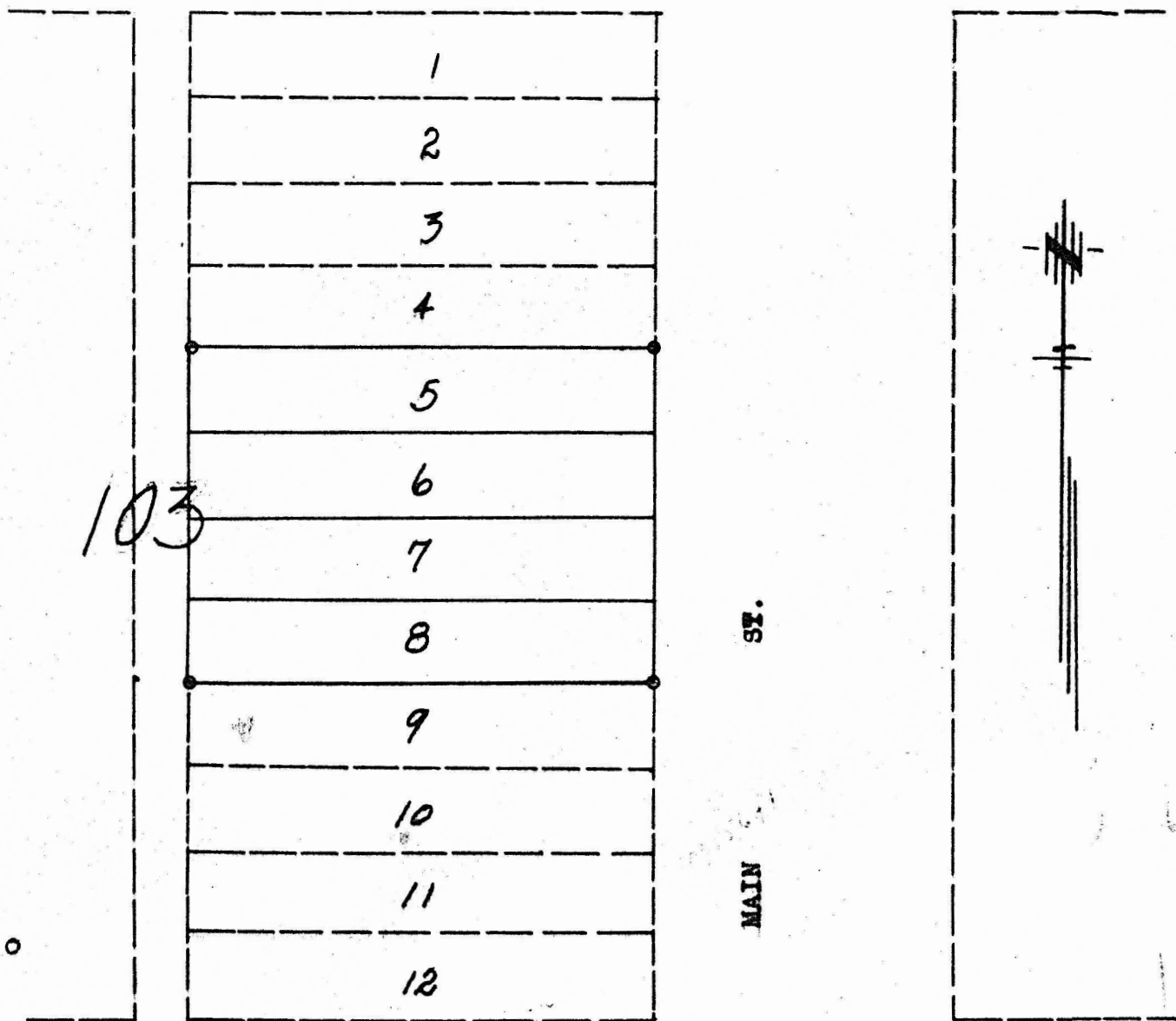

SKANCKE

ST.

MICROFILM