

A SURVEY OF LOT 1 AND THE NORTH 1/2 OF LOT 3  
CHESTNUT STREET, HIGHLAND ADDITION  
LINDSBORG, KANSAS

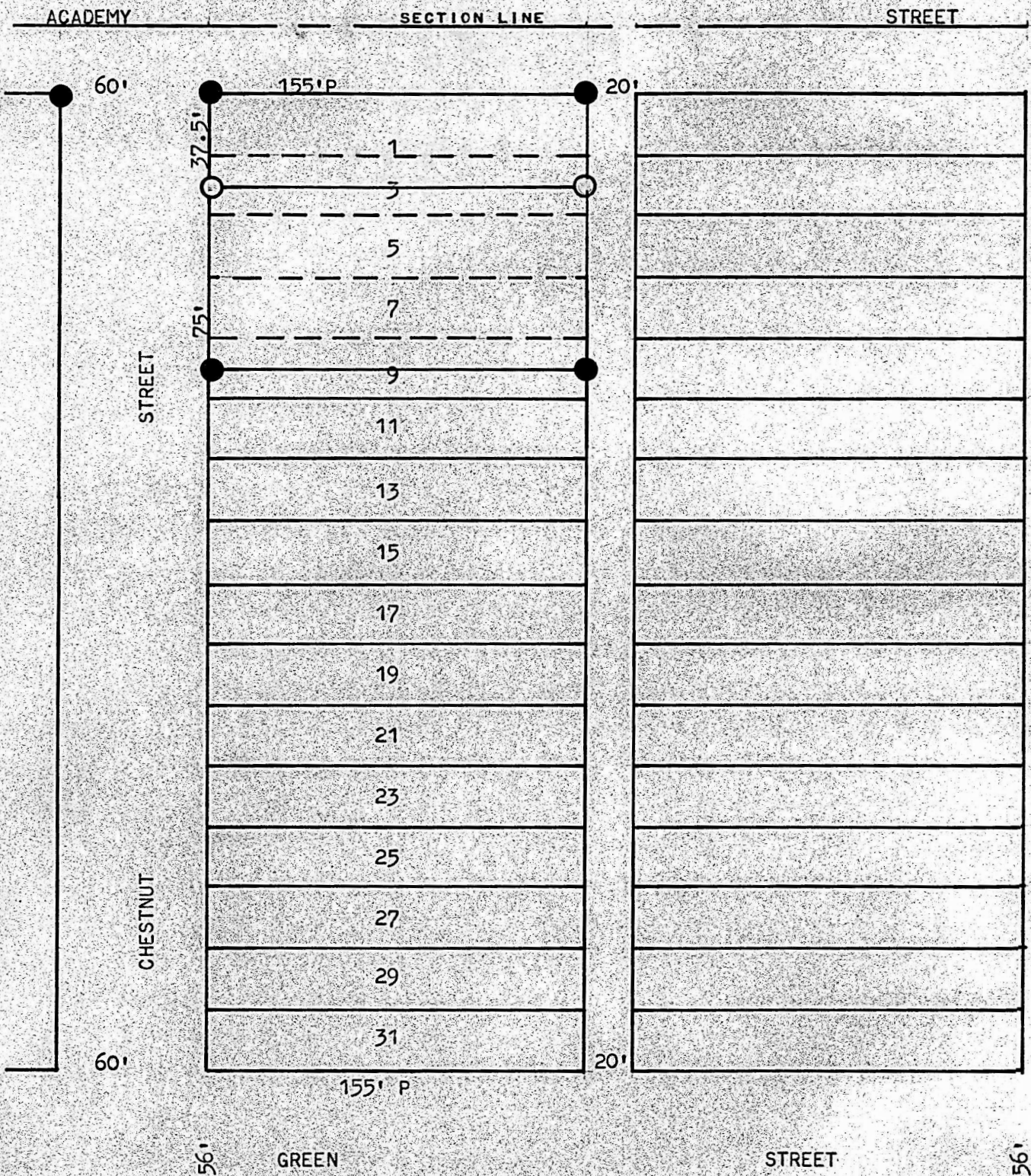

● PINS FOUND THIS SURVEY

○ PINS SET THIS SURVEY

STATE OF KANSAS )  
COUNTY OF MCPHERSON ) SS

I, FRANCIS RANKIN, COUNTY ENGINEER OF MCPHERSON COUNTY, KANSAS, DO HEREBY CERTIFY THAT UNDER MY SUPERVISION A SURVEY WAS MADE OF LOT 1 AND THE NORTH 1/2 OF LOT 3, CHESTNUT STREET, HIGHLAND ADDITION TO THE CITY OF LINDSBORG, KANSAS, AND THAT THE ACCOMPANYING PLAT IS A TRUE EXHIBIT OF SAID SURVEY AS FAR AS IT IS KNOWN TO ME.

SURVEY CALLED FOR BY DARYL BORG.

SIGNED THIS 5 DAY OF JUNE, 1972.

*Francis Rankin*

FRANCIS RANKIN  
COUNTY ENGINEER  
MCPHERSON COUNTY, KANSAS

