

SURVEY
HIGHLAND ADDITION
CITY OF LINDBURG

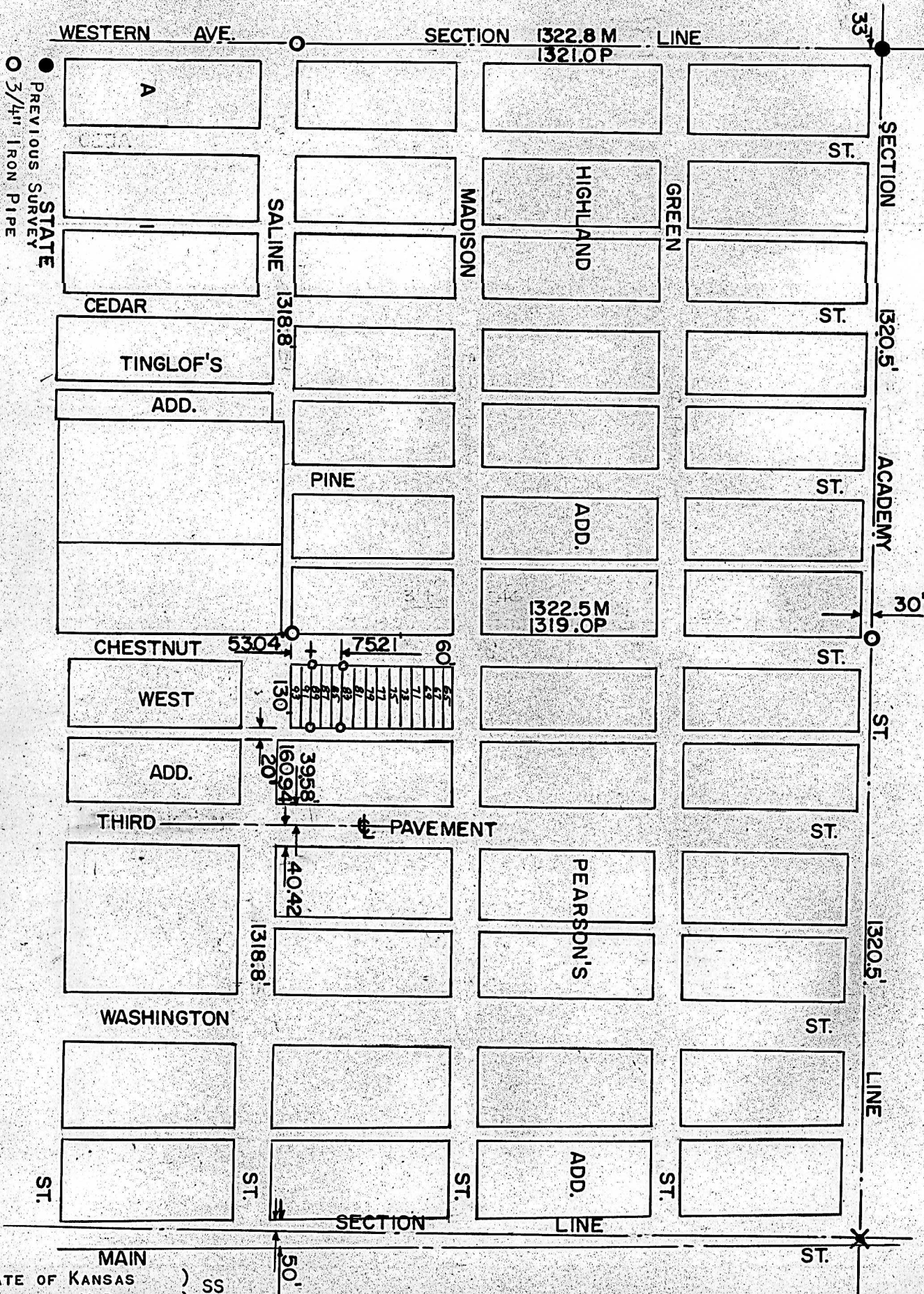

STATE OF KANSAS)
COUNTY OF McPHERSON) SS

I, FRANCIS D. WAGNER, COUNTY ENGINEER OF McPHERSON COUNTY, KANSAS DO HEREBY CERTIFY THAT I DID CAUSE TO BE DONE ON THE 8TH DAY OF JANUARY, 1959 A SURVEY DESCRIBED AS FOLLOWS: