

H. A. ROWLAND • Kansas Licensed Civil Engineer

B11  
Freeman  
Carns  
Carns W R  
927 N 13th

Member

National Society Professional Engineers  
Kansas Society Professional Engineers  
Kansas Engineering Society

PHONE 796 X

McPHERSON, KANSAS

Scale 1 in for 50 feet.

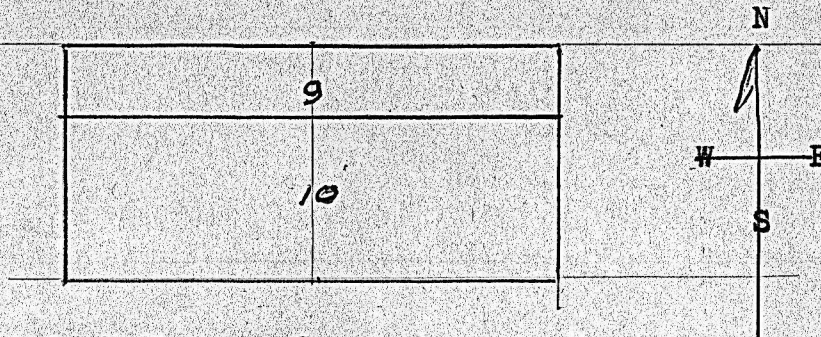

STATE OF KANSAS, McPherson County, ss.,

THIS is to Certify, that the above plat is in accordance with a survey made by of a tract of land consisting of the South one-half of Lot 9 and Lot 10 of Freeman Addition to McPherson in Block 11. The corners were marked by iron pins.  
Dated at McPherson, Kas., Sep. 24th 1950.

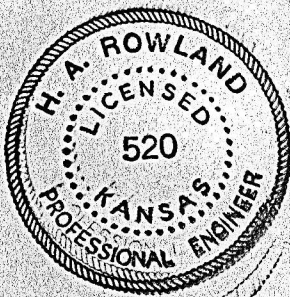

*H. A. Rowland*

Registered Professional Engineer.

2/4/1.35  
20.67  
629.02