

Melanie L. Thrower, P.E., L.S.
P.O. Box 662
McPherson, KS 67460
241-0950 FAX 241-5086



SCALE 1"=30'

LEGEND



Structure

— Lot Line



Property Corners Found Iron Bar



Concrete

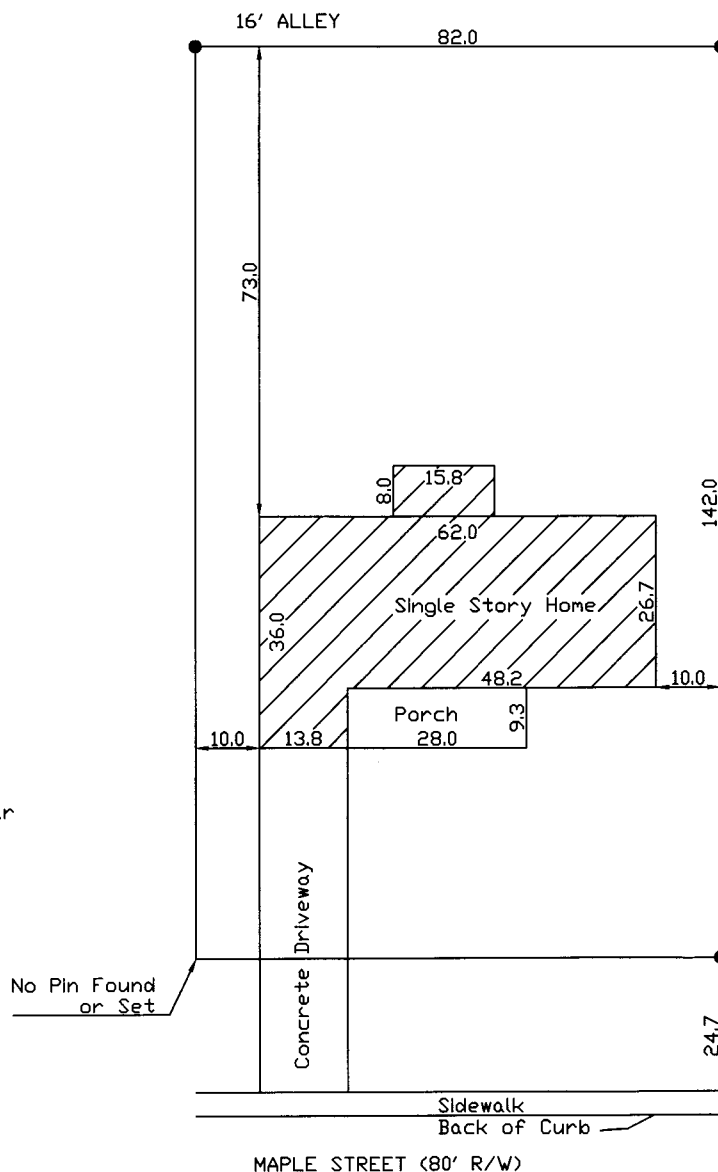

Melanie L. Thrower, Registered Land Surveyor in the State of Kansas, certifies that on May 9, 2000, the property described as follows:

Address: 1368 N. Maple, McPherson, Kansas

Legal Description: North 30' of Lot 18, all of Lot 19, and the South 2' of Lot 20, Block 28, Fairmont Addition was properly inspected and the pins located as shown. This sketch is a true representation of the conditions that were found at the time of the inspection. No property corners were set. This Land Surveyor does not extend a warranty to the present or future owners or occupants.

SIGNED THIS 9th DAY OF May, 2000.

MELANIE L.THROWER