

Melanie L. Thrower, Registered Land Surveyor in the State of Kansas, certifies that on October 16, 2009, a survey of the tracts herein described was made by myself and the results, to the best of my knowledge, information, belief and in my professional opinion are true and correct as shown on this plat of survey.

Survey was made as per client request and no title work has been provided to the surveyor. The number and extent of easements and or right-of way of record affecting said property has not been addressed by this survey.

Reviewed by the Unified Government Surveyor this 22nd day of October 2009. This Survey has been reviewed for filing, pursuant to K.S.A. 58-2005 and K.S.A. 58-2011 for content only and is in compliance with those provisions. No other warranties are extended or implied.

Deputy County Survey, McPherson County, William B. Heller

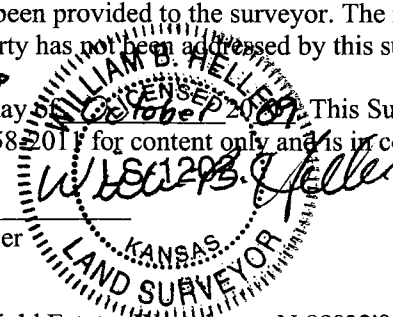

Block 1 A

Beginning at the Northwest corner of Lot 1 Block 1 Deerfield Estates West thence N 89°32'06" E, 108.00' along the north line of said Lot 1; thence S 00°27'54" E, 8.89'; thence S 38°12'04" W, 133.73' to a curve to the right with radius 95.00' and chord bearing N 25°36'26" W; thence along said curve 84.17'; thence N 00°13'31" W, 6.60'; thence N 44°46'29" E, 14.14'; thence N 00°13'31" W, 23.00' to the point of beginning containing 7969.68 sq ft more or less. Precision: 1:15498.24

Block 1 B

Commencing at the Northwest corner of Lot 1 Block 1 Deerfield Estates West; thence N89°32'06"E along the north line of said Lot 1, 108.00'; thence S 00°27'54" E, 8.89' to the point of beginning; thence S 00°27'54" E, 126.09'; thence S 89°32'06" W, 23.16' to a curve of radius 95.00' with chord bearing N 70°43'38" W; thence along said curve 65.45'; thence N 38°12'04" E, 133.73' to the point of beginning containing 5758.63 sq ft more or less. Precision: 1:74534.16

Block 1 C

Commencing at the Northwest corner of Lot 1 Block 1 Deerfield Estates West; thence N89°32'06"E along the north line of said Lot 1, 108.00' to the point of beginning; thence N 89°32'06" E, 36.92'; thence S 00°27'54" E, 134.99'; thence S 89°32'06" W, 36.92'; thence N 00°27'54" W, 134.98' to the point of beginning containing 4983.83 sq ft more or less. Precision: 1:34381.00

Block 1 D

Commencing at the Northwest corner of Lot 1 Block 1 Deerfield Estates West; thence N89°32'06"E along the north line of said Lot 1, 144.92' to the point of beginning; thence N 89°32'06" E, 40.04'; thence S 00°27'54" E, 134.99'; thence S 89°32'06" W, 40.04'; thence N 00°27'54" W, 134.99' to the point of beginning containing 5405.00 sq ft more or less. Precision: Perfect

Block 1 E

Commencing at the Northwest corner of Lot 1 Block 1 Deerfield Estates West; thence N89°32'06"E along the north line of said Lot 1, 184.96' to the point of beginning; thence N 89°32'06" E, 40.04'; thence S 00°27'54" E, 135.00'; thence S 89°32'06" W, 40.04'; thence N 00°27'54" W, 134.99' to the point of beginning containing 5405.40 sq ft more or less. Precision: 1:35007.00

Block 1 F

Commencing at the Northwest corner of Lot 1 Block 1 Deerfield Estates West; thence N89°32'06"E along the north line of said Lot 1, 225.00' to the point of beginning; thence N 89°32'06" E, 40.04'; thence S 00°27'54" E, 135.01'; thence S 89°32'06" W, 40.04'; thence N 00°27'54" W, 135.01' to the point of beginning containing 5405.80 sq ft more or less. Precision: Perfect

Block 1 G

Commencing at the Northwest corner of Lot 1 Block 1 Deerfield Estates West; thence N89°32'06"E along the north line of said Lot 1, 265.04' to the point of beginning; thence N 89°32'06" E, 40.04'; thence S 00°27'54" E, 135.01'; thence S 89°32'06" W, 40.04'; thence N 00°27'54" W, 135.01' to the point of beginning containing 5405.80 sq ft more or less. Precision: Perfect

Block 1 H

Commencing at the Northwest corner of Lot 1 Block 1 Deerfield Estates West; thence N89°32'06"E along the north line of said Lot 1, 305.08' to the point of beginning; thence N 89°32'06" E, 38.11'; thence S 00°27'54" E, 135.02'; thence S 89°32'06" W, 38.10'; thence N 00°27'54" W, 135.01' to the point of beginning containing 5144.26 sq ft more or less. Precision: 1:24482.87

LOT SPLIT SURVEY

Page 1 of 2

Melanie L. Thrower, P.E., L.S.
1457 N. High Dr.
McPherson, KS 67460
(620) 241-241-5086

Survey for
Nick Vontz

