

- LEGEND
- BAR FOUND
 - ⊙ 5/8" BAR SET
 - △ SECTION COR FD

DESCRIPTION: A SPLIT OF LOTS 2, 3, 4, & 5, BLOCK 1
COUNTRY SIDE HEIGHTS ADDITION TO THE CITY OF McPHERSON
McPHERSON COUNTY KANSAS, ALL IN SEC 21, T 19 S, R 3 W;

LOT 2 AND THE WEST 23.75 FEET OF LOT 3;

THE EAST 71.25 FEET OF LOT 3 AND THE WEST HALF OF LOT 4

THE EAST HALF OF LOT 4 AND LOT 5

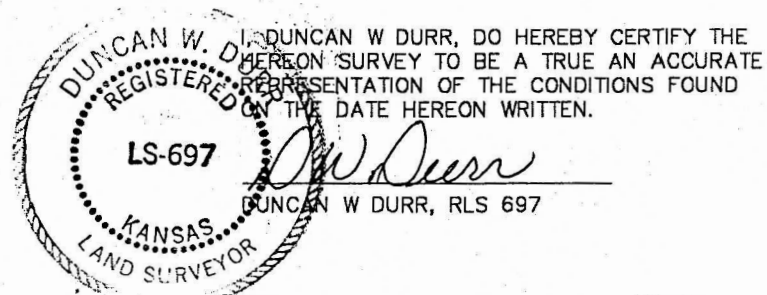

DRAWN BY: DARR	REVISIONS	PROJECT 99078	SHT. NAME	SHT. NO.
DATE: 6-29-99		A SPLIT OF LOTS 2 - 5	DARR ENGINEERING & SURVEYING	
DWG. NO.: 99078		BLOCK 1 COUNTRY SIDE HEIGHT	525 HOWARD	1 OF 1
APPROVED BY:		FOR RITA PERRIN	HUTCHINSON, KS 67501	
			316-663-9613	