

NOTE:

Survey was made as per client request and no title work has been provided to the surveyor; therefore, the number and extent of easements and/or rights-of-way of record affecting the surveyed property has not been addressed by this Survey.

LEGEND

- - Survey Monument Found
- - 5/8" x 24" Iron Rebar Set w/GSS CLS 52 Cap
- (C) - Calculated
- (M) - Measured
- (PL) - Platted
- (R) - Record measurement
- (PS) - Previous Survey GSS Project #G2019-241
- P.O.B. - Point of Beginning
- P.O.C. - Point of Commencement

DESCRIPTION:

PARCEL 1

A portion of Lot 27, Block 3, East College Addition to the City of McPherson, Kansas, described as follows:

Commencing at the Southeast corner of Lot 31 of said Block 3; thence on a NAD 83 Kansas South Zone bearing of South 89°08'25" West on the South line of said Block 3 a distance of 100.95 feet to the Southeast of Lot 27 of said Block 3; thence continuing South 89°08'25" West on the South line of said Lot 27 a distance of 8.12 feet to the point of beginning; thence continuing South 89°08'25" West on said South line a distance of 14.60 feet to the East line of the West 2.50 feet (Record) of said Lot 27; thence North 00°28'03" West on said East line a distance of 156.11 feet to the centerline of the vacated alley of said Block 3; thence North 89°29'22" East on said centerline a distance of 12.69 feet; thence South 01°10'08" East a distance of 156.03 feet to the point of beginning.

Containing 2,129 Square Feet and subject to any easements or restrictions of record.

PARCEL 2

Lot 27, Lot 28, Lot 29, Lot 30 and Lot 31, Block 3, East College Addition to the City of McPherson, Kansas EXCEPT the West 2.50 feet of said Lot 27 and except the following described portion of said Lot 27:

Commencing at the Southeast corner of Lot 31 of said Block 3; thence on a NAD 83 Kansas South Zone bearing of South 89°08'25" West on the South line of said Block 3 a distance of 100.95 feet to the Southeast of Lot 27 of said Block 3; thence continuing South 89°08'25" West on the South line of said Lot 27 a distance of 8.12 feet to the point of beginning; thence continuing South 89°08'25" West on said South line a distance of 14.60 feet to the East line of the West 2.50 feet (Record) of said Lot 27; thence North 00°28'03" West on said East line a distance of 156.11 feet to the centerline of the vacated alley of said Block 3; thence North 89°29'22" East on said centerline a distance of 12.69 feet; thence South 01°10'08" East a distance of 156.03 feet to the point of beginning.

The resulting parcel contains 17,138 Square Feet and subject to any easements or restrictions of record

SURVEYOR'S CERTIFICATE:

I hereby certify this plat to be a true, correct and complete representation of the property described hereon, as surveyed under my supervision, this 25th day of November, 2019

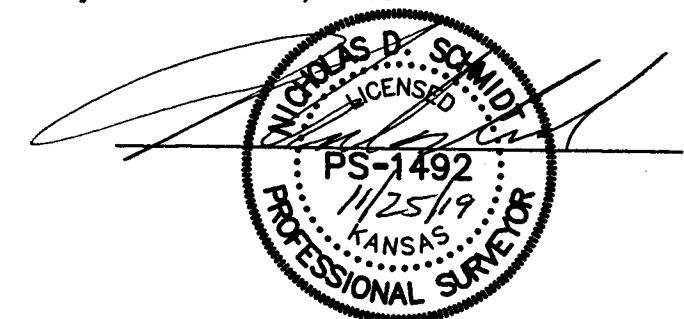

Prepared For:	Description:		
GERRY TILLET	LOTS 25 - 31, BLOCK 3 EAST COLLEGE ADDITION McPHERSON, KANSAS		
Prepared By:	Garber Surveying Service, P.A.		
HUTCHINSON (Main Office)	2908 North Plum St. 67502	Ph. 620-665-7032	Fax 620-663-7401
McPHERSON (Branch Office)	115 East Marlin 67460	Ph. 620-241-4441	Fax 620-241-4458
NEWTON (Branch Office)	511 North Poplar St. 67114	Ph. 316-283-5053	Fax 316-283-5073
MANHATTAN (Branch Office)	3226 Kimball Ave Ste.#2 66503	Ph. 785-320-4810	
Drawn By: KDZ	Scale: 1"=20'	Date of Field Work: November 6, 2019	Job No:
Checked By: NDS	Date: 11/25/2019	Sheet 1 of 1 Sheet(s)	G2019-769