

September 20, 1952

Lots 20 & 21
Block 15
College Place
City of
McPherson

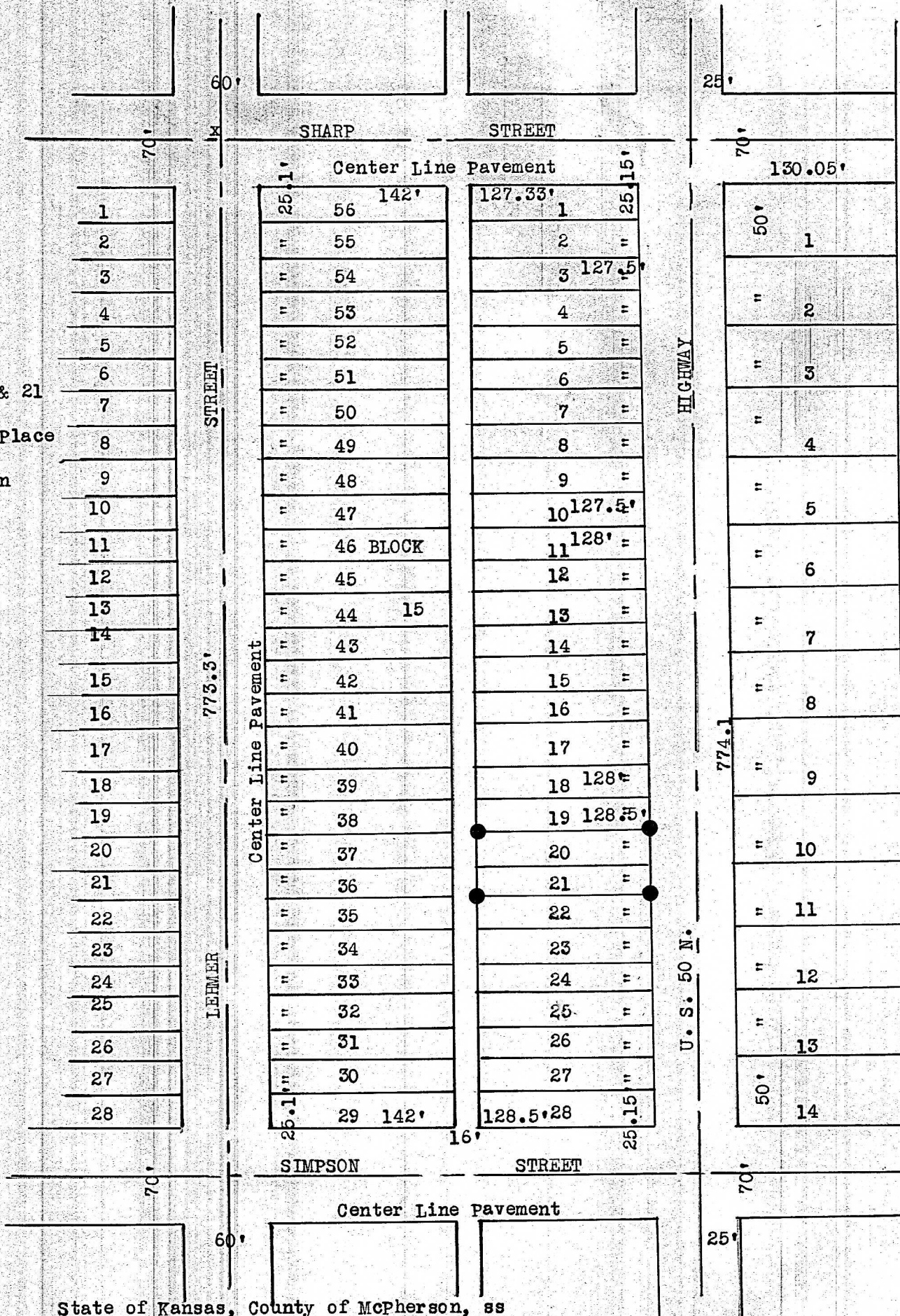

State of Kansas, County of McPherson, ss

I, Francis D. Wagner, County Engineer of McPherson County, Kansas did on the 20th day of September 1952 a survey that determined the corners of lots 20 and 21, Block 15, College Place Addition in the City of McPherson, except that portion taken for highway purposes, and that the accompanying plat is a true exhibit of said survey.

FRANCIS D. WAGNER
County Engineer
McPherson County

MICROFILM