

South 40 Feet of Lot 6, Block 2, Clarke's Addition,
McPherson, Kansas

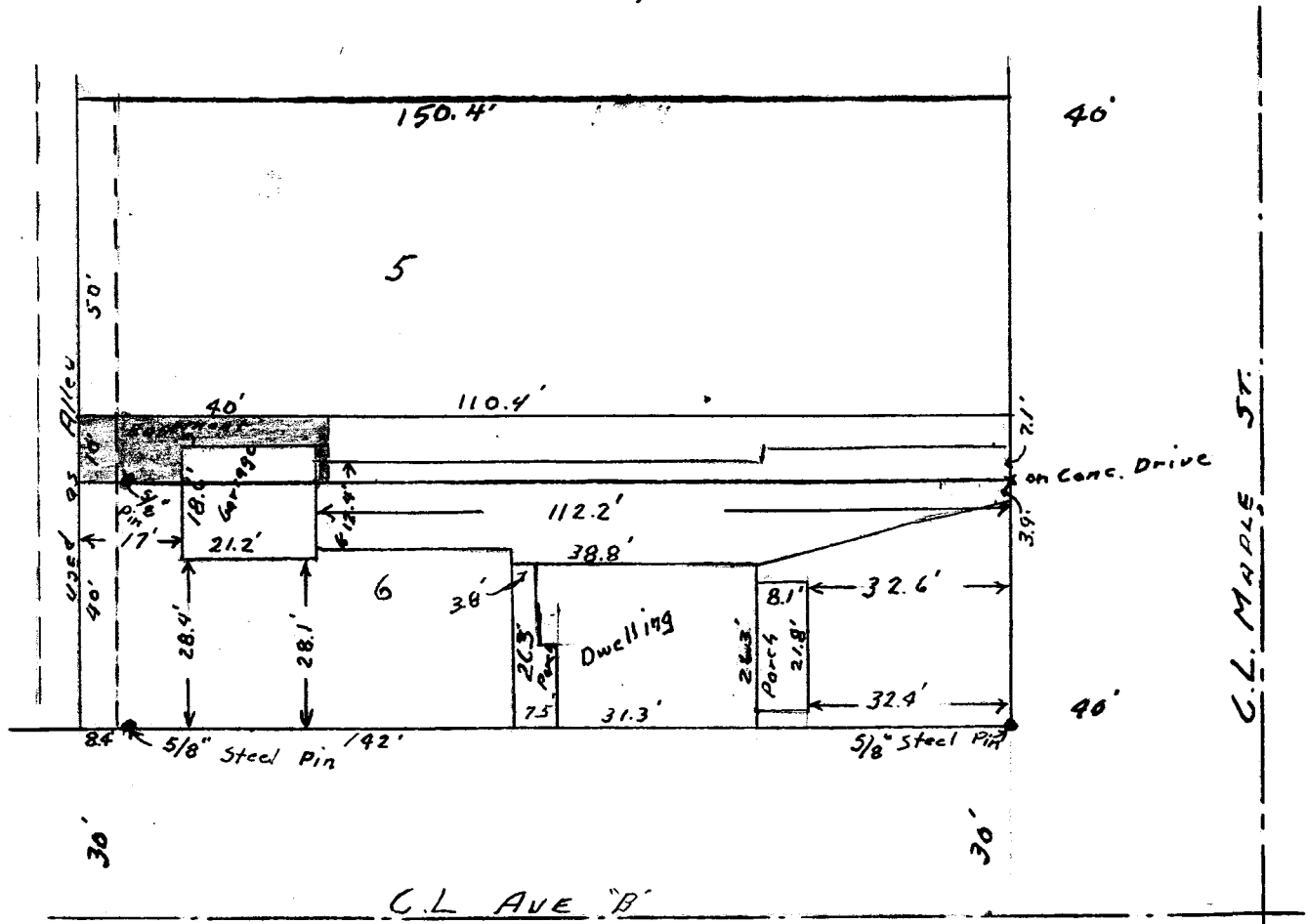

State of Kansas, County of McPherson, SS.

I, G.D. Johnson, Licensed Civil Engineer of the State of Kansas do hereby certify that I did on the 16th. day of March, 1961 survey the South 40 feet of Lot 6, Block 2, Clarke's Addition to the City of McPherson, Kansas and determined location of Improvements on said lot. An X was chiseled at the northeast corner on concrete driveway and 5/8" steel pins were placed at the other corners. The garage is constructed within the easement of part of north 10 feet of lot 6.

I also certify that accompanying plat is a true exhibit of said survey.

G. D. Johnson
G. D. Johnson, Engineer.

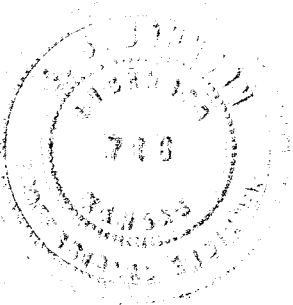

MICROFILM