

(Copy)

October 14, 1950

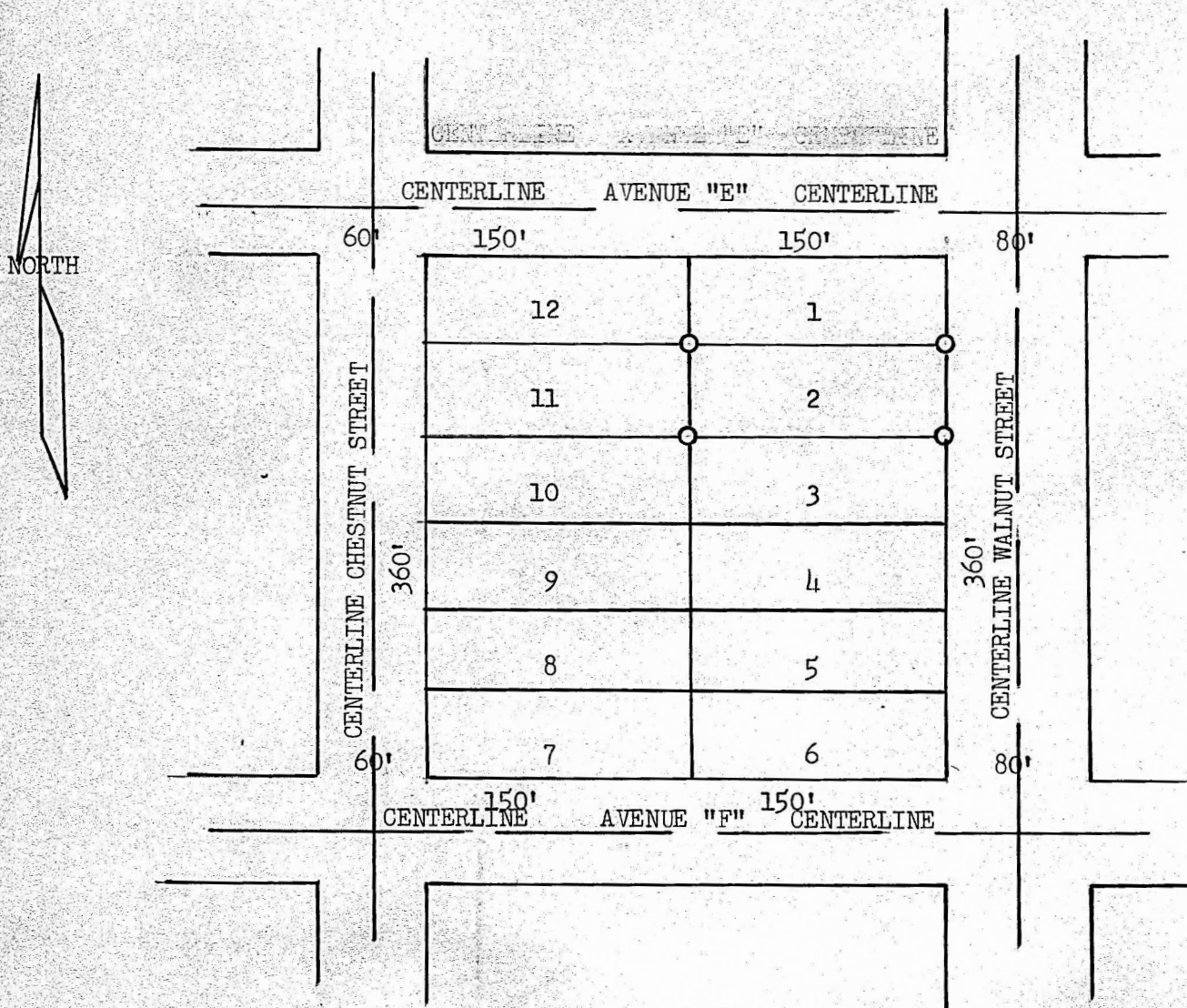

State of Kansas, County of McPherson, ss

I, James F. Meisner, Acting County Engineer of McPherson County, Kansas, do hereby certify that I did cause to be made on the 14th day of October, 1950, a survey of Lot 2, Block 11, Clarke's 3rd Addition to the City of McPherson, Kansas, and that the accompanying plat is a true and correct exhibit of said survey.

JAMES F. MEISNER
Acting County Engineer
McPherson County