

- LEGEND**
- - Survey Monument Found
 - - 5/8" x 24" Iron Rebar Set w/G.S.S. Cap
 - ✱ - "X" Cut set in Concrete
 - (C) - Calculated
 - (M) - Measured
 - (PL) - Plotted
 - (R) - Record measurement
 - (PS) - Previous Survey By LS 1297 Dated 5/16/08

TRACT 1 DESCRIPTION OF RECORD

Lots Four (4) and Five (5), Block Thirty-eight (38), Moundridge, and the North 110 feet of Lots One (1), Two (2), Three (3), Four (4) and Five (5), Block Forty-five (45), Moundridge, together with all that tract of land heretofore known and platted as Krebbiel Street between the East line of Randall Avenue and the West line of the right-of-way of the Missouri Pacific Railroad, and the North 110 feet of the alley in the North Half (N/2) of Block 45, Moundridge.

TRACT 2 (LEASE DESCRIPTION OF RECORD)

Beginning at the intersection of the West Line of Christian Avenue with Carrier's southerly, right of way line; thence northwestwardly along said right of way line centerline of Carrier's track No. 2; thence southeastwardly parallel to said centerline 360 feet, more or less, to the point of beginning; containing 6515 square feet, more or less,

TRACT 2 DESCRIPTION

A portion of the Railroad Right of Way lying within Block 38 and Block 42, Moundridge, City of Moundridge, Kansas, more particularly described as follows:

Beginning at the intersection of the of the West line of Christian Avenue with the Southwesterly Railroad Right of Way line; thence North 43°36'20" West along said Right of Way 384.40 feet to the Northwestly face of a building formerly known as the Mill and Elevator building; thence North 43°26'00" East along said Northwestly face 3.23 feet to the Northeastly corner of said building; thence South 49°00'52" East along the Northeastly face of said building 265.38 feet to the Southeastly corner of said building; thence South 43°36'20" East parallel with said Right of Way 90.10 feet to said West line of Christian Avenue; thence South 00°35'32" East along said West line 41.39 feet the point of beginning, containing 7127.41 Square Feet.

SURVEYOR'S NOTES:

- Existing Lease Agreement with Missouri Pacific Railroad dated 9/11/1970.
- No remains of former Track No. 2, as described in said lease agreement, to determine a line 8.5' southwesterly and parallel to said Track No. 2. The existing building corner appears to be the boundary corner as it is the best available evidence of the true boundary line as shown on Missouri Pacific Railroad lease drawing.

SURVEYOR'S CERTIFICATE:

I hereby certify this plat to be a true, correct and complete representation of the property described hereon, as surveyed under my supervision, this 23rd day of May, 2014.

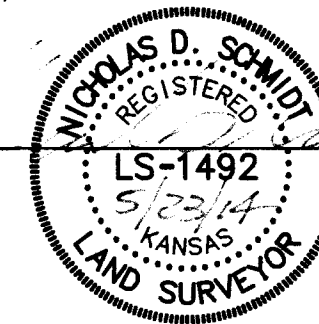

Prepared For: MORIDGE		Description: PORTIONS OF AND BLOCK 38 AND BLOCK 45, MOUNDRIE O.T.S., McPHERSON COUNTY, KANSAS	
Prepared By: CSS		Garber Surveying Service, P.A.	
HUTCHINSON (Main Office) 2908 North Plum St. 67502 Ph. 620-665-7032 Fax 620-663-7401 McPHERSON (Branch Office) 115 East Marlin 67460 Ph. 620-241-4441 Fax 620-241-4458 NEWTON (Branch Office) 511 North Poplar St. 67114 Ph. 316-283-5053 Fax 316-283-5073			
Drawn By: CSS	Scale: 1"=40'	Date of Field Work:	Job No:
Checked By: NDS	Date: 05/20/2014	Sheet 1 of 1 Sheet(s)	G2014-307