

A SURVEY IN BLOCK 9, ORIGINAL TOWN  
MARQUETTE, KANSAS

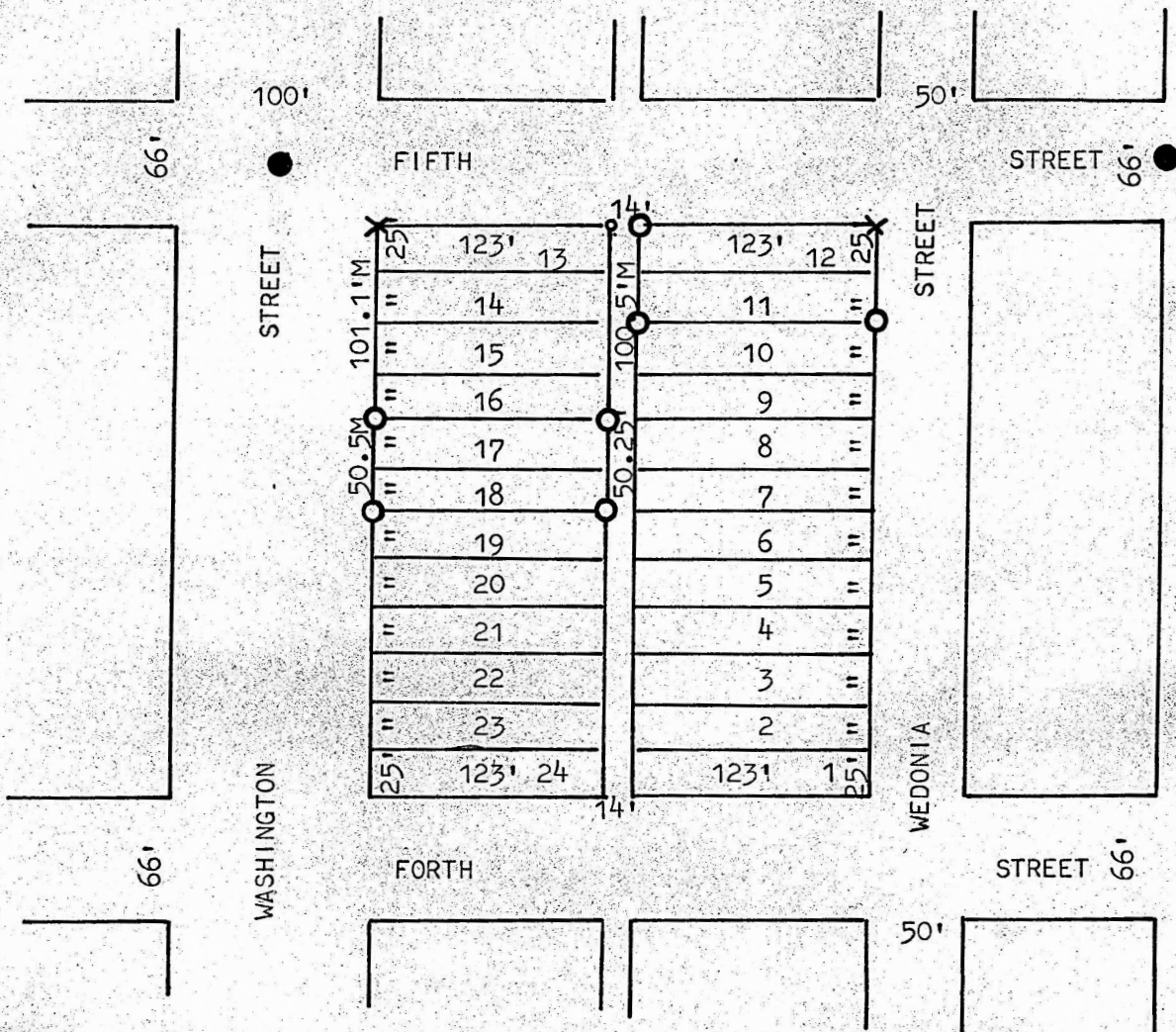

- PINS FOUND THIS SURVEY
- PINS SET THIS SURVEY
- X MARK IN CONCRETE

STATE OF KANSAS )  
COUNTY OF McPHERSON) <sup>SS</sup>

I, FRANCIS RANKIN, COUNTY ENGINEER OF McPHERSON COUNTY, KANSAS, DO HEREBY CERTIFY THAT UNDER MY SUPERVISION A SURVEY WAS MADE OF LOTS 11 THRU 18 INC. OF BLOCK 9, ORIGINAL TOWNSITE TO THE CITY OF MARQUETTE, KANSAS, AND THE ABOVE PLAT IS A TRUE EXHIBIT OF SAID SURVEY AS FAR AS IT IS KNOWN TO ME.

SURVEY CALLED FOR BY THE COVENANT CHURCH

SIGNED THIS 28 DAY OF JULY, 1969.

*Francis Rankin*  
FRANCIS RANKIN  
COUNTY ENGINEER  
McPHERSON, KANSAS

