

McPherson Engineering & Land Surveying
PO Box 662
McPherson, KS 67460
620-241-0950

Certificate of Survey

Legal Description: Lots 22, 23, & 24, Block 9, Original
Town of Marquette, McPherson County, Kansas

Client: Russell Malm & Flora Ott,
101 4th Street
Marquette, KS 67464

Surveyor's Certificate

I, the undersigned, a registered land surveyor in the State of Kansas, do hereby certify that the above plat and description were performed under my supervision and are in conformance with Kansas "Minimum Standards for Boundary Surveys". This Survey does not certify ownership or location of unplatted easements.

Date of Survey

8-23-04

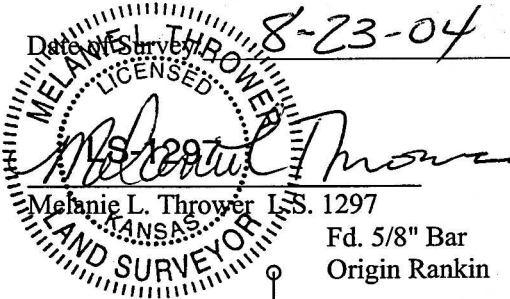

Melanie L. Thrower L.S. 1297

Fd. 5/8" Bar
Origin Rankin

Washington Street 100' R/W

216.85' M 216' P

75.425' Pro. M

75.425' Pro. M

66' R/W

89°45'14" M

123' Plat & M

4th Street 66' R/W

256.14' M 256' P

75' P & M
10' Alley

Found 3/8" Bar
in Conc.

Found 1" Pipe
in Conc.

Scale 1"=50'

Legend

M Measured Distance

P Plat

C Calculated

Basis of Bearing assumed.

Closure error 0.00

