

A SURVEY OF LOTS 15 TO 19 INC.

BLOCK 7 ORIGINAL TOWN  
MARQUETTE, KANSAS

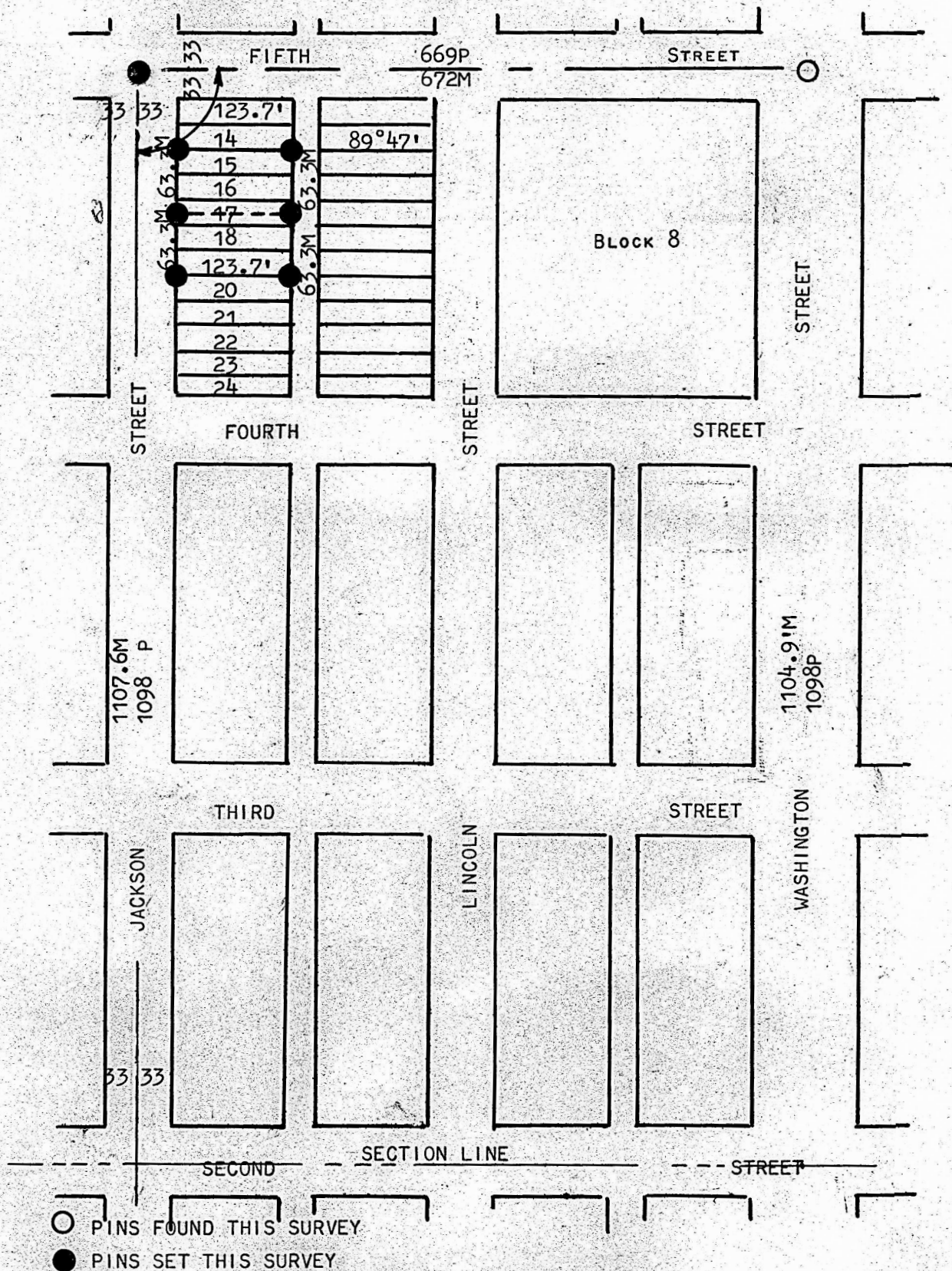

STATE OF KANSAS )  
COUNTY OF MCPHERSON) SS

I, FRANCIS RANKIN, PROFESSIONAL ENGINEER OF THE STATE OF KANSAS DO HEREBY CERTIFY THAT UNDER MY SUPERVISION A SURVEY WAS MADE ON THE 29, DAY OF OCTOBER, 1965, OF LOTS 15-16- AND THE NORTH HALF OF LOT 17; AND OF LOTS 18-19 AND THE SOUTH HALF OF LOT 17, BLOCK 7, ORIGINAL TOWN-SITE TO THE CITY OF MARQUETTE, KANSAS, AND THAT THE ACCOMPANYING PLAT IS A TRUE EXHIBIT OF SAID SURVEY AS FAR AS IT IS KNOWN TO ME

SURVEY CALLED FOR BY CLARENCE ANDERSON REAL EST.

SIGNED THIS 2 DAY OF NOVEMBER, 1965

FRANCIS RANKIN  
PROFESSIONAL ENGINEER  
MCPHERSON, KANSAS

