

A SURVEY OF THE EAST HALF OF LOT 7, AND THE  
EAST HALF OF THE SOUTH HALF LOT 8, BLOCK 15  
ORIGINAL TOWN SITE, INMAN, KANSAS

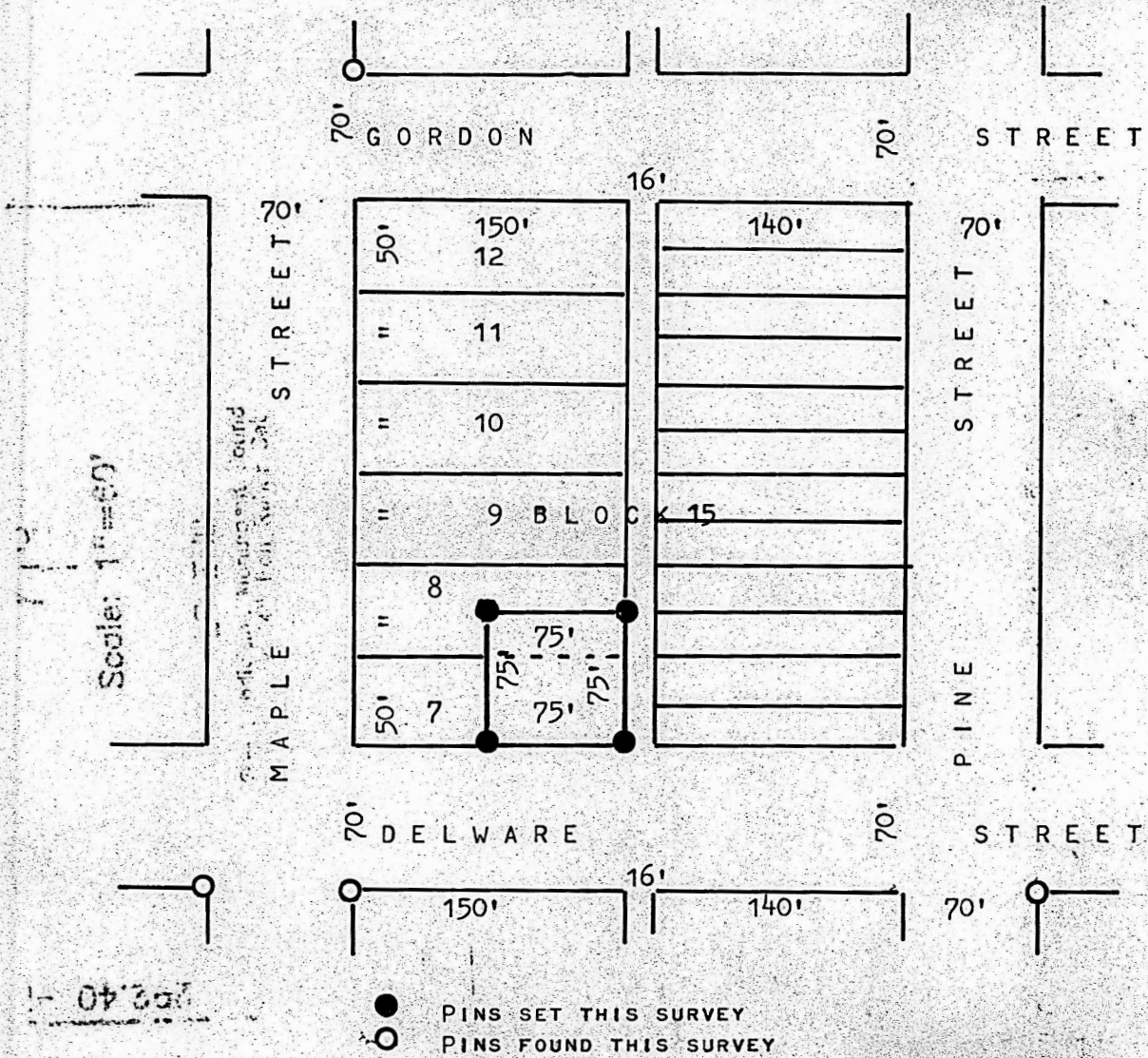

STATE OF KANSAS )  
COUNTY OF MCPHERSON ) SS

I, MELVIN FERGUSON, PROFESSIONAL ENGINEER OF THE STATE OF KANSAS DO HEREBY  
CERTIFY THAT UNDER MY SUPERVISION A SURVEY WAS MADE OF THE EAST HALF OF LOT 7,  
AND THE EAST HALF OF THE SOUTH HALF OF LOT 8, BLOCK 15, ORIGINAL TOWN SITE,  
TO THE CITY OF INMAN, KANSAS, AND THAT THE ABOVE PLAT IS A TRUE EXHIBIT OF  
SAID SURVEY AS FAR AS IT IS KNOWN TO ME.  
SURVEY CALLED FOR BY OSCAR BRASSEN

SIGNED THIS 26<sup>th</sup> DAY OF MAY, 1983

Melvin Ferguson  
MELVIN FERGUSON  
PROFESSIONAL ENGINEER  
MCPHERSON, KANSAS

