

SURVEY LOT 5 AND 6  
BLOCK 14 FIRST ADDITION  
CITY OF INMAN, KANSAS

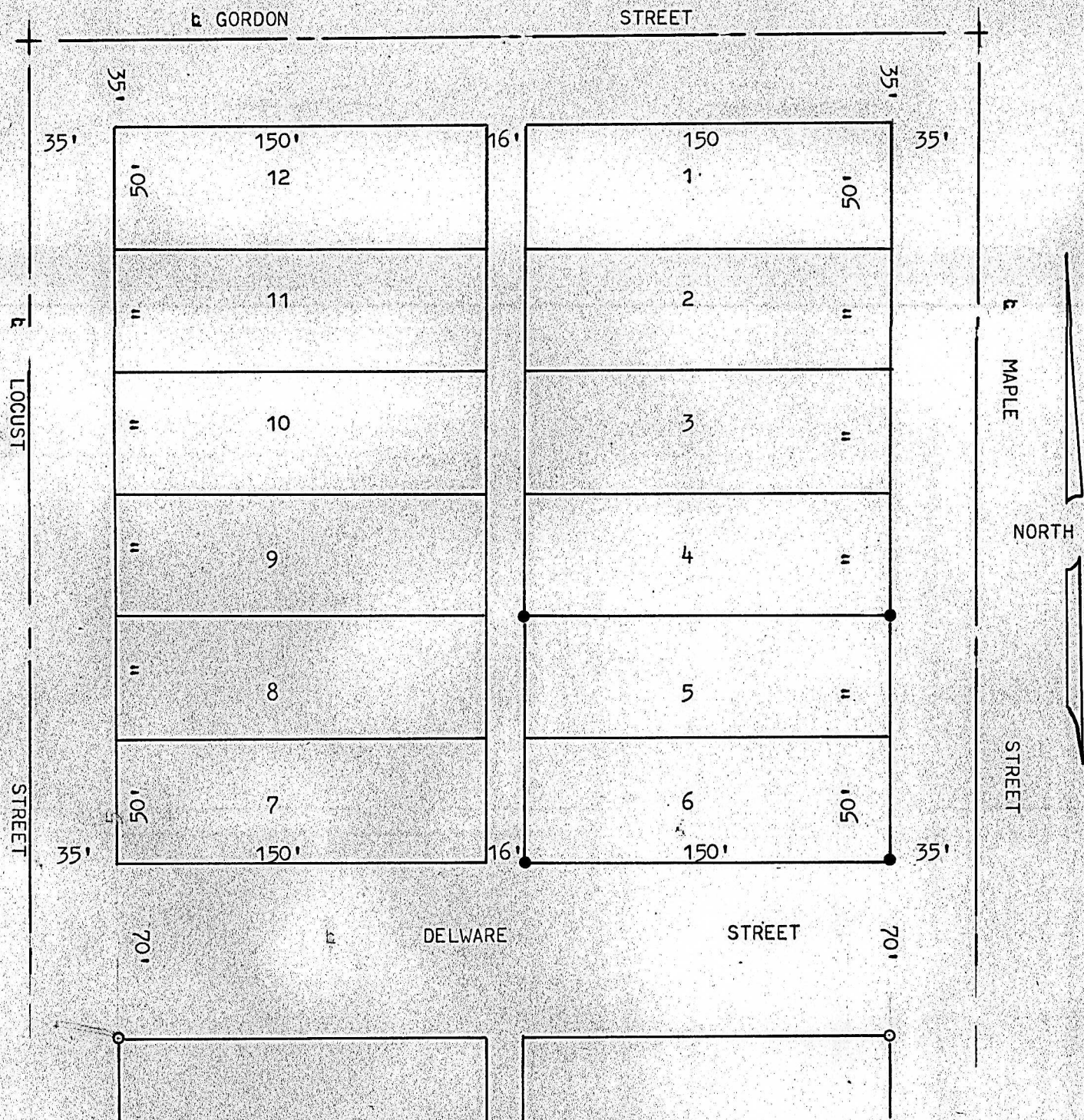

- PINS FOUND THIS SURVEY
- PINS SET THIS SURVEY

STATE OF KANSAS )  
COUNTY OF McPHERSON ) SS

I FRANCIS RANKIN, COUNTY ENGINEER OF McPHERSON KANSAS DO HEREBY CERTIFY THAT UNDER MY SUPERVISION A SURVEY WAS MADE OF LOTS 5 AND 6, BLOCK 14 FIRST ADDITION TO THE CITY OF INMAN, KANSAS AND THE ABOVE PLAT IS A TRUE EXHIBIT OF SAID SURVEY AS FAR AS IT IS KNOWN TO ME.

SIGNED THIS 30 DAY OF Dec 1965

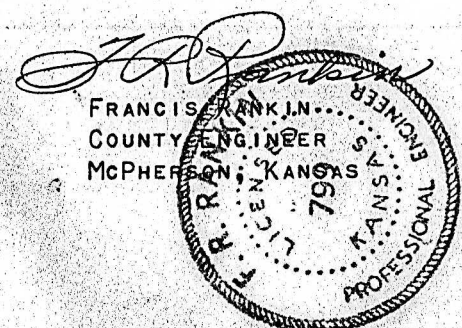

SURVEY CALLED FOR BY BILL KORNELSON