

Melanie L. Thrower, P.E., L.S.
P.O. Box 662
McPherson, KS 67460
241-0950 FAX 241-5086

- Property Pin
Accuracy plus minus one foot.
Scale 1" = 30'

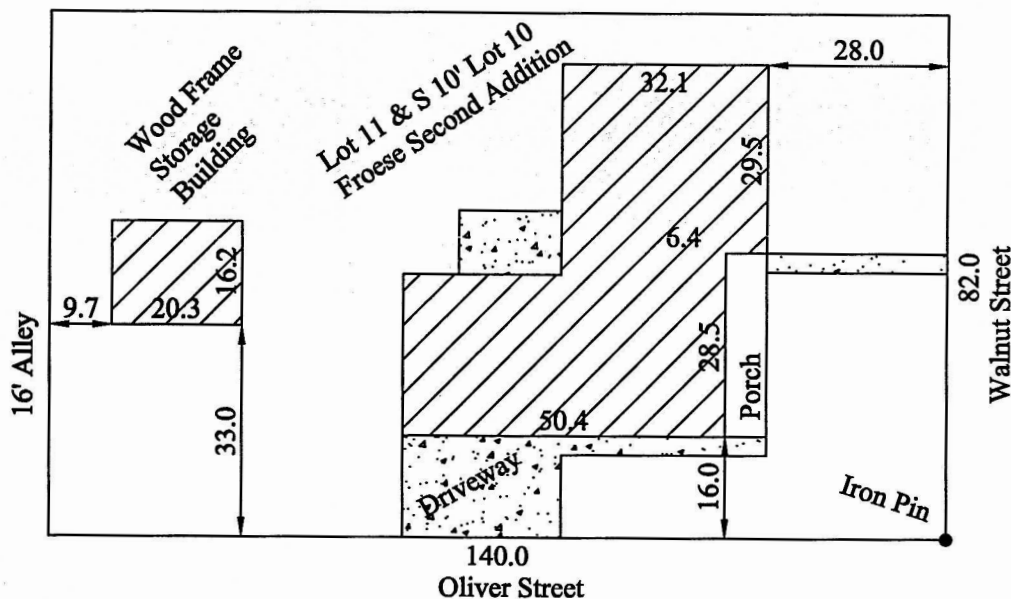

Melanie L. Thrower, Registered Land Surveyor in the State of Kansas, certifies that on December 19, 2000, the property addressed as 509 S. Walnut, Inman, Kansas with Legal Description:

Lot 11 and the South 10 feet of Lot 10, Froese Second Addition to the City of Inman, Kansas,

was properly inspected. This sketch is a true representation of the conditions that were found at the time of the inspection. This inspection is prepared for mortgagee title insurance only, and the document does not constitute a boundary survey and is subject to any inaccuracies that a subsequent boundary survey may disclose. No property corners were set, and the information shown on the sketch should not be used to establish any fence, structure or other improvements. The linear values of the property are based on record or deed information and have not been verified unless noted. This Land Surveyor does not extend a warranty to the present or future owners or occupants.

SIGNED THIS 19th DAY OF December, 2000.

MELANIE L. THROWER

