

A SURVEY OF LOTS 13, 14, 18, & S 1/2 19, BLOCK 6
ORIGINAL TOWN, CANTON, KANSAS

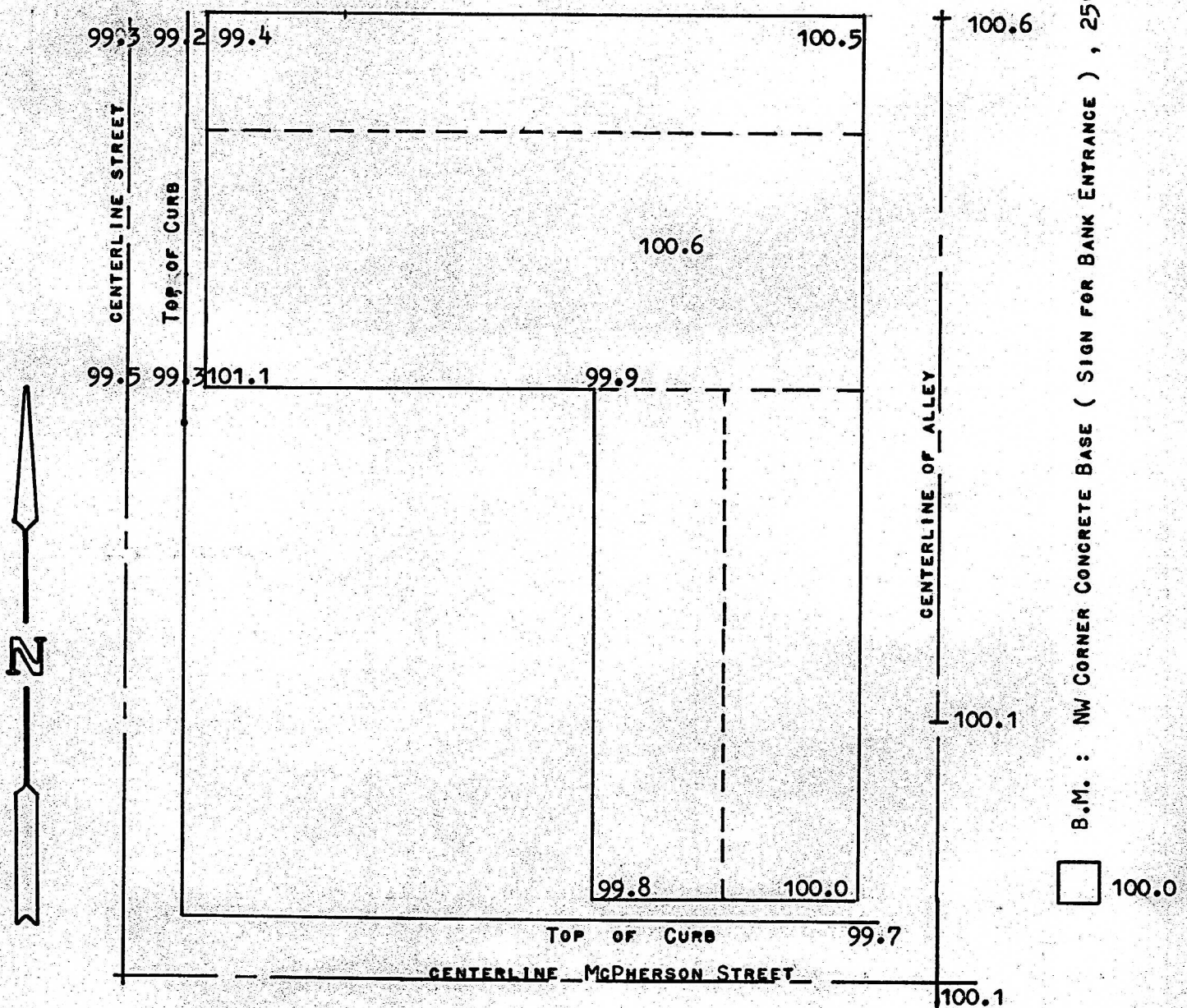

STATE OF KANSAS)
COUNTY OF MCPHERSON) SS

I, MELVIN FERGUSON, COUNTY ENGINEER OF MCPHERSON COUNTY, KANSAS, DO HEREBY CERTIFY THAT UNDER MY SUPERVISION A SURVEY WAS MADE TO ESTABLISH ELEVATIONS IN LOTS 13, 14, 18, AND THE SOUTH 1/2 OF 19, BLOCK 6, ORIGINAL TOWN, CANTON, KANSAS, AND THE ABOVE PLAT IS A TRUE EXHIBIT OF SAID SURVEY AS FAR AS IT IS KNOWN TO ME. SURVEY CALLED FOR BY CANTON REAL ESTATE.

SIGNED THIS 3rd DAY OF JULY, 1974.

Melvin Ferguson
MELVIN FERGUSON
COUNTY ENGINEER
MCPHERSON COUNTY, KANSAS
6772
KANSAS
PROFESSIONAL ENGINEER