

212 East Avenue "F", McPherson, Kansas.

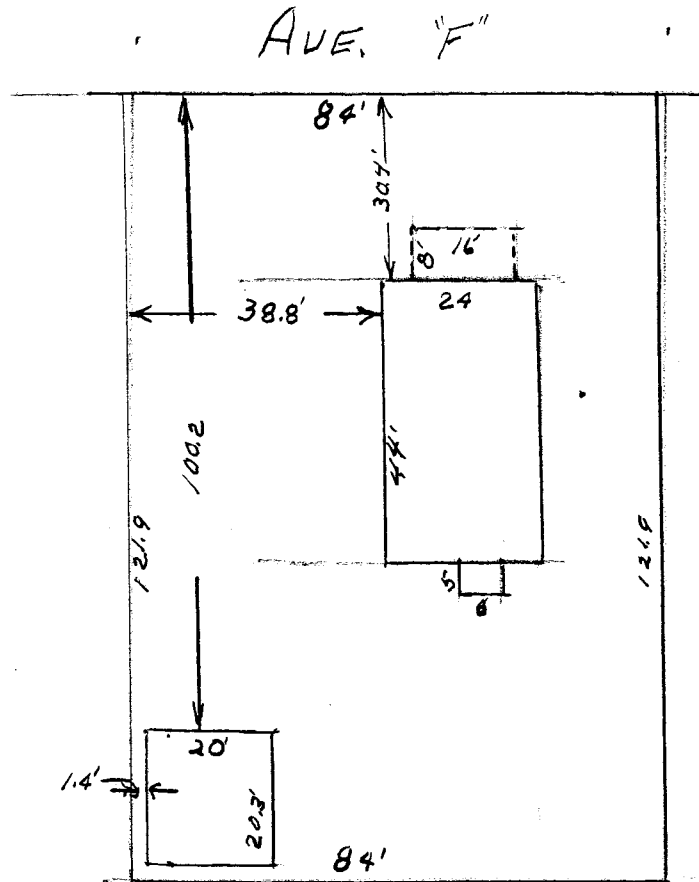

State of Kansas,)
County of McPherson,) ss.

I, G.D. Johnson. Licensed Civil Engineer in the State of Kansas, so hereby certify that I did on the 3rd. day of April, 1963 survey the following property.

Part of the NW $\frac{1}{4}$., Sec. 33., T.19.S., R.3.W., 6th. P. M.
Beginning 83.4 Feet east of the intersection of the center line of Ash Street and south line of Fourth Street (now Ave. "F" of C.K. & N. Addition to the City of McPherson, Kansas. thence south 121.9 feet, thence east 84 feet., thence north to south line of said Fourth Street a distance of 121.9 feet, thence west 84 feet to place of beginning.

I also certify that accompanying plat is true exhibit of said survey.

G. D. Johnson



MICROFILM