

214 East Avenue "F" , McPherson, Kansas,

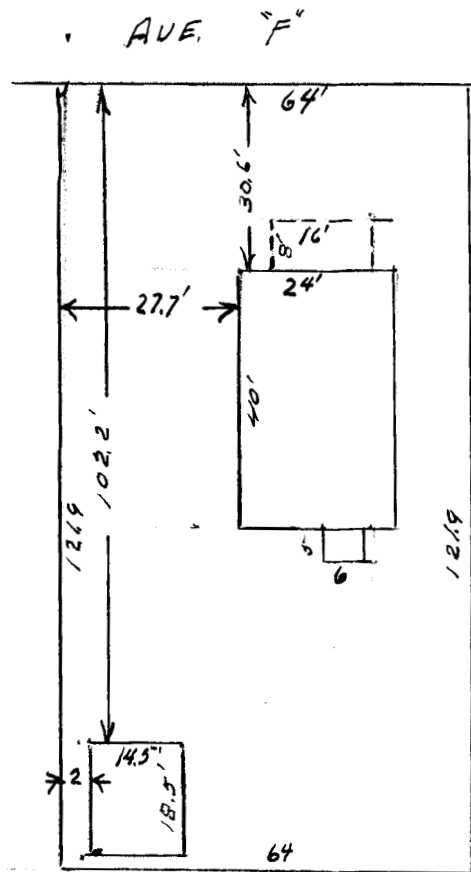

State of Kansas,)
County of McPherson,) ss.

I, G.D. Johnson, Licensed Civil Engineer in the State of Kansas, do hereby certify that I did on the 3rd. day of April, 1963 survey the following described property:

Part of the NW $\frac{1}{4}$., Sec. 33., T. 19. S., R. 3. S., 6th. P. M. beginning 167.4 feet east of the intersection of the center line of Ash Street and south line of Fourth Street (now Ave. "F" of C, K, & N. Addition to the City of McPherson, Kansas. thence south 121.9 feet, thence east 64 feet, thence north 121.9 feet to south line of said Fourth Street, thence west 64 feet to place of beginning.

I, also certify that accompanying plat is true exhibit of said survey.

G.D. Johnson