

Saved 7/30/2012 9:01:48 AM by KLOUTZEN
Plot Date & Time Monday, July 30, 2012 9:07:47 AM Dwg Path U:\DD\GSSFILES\2012\20120441 C3d\dwg\20120441 Auto S Ground

CHEYENNE ROAD

NE Cor. NE 1/4
Sec. 9, T21S, R5W
Fd. 1/2" Rebar LS 1297 (PS2)
Origin: LS 1297

Fd. 1/2" Rebar
0.45 S and 0.63 E
of Calculated Location
Origin: LS 586

Fd. 1/2" Rebar LS 1297 Cap
0.38 S and 0.73 East
of Calculated Location

N 89°32'27" E 525.00 (R)(PS1)(C)

90°05'00" (PS1)(C)

1137.50 (C)

S 00°32'33" E 2855.85 (PS1) 2856.31 (PS2) 2856.39 (M)

N 89°27'27" E 383.17 (C)

5.471 Acres

350.17 (M)

33.00 (C)

320.00 (R)(C)

50.00 (R)(C)

Fd. 1/2" Rebar
0.50 N and 1.07 E
of Calculated Location
(Unknown Origin)

Fd. 1/2" Rebar
0.80 N and 24.44 W
of Calculated Location
(Unknown Origin)

Existing Parcel
(Bk. 627, Pg. 706)
(3.00 Acres)

Existing Parcel
(Bk. 627, Pg. 707)
(0.47 Acres)

Fd. 1/2" Rebar
0.43 N and 0.16 E
of Calculated Location
(Unknown Origin)

50.00 (R)(C)

320.00 (R)(C)

S 89°27'27" W 383.17 (C)

P.O.B.

326.00 (C)

Fd. 1/2" Rebar (PS1)
0.95 N and 1.20 E
of Calculated Location
Origin: LS 586

South Line NE 1/4 as Per (PS1)
S 89°33'45" W 525.00 (R)(PS1)(C)

89°33'45" (PS1)

SE Cor. NE 1/4
Sec. 9, T21S, R5W
Fd. 5/8" Rebar (PS2)
Origin: LS 586

P.O.C.

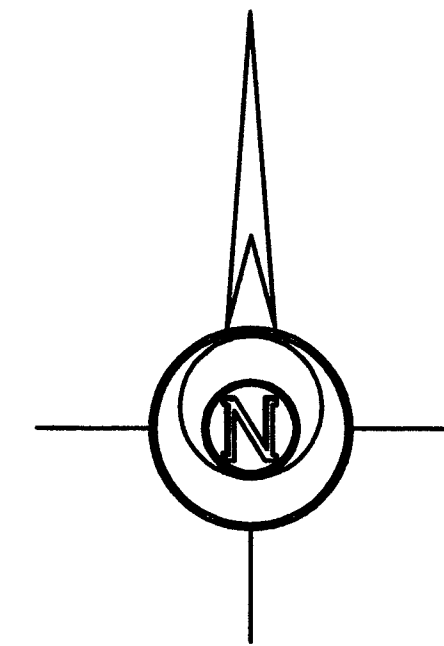

-100 0 100 200 300

BASIS OF BEARING = KANSAS STATE PLANE GRID

LEGEND

- △ - Sectional Monument Found
- - Survey Monument Found
- - 5/8" x 24" Iron Rebar Set w/G.S.S. Cap
- (C) - Calculated
- (M) - Measured
- (PS1) - Previous Survey by LS 586 Dated 8/12/1976
- (PS2) - Previous Survey by LS 1297 Dated 8/17/2011
- (R) - Record Measurement
- P.O.B. - Point of Beginning
- P.O.C. - Point of Commencement

DESCRIPTION:

A portion of the Northeast Quarter of Section 9, Township 21 South, Range 5 West of the 6th Principal Meridian, McPherson County, Kansas more particularly described as follows:

Commencing at the Southeast Corner of the Northeast Quarter of Section 9, Township 21 South, Range 5 West of the 6th Principal Meridian; thence with a Kansas State Plane Grid bearing North 00°32'33" West along the East line of said Northeast Quarter 326.00 feet for the point of beginning; thence South 89°27'27" West perpendicular to the East line of said Northeast Quarter 383.17 feet; thence North 00°32'33" West parallel with the East line of said Northeast Quarter 622.00 feet; thence North 89°27'27" East perpendicular to the East line of said Northeast Quarter 383.17 feet to said East line; thence South 00°32'33" East along said East line 622.00 feet to the point of beginning containing **5.471 Acres**, subject to a road right-of-way easement across the East 33.00 feet thereof and any other easements of record.

SURVEYOR'S CERTIFICATE:

I hereby certify this plat to be a true, correct and complete representation of the property described hereon, as surveyed under my supervision, this 30th day of July, 2012.

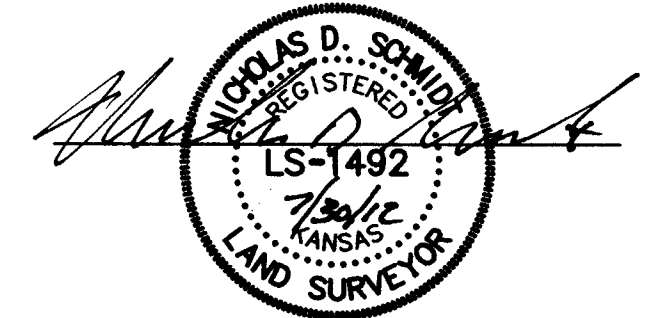

Prepared For: FIRST BANK KANSAS		Description: A PORTION OF THE NE 1/4 OF SEC. 9, T21S, R5W MCPHERSON COUNTY, KANSAS	
Prepared By: GSS		Garber Surveying Service, P.A. 2908 North Plum St. Hutchinson, Kansas 67502 Phone (620) 665-7032 • FAX (620) 663-7401 115 East Marlin Suite 102 McPherson, Kansas 67460 Phone (620) 241-4441 • FAX (620) 241-4458	
Drawn By: KLL	Scale: 1"=100'	Date of Field Work: July 24, 2012	Job No:
Checked By: NDS	Date: 07/30/2012	Sheet 1 of 1 Sheet(s)	G2012-441