

- LEGEND**
- △ - Sectional Monument Found
 - - Fd. 5/8" Rebar w/GSS CLS 52 Cap unless otherwise noted
 - - 5/8" x 24" Iron Rebar Set w/GSS CLS 52 Cap
 - × - Calculated Location
 - (C) - Calculated
 - (M) - Measured
 - (R) - Recorded
 - (PS) - Previous Survey LS #584 (No Date)
 - (PS1) - Previous Survey LS #584 2/27/2003
 - (PS2) - Previous Survey GSS Project #62020-126
 - (PLANS) - Union Pacific Railroad Plans
 - P.O.B. - Point of Beginning
 - P.O.C. - Point of Commencement

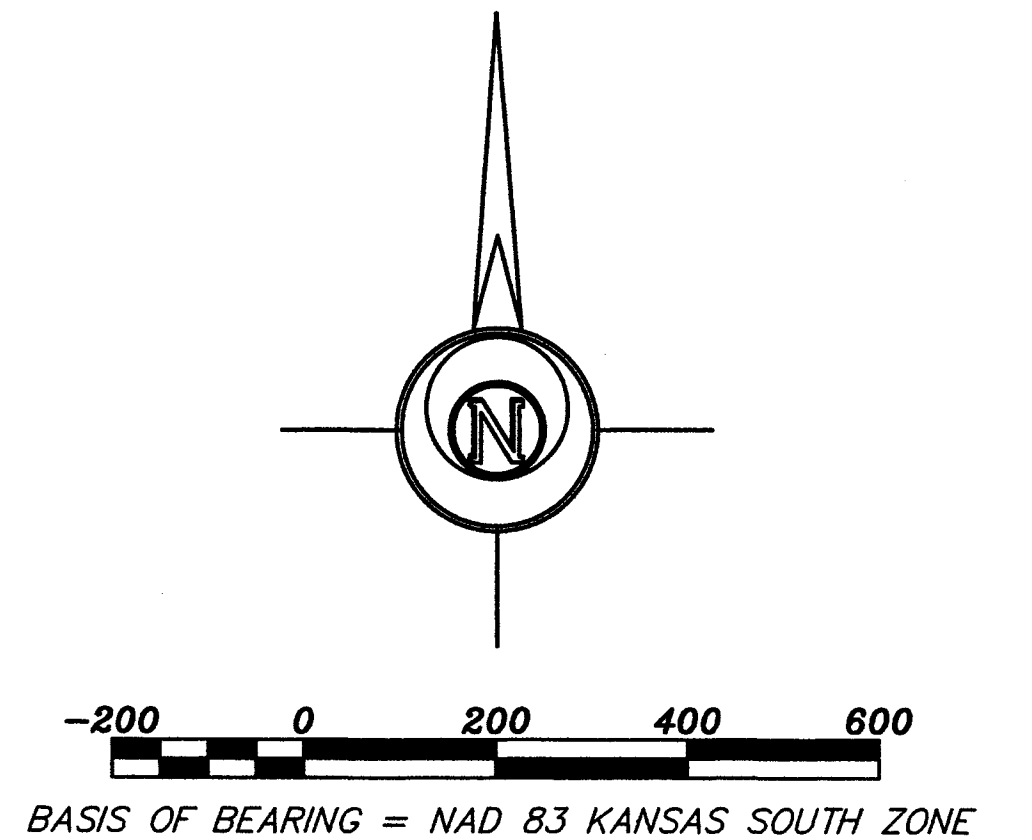

DESCRIPTION:

PARCEL 1

A portion of the Southeast Quarter of Section 8, Township 18 South, Range 3 West of the 6th Principal Meridian, McPherson County, Kansas described as follows:

Commencing at the Southwest corner of said Southeast Quarter; thence on a NAD 83 Kansas South Zone bearing of North 88°45'40" East on the South line of said Southeast Quarter a distance of 360.24 feet to the point of beginning; thence along the former East Right of Way line of the Union Pacific Railroad following the arc of a curve to the left having a radius of 3952.83 feet a distance of 733.35 feet (chord bears North 22°25'36" West a distance of 732.30 feet); thence North 27°40'34" West continuing along said former East Right of Way line a distance of 190.13 feet to the West line of said Southeast Quarter; thence North 00°30'21" West on said West line a distance of 1246.89 feet; thence South 67°56'17" East a distance of 93.60 feet; thence South 02°05'22" East a distance of 376.62 feet; thence South 78°25'46" East a distance of 135.48 feet; thence South 44°50'31" East a distance of 185.77 feet to the West line of a parcel described in Book 220, Page 119 at the McPherson County Register of Deeds Office; thence South 00°30'01" East on the West line of said parcel a distance of 211.00 feet to the Southwest corner of said parcel; thence North 88°37'09" East on the South line of said parcel a distance of 966.58 feet to the Southeast corner of said parcel, also being the Southeast corner of the Northwest Quarter of said Southeast Quarter; thence North 88°37'09" East a distance of 186.62 feet; thence South 00°31'36" East a distance of 656.54 feet to the North line of a second parcel described in Book 261, Page 496 at the McPherson County Register of Deeds Office; thence South 88°39'21" West on said North line a distance of 186.62 feet to the Northwest corner of said second parcel; thence South 00°31'36" East on the West line of said second parcel a distance of 656.54 feet to the South line of said Southeast Quarter; thence South 88°45'40" West on said South line a distance of 729.19 feet to the Southeast corner of a third parcel described in Book 221, Page 336 at the McPherson County Register of Deeds Office; thence North 01°14'20" West on the East line of said third parcel a distance of 115.00 feet to the Northeast corner of said third parcel; thence South 88°45'40" West on the North line of said third parcel a distance of 85.00 feet to the Northwest corner of said third parcel; thence South 01°14'20" East on the West line of said third parcel a distance of 115.00 feet to the South line of said Southwest Quarter of the Southeast Quarter; thence South 88°45'40" West on said South line a distance of 151.76 feet to the point of beginning.

Containing 42.238 Acres and subject to a road right of way easement across the South 33.00 feet thereof and any other easements or restrictions of record.

PARCEL 2

A portion of the Southeast Quarter of Section 8, Township 18 South, Range 3 West of the 6th Principal Meridian, McPherson County, Kansas described as follows:

Beginning at the Northeast corner of said Southeast Quarter; thence on a NAD 83 Kansas South Zone bearing of South 00°31'17" East on the East line of said Southeast Quarter a distance of 472.83 feet; thence South 88°23'36" West parallel with the North line of said Southeast Quarter a distance of 1325.89 feet; thence South 00°28'58" East a distance of 192.48 feet to the Northeast corner of a parcel described in Book 220, Page 119 at the McPherson County Register of Deeds Office; thence South 88°37'23" West on the North line of said parcel a distance of 966.78 feet to the Northwest corner of said parcel; thence South 00°30'01" East on the West line of said parcel a distance of 438.88 feet; thence North 44°50'31" West a distance of 185.77 feet; thence North 78°25'46" West a distance of 135.48 feet; thence North 02°05'22" West a distance of 376.62 feet; thence North 67°56'17" West a distance of 93.60 feet to the West line of said Southeast Quarter; thence North 00°30'21" West on said West line a distance of 519.80 feet to the Northwest corner of said Southeast Quarter; thence North 88°23'36" East on the North line of said Southeast Quarter a distance of 2651.95 feet to the point of beginning.

Containing 36.325 Acres and subject to a road right of way easement along the East line thereof, and any other easements or restrictions of record.

PARCEL 3

A portion of the Southeast Quarter of Section 8, Township 18 South, Range 3 West of the 6th Principal Meridian, McPherson County, Kansas described as follows:

Commencing at the Northeast corner of said Southeast Quarter; thence on a NAD 83 Kansas South Zone bearing of South 00°31'17" East on the East line of said Southeast Quarter a distance of 472.83 feet to the point of beginning; thence continuing South 00°31'17" East on said East line a distance of 1505.00 feet to the Northeast corner of a parcel described in Book 261, Page 496 at the McPherson County Register of Deeds Office; thence South 88°39'21" West on the North line of said parcel a distance of 1139.68 feet; thence North 00°31'36" West a distance of 656.76 feet; thence South 88°37'09" West a distance of 186.62 feet to the Southeast corner of a second parcel described in Book 220, Page 119 at the McPherson County Register of Deeds Office, also being the Southeast corner of the Northwest quarter of said Southeast Quarter; thence North 00°28'58" West on the East line of said second parcel a distance of 649.82 feet to the Northeast corner of said second parcel; thence continuing North 00°28'58" West a distance of 192.48 feet; thence North 88°23'36" East parallel with the North line of said Southeast Quarter a distance of 1325.89 feet to the point of beginning.

Containing 42.909 Acres and subject to a road right of way easement along the East line thereof, and any other easements or restrictions of record.

Proposed Ingress/Egress Easement for Parcel 2

A portion of the Southeast Quarter of Section 8, Township 18 South, Range 3 West of the 6th Principal Meridian, McPherson County, Kansas described as follows:

Commencing at the Northeast corner of said Southeast Quarter; thence on a NAD 83 Kansas South Zone bearing of South 00°31'17" East on the East line of said Southeast Quarter a distance of 472.83 feet; thence continuing South 00°31'17" East on the North line of said Southeast Quarter a distance of 1240.53 feet to the point of beginning; thence South 00°31'36" East a distance of 842.92 feet; thence South 88°37'09" West a distance of 20.00 feet; thence North 00°31'36" West a distance of 842.54 feet; thence North 88°23'36" East a distance of 20.00 feet to the point of beginning.

SURVEYOR'S CERTIFICATE:
I hereby certify this plat to be a true, correct and complete representation of the property described hereon, as surveyed under my supervision, this 25th day of May, 2021

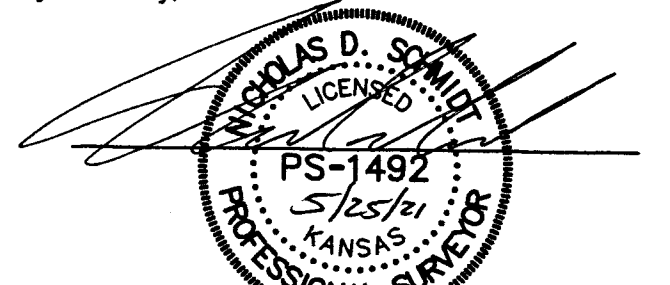

Prepared For:	MEL BERGEN		
Prepared By:	Garber Surveying Service, P.A.		
HUTCHINSON (Main Office)		2008 North Plum St. 67502	Ph. 620-665-7032 Fax 620-663-7401
McPHERSON (Branch Office)		115 East Marlin 67460	Ph. 620-241-4441 Fax 620-241-4458
NEWTON (Branch Office)		511 North Poplar St. 67114	Ph. 316-283-5053 Fax 316-283-5073
Drawn By:	KDZ	Scale: 1"=200'	Date of Field Work: August 31, 2020
Checked By:	NDS	Date: 05/25/2021	Sheet 1 of 1 Sheet(s)
Revised 05/25/2021			Job No: G2020-567
Revised 11/16/2020			
Revised 09/22/2020			