

24TH AVENUE

N 00°19'46" W 2647.93 (M)

828.97 (C)

SW Cor. NW 1/4  
Sec. 7, T21S, R1W  
Fd. 8" x 5" Sandstone  
Origin: KSHS References  
By LS 1202, 8/7/2014  
Note: References by LS 1202 Call for a 1.5"  
Iron Pipe, However a Sandstone was  
Found at Same Depth and 1/2" Iron Pipe  
Was on East Side of Stone.

NW Cor. NW 1/4  
Sec. 7, T21S, R1W  
Fd. 5/8" Rebar  
Origin: KSHS References by  
LS 1202, 3/14/2002

EXISTING PARCEL  
(Bk. 621, Pg. 126)

N 89°31'31" E  
900.00 (C)(R)

900.00 (M)(R)

867.00 (M)

33.00 (C)

495.00 (C)(R)

33' R/W Line

N 89°31'31" E 2705.75 (M)

N 89°31'31" E 1805.75 (M)

S1/2 NW1/4

S 89°30'36" W 2705.86 (M)

SW 1/4

SE Cor. NW 1/4  
Sec. 7, T21S, R1W  
Reset at the Intersection of the 1/4 Corners  
Which Matches Well with (PS) Distances.

SE Cor. SW 1/4  
Sec. 7, T21S, R1W  
Fd. 5/8" Rebar w/GSS Cap  
Origin: GSS Project #G2022-374

33.00 (M)

S 00°20'03" E 2642.81 (M)

S 00°20'03" E 1923.25 (M)

2642.00 (PS)

S 00°20'07" E 2846.50 (M)

S 00°20'03" E 1323.25 (M)

NE Cor. NW 1/4  
Sec. 7, T21S, R1W  
Fd. 4" x 10" x 12" Sandstone  
Origin: KSHS References  
By LS 1202, 9/2/2023

CHEYENNE ROAD  
N 89°32'26" E 2705.64 (M)

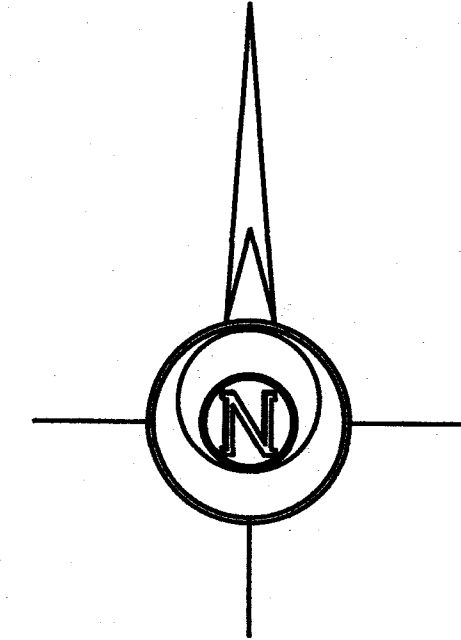

-300 0 300 600 900

BASIS OF BEARING = NAD 83 KANSAS SOUTH ZONE

#### LEGEND

- △ - Sectional Monument Found
- ▲ - Section Monument Set (5/8" x 24" Iron Rebar w/G.S.S. Cap)
- - 5/8" x 24" Iron Rebar Set w/G.S.S. Cap
- (C) - Calculated
- (M) - Measured
- (R) - Record measurement
- (PS) - Previous Survey F.R. Rankin 5/7/1968

#### DESCRIPTION:

A Survey of the East Line Southwest Quarter, East Line South Half Northwest Quarter and North Line South Half Northwest Quarter Except Existing Parcel, Section 7, Township 21 South, Range 1 West of the 6th Principal Meridian, McPherson County, Kansas.

#### SURVEYOR'S NOTES:

- Survey was made per client request and no title work has been provided to the surveyor; therefore, the number and extent of the easements and/or rights-of-way of record affecting said property has not been verified.
- All measurements are in US Survey Feet.
- Origin of found monuments uncertain unless noted.

#### SURVEYOR'S CERTIFICATE:

I hereby certify this plat to be a true, correct and complete representation of the property described hereon, as surveyed under my supervision, this 24th day of July, 2024

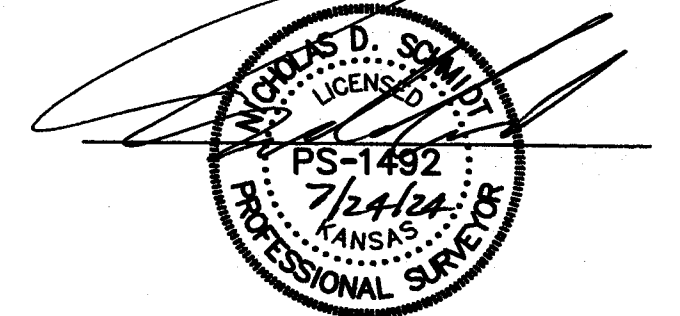

Prepared For: <b>JOHN YOST</b>		Description: <b>A PORTION OF THE W 1/2 SECTION 7, T21S, R1W MCPHERSON COUNTY, KANSAS</b>	
Prepared By: <b>GSS HUTCHINSON</b> 2908 North Plum St. 67502 Ph. 620-665-7032 (Main Office)		<b>Garber Surveying Service, P.A.</b> BRANCH OFFICES: MCPHERSON Ph. 620-241-4441 SALINA Ph. 785-404-6302 MANHATTAN Ph. 785-320-4810 NEWTON Ph. 316-283-5053 WICHITA Ph. 316-260-9933	
Drawn By: KJC	Scale: 1"= 300'	Date of Field Work: July 7, 2024	Job No:
Checked By: NDS	Date: 07/24/2024	Sheet 1 of 1 Sheet(s)	<b>G2024-457</b>