

- LEGEND**
- △ - Sectional Monument Found
 - - 5/8" x 24" Iron Rebar Set w/G.S.S. Cap
 - x- - Fence
 - (C) - Calculated
 - (M) - Measured
 - P.O.B. - Point of Beginning
 - P.O.C. - Point of Commencement

DESCRIPTION:
A portion of the Southeast Quarter of Section 6, Township 17 South, Range 1 West of the 6th Principal Meridian, McPherson County, Kansas, described as follows by Nicholas D. Schmidt, PS #1492, this 10th day of June, 2024:

Commencing at the Southeast corner of said Southeast Quarter; thence on a NAD 83 Kansas South Zone bearing of North 00°11'05" West on the East line of said Southeast Quarter a distance of 680.82 feet to the point of beginning; thence South 87°58'11" West a distance of 345.34 feet; thence South 32°16'53" West a distance of 26.33 feet; thence South 88°04'36" West a distance of 333.54 feet; thence South 44°31'02" West a distance of 217.99 feet; thence North 79°18'05" West a distance of 471.11 feet; thence North 00°11'40" West a distance of 367.78 feet; thence North 89°31'01" East a distance of 883.29 feet; thence North 12°48'35" East a distance of 177.97 feet; thence North 88°27'09" East a distance of 66.91 feet; thence South 81°54'43" East a distance of 321.88 feet to said East line; thence South 00°11'05" East on said East line a distance of 391.63 feet to the point of beginning.

The above described tract contains **11.72 Acres** and is subject to a road right of way easement along the East line thereof, and any other easements or restrictions of record.

SURVEYOR'S CERTIFICATE:
I hereby certify this plat to be a true, correct and complete representation of the property described hereon, as surveyed under my supervision, this 10th day of June, 2024.

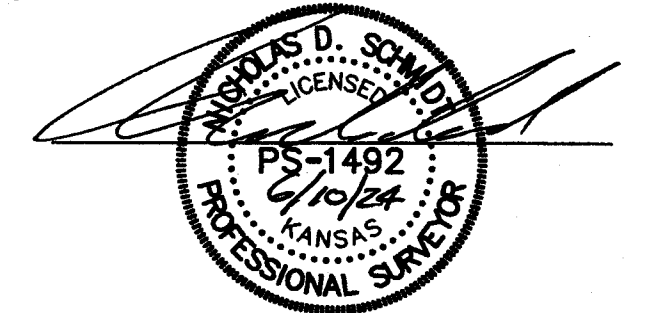

Prepared For: MIDWEST LAND GROUP		Description: A PORTION OF THE SE 1/4 SECTION 6, T17S, R1W MCPHERSON COUNTY, KANSAS	
Prepared By: GSS HUTCHINSON 2908 North Plum St. 67502 Ph. 620-665-7032 (Main Office)		Garber Surveying Service, P.A. BRANCH OFFICES: MCPHERSON Ph. 620-241-4441 SALINA Ph. 785-404-6302 MANHATTAN Ph. 785-320-4810 NEWTON Ph. 316-283-5053 WICHITA Ph. 316-260-9933	
Drawn By: KJC	Scale: 1"=100'	Date of Field Work: May 29, 2024	Job No:
Checked By: NDS	Date: 06/10/2024	Sheet 1 of 1 Sheet(s)	G2024-416