

DESCRIPTION:

Parcel 1

A portion of the West Half of the Southeast Quarter of Section 5, Township 18 South, Range 3 West of the 6th Principal Meridian, McPherson County, Kansas more particularly described as follows:

Beginning at the Southwest corner of the West Half of the Southeast Quarter of Section 5, Township 18 South, Range 3 West of the 6th Principal Meridian; thence North 00°02'23" West along the West line of said West Half 2646.56 feet to the Northwest corner of said West Half; thence North 88°09'22" East along the North line of said West Half 1312.28 feet to the Northeast corner of said West Half; thence South 00°20'28" East along the East line of said West Half 2640.07 feet to the Southeast corner of said West Half; thence South 87°53'36" West along the South line of said West Half 295.39 feet; thence North 02°06'24" West perpendicular to the said South line 311.00 feet; thence South 87°53'36" West parallel with said South line 484.00 feet; thence South 02°06'24" East perpendicular to said South line 311.00 feet to said South line; thence South 87°53'36" West along said South line 547.00 feet to the point of beginning, containing **76.575 Acres**, subject to road right of way easements across the South 33.00 feet and West 16.50 feet thereof and any other easements of record.

Parcel 2

A portion of the West Half of the Southeast Quarter of Section 5, Township 18 South, Range 3 West of the 6th Principal Meridian, McPherson County, Kansas more particularly described as follows:

Commencing at the Southwest corner of the West Half of the Southeast Quarter of Section 5, Township 18 South, Range 3 West of the 6th Principal Meridian; thence North 87°53'36" East along the South line of said West Half 547.00 feet to the point of beginning; thence North 02°06'24" West perpendicular to said South line 311.00 feet; thence North 87°53'36" East parallel with said South line 484.00 feet; thence South 02°06'24" East perpendicular to said South line 311.00 feet to said South line; thence South 87°53'36" West along said South line 484.00 feet to the point of beginning, containing **3.461 Acres**, subject to a road right of way easement across the South 33.00 feet thereof and any other easements of record.

LEGEND

- △ - Sectional Monument Found
- - Section Monument Set (5/8" x 24" Iron Rebar w/G.S.S. Cap)
- - Survey Monument Found
- - 5/8" x 24" Iron Rebar Set w/G.S.S. Cap
- (C) - Calculated
- (M) - Measured
- (PS1) - Previous Survey GSS Proj # G81-79
- (PS2) - Previous Survey GSS Proj # G83-144
- (PS3) - Previous Survey by LS 1202 for Greg Hoffman (Date Unknown)
- P.O.B. - Point of Beginning
- P.O.C. - Point of Commencement

SURVEYOR'S CERTIFICATE:

I hereby certify this plat to be a true, correct and complete representation of the property described hereon, as surveyed under my supervision, this 10th day of November, 2011.

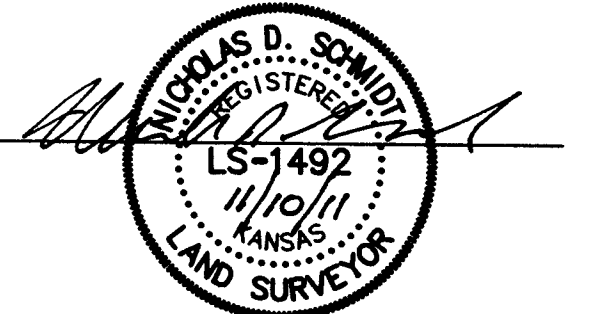

Prepared For: LINDSAY SCHWARTZ		Description: PORTIONS OF THE W 1/2 SE 1/4 SECTION 5 T18S, R3W	
Prepared By: GSS		Garber Surveying Service, P.A. 2908 North Plum St. Hutchinson, Kansas 67502 Phone (620) 665-7032 • FAX (620) 663-7401 511 North Poplar Street Newton, Kansas 67114 Phone (316) 283-5053 • FAX (316) 283-5073	
Drawn By: RAL	Scale: 1"=200'	Date of Field Work: November 1, 2011	Job No: G2011-611
Checked By: NDS	Date: 11/11/2011	Sheet 1 of 1 Sheet(s)	