

LEGEND

- △ - Sectional Monument Found
- ▲ - Section Monument Set
- - Survey Monument Found - Origin F.R. Rankin 5/18/1977
- - 5/8" x 24" Iron Rebar Set w/G.S.S. Cap
- x- Fence
- (C) - Calculated
- (M) - Measured
- (PS) - Previous Survey by F.R. by Rankin Dated 5/18/1977
- (PS1) - Previous Survey by Thrower LS 1297 Dated 12/17/1999
- (PS2) - Previous Survey by Heller LS 1202 Dated 11/16/2001

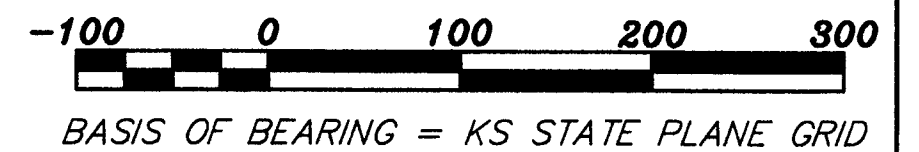

DESCRIPTION OF RECORD (Book 652, Page 5115):

The West Half of the South Half of the South Half of the Northwest Quarter of the Southwest Quarter of Section 4, Township 18 South, Range 3 West of the Sixth Principal Meridian, McPherson County, Kansas.

SURVEYOR'S NOTES:

- 1) Searched for the original monuments at the NE and SE corners of the West Half of the Southwest Quarter from the 1977 Rankin survey, but did not find. However, the monuments from said survey were located at the NE corner of the S 1/2, S 1/2, NW 1/4, SW 1/4 and the NE corner of the S 1/2, S 1/2, SW 1/4, SW 1/4, therefore, the positions of those original monuments were used to re-establish the East line of the West 1/2 of the SW 1/4 as per the 1977 Rankin survey. This line was then intersected with the North and South lines of the SW 1/4 to calculate and re-establish the NE and SE corners of said West Half. These 2 calculated and monumented locations are not located on the even split between their respective section corners as also indicated in the 1977 Rankin survey.
- 2) The 5/8" rebar set by Dan Garber LS 683 in 1981 is located approximately 14' West of the centerline of the highway while the 1977 Rankin survey shows the 1/4 corner location to be 15.8' East of the centerline the highway. Since no monument description is documented in the 1977 Rankin survey nor does a monument exist 15.8' East of existing centerline of highway and the 5/8" rebar set by Garber has been accepted and used for multiple surveys since 1981, the Garber monument was accepted and held for this survey.
- 3) The 1999 Thrower survey drawing appears to imply that the East line of the W 1/2, S 1/2, S 1/2, NW 1/4, SW 1/4 is located at the fence line approximately 80' to 90' East of the East line calculated and monumented in this survey, however, no monuments were set by Thrower. During a conversation with Thrower to clarify the intent of her survey on May 14th, 2012, she stated that she did not survey or determine the East line of this parcel but only showed dimensions to said fence line from the highway right of way because the client did not order a full boundary survey. She further stated that she is in agreement with the location of the East line as I have calculated and monumented on this survey.
- 4) The end of the fence line falls 0.13' North of the re-established South line of the S 1/2, S 1/2, NW 1/4, SW 1/4.

SURVEYOR'S CERTIFICATE:

I hereby certify this plat to be a true, correct and complete representation of the property described hereon, as surveyed under my supervision, this 22nd day of May, 2012.

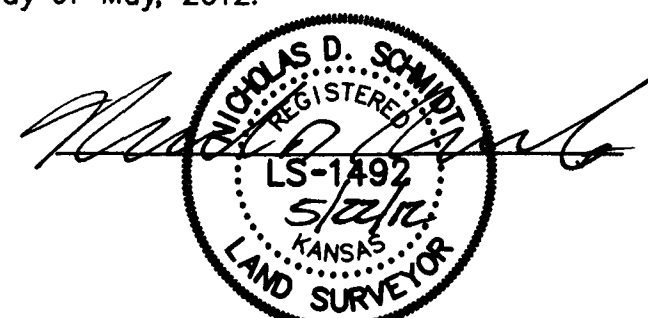

Prepared For: DANNY NEWHOUSE		Description: A PORTION OF THE NW 1/4 SW 1/4 OF SEC. 4, T18S, R3W MCPHERSON COUNTY, KANSAS	
Prepared By: GSS		Garber Surveying Service, P.A. 2908 North Plum St. Hutchinson, Kansas 67502 Phone (620) 665-7032 • FAX (620) 663-7401	
Drawn By: KLL		Scale: 1"=100'	Date of Field Work: May 10, 2012
Checked By: NDS		Date: 05/22/2012	Sheet 1 of 1 Sheet(s)
		Job No: G2012-270	