

- LEGEND**
- △ - Sectional Monument Found
  - ▲ - Section Monument Set (5/8" x 24" Iron Rebar w/G.S.S. Cap)
  - - 5/8" x 24" Iron Rebar Set w/G.S.S. Cap
  - - Survey Monument Found
  - (C) - Calculated
  - (M) - Measured
  - (PS) - Previous Survey LS 68 4-20-1988
  - (PS1) - Previous Survey LS 1202 11-19-2014
  - P.O.B. - Point of Beginning
  - P.O.C. - Point of Commencement

**DESCRIPTION:**  
**TRACT 1**

A portion of the Northeast Quarter of Section 36, Township 19 South, Range 3 West of the 6th Principal Meridian, McPherson County, Kansas, described as follows by Nicholas D. Schmidt, PS #1492, this 6th day of September, 2024:

Commencing at the Northwest corner of said Northeast Quarter; thence on a NAD 83 Kansas South Zone bearing of North 89°40'26" East on the North line of said Northeast Quarter a distance of 988.26 feet (987.97 Record) to the Northwest corner of a parcel described in Book 660, Page 8281 at the McPherson County Register of Deeds Office, being point of beginning; thence continuing North 89°40'26" East on said North line a distance of 678.82 feet; thence South 00°30'28" East a distance of 2413.16 feet to the South line of said parcel; thence North 65°27'08" West on said South line a distance of 122.52 feet; thence North 57°11'02" West on said South line a distance of 235.35 feet; thence North 54°20'45" West on said South line a distance of 339.22 feet; thence North 40°06'14" West on said South line a distance of 152.75 feet to the Southwest corner of said parcel; thence North 00°30'22" West on the West line of said parcel a distance of 1916.26 feet to the point of beginning.

The above described tract contains **34.28 Acres** and is subject to a road right of way easement along the North line thereof, and any other easements or restrictions of record.

**TRACT 2**

A portion of the Northeast Quarter of Section 36, Township 19 South, Range 3 West of the 6th Principal Meridian, McPherson County, Kansas, described as follows by Nicholas D. Schmidt, PS #1492, this 6th day of September, 2024:

Commencing at the Northwest corner of said Northeast Quarter; thence on a NAD 83 Kansas South Zone bearing of North 89°40'26" East on the North line of said Northeast Quarter a distance of 988.26 feet to the Northwest corner of a parcel described in Book 660, Page 8281 at the McPherson County Register of Deeds Office, thence continuing North 89°40'26" East on said North line a distance of 678.82 feet to the point of beginning; thence continuing North 89°40'26" East on said North line a distance of 398.69 feet to the Northeast corner of said parcel; thence South 00°46'10" West on the East line of said parcel a distance of 870.23 feet; thence South 50°55'21" East on said East line a distance of 141.37 feet; thence South 84°39'57" East on said East line a distance of 224.64 feet; thence South 00°42'51" East on said East line a distance of 1571.32 feet to the Southeast corner of said parcel being on the South line of said Southeast Quarter; thence South 88°48'32" West on said South line and the South line of said parcel a distance of 402.56 feet; thence North 65°27'08" West on the South line of said parcel a distance of 347.54 feet; thence North 00°30'28" West a distance of 2413.16 feet to the point of beginning.

The above described tract contains **34.29 Acres** and is subject to a road right of way easement along the North line thereof, and any other easements or restrictions of record.

**SURVEYOR'S CERTIFICATE:**

I hereby certify this plat to be a true, correct and complete representation of the property described hereon, as surveyed under my supervision, this 6th day of September, 2024.

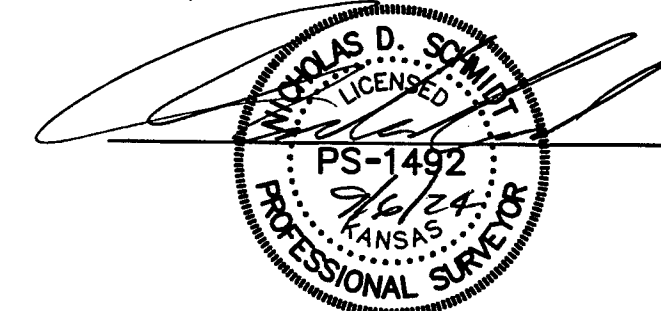

Prepared For:	Landon Shaw			Description:	A PORTION OF THE NE 1/4 SECTION 36, T19S, R3W McPHERSON COUNTY, KANSAS		
Prepared By:	Garber Surveying Service, P.A.						
GSS HUTCHINSON 2908 North Plum St. 67502 Ph. 620-665-7032 (Main Office)		BRANCH OFFICES:		MANHATTAN Ph. 785-320-4810 NEWTON Ph. 316-283-5853 SALINA Ph. 785-404-6302 WICHITA Ph. 316-260-9933			
Drawn By:	KLL	Scale:	1"=200'	Date of Field Work:	08/29/2024		
Checked By:	NDS	Date:	09/06/2024	Sheet	1 of 1 Sheet(s)		
				Job No:	G2024-687		