

#### DESCRIPTION:

##### PARCEL 1

A portion of the Southeast of the Northeast Quarter of Section 36, Township 19 South, Range 2 West of the 6th Principal Meridian, McPherson County, Kansas described as follows:

Commencing at the Northeast corner of said Southeast Quarter of the Northeast Quarter; thence on a NAD 83 Kansas South Zone bearing of South 00°32'32" East on the East line of said Southeast Quarter of the Northeast Quarter a distance of 333.23 feet to the point of beginning; thence continuing South 00°32'32" East on said East line a distance of 478.71 feet; thence South 89°27'28" West perpendicular to said East line a distance of 557.75 feet; thence North 00°32'32" East on said East line a distance of 443.78 feet; thence North 54°48'13" East a distance of 83.90 feet; thence South 89°02'41" East a distance of 488.90 feet to the point of beginning.

Containing 6.184 Acres and subject to a road right of way easement across the East 33.00 feet thereof and any other easements or restrictions of record.

##### PARCEL 2

A portion of the Southeast of the Northeast Quarter of Section 36, Township 19 South, Range 2 West of the 6th Principal Meridian, McPherson County, Kansas described as follows:

Commencing at the Northeast corner of said Southeast Quarter of the Northeast Quarter; thence on a NAD 83 Kansas South Zone bearing of South 00°32'32" East on the East line of said Southeast Quarter of the Northeast Quarter a distance of 811.94 feet to the point of beginning; thence continuing South 00°32'32" East on said East line a distance of 507.43 feet to the Southeast corner of said Northeast Quarter; thence South 89°29'47" West on the South line of said Northeast Quarter a distance of 1322.25 feet to the Southwest corner of the Southeast Quarter of said Northeast Quarter; thence North 00°34'58" West on the West line of said Southeast Quarter of the Northeast Quarter a distance of 1320.30 feet to the Northwest corner of said Southeast Quarter of the Northeast Quarter; thence North 89°32'12" East on the North line of said Southeast Quarter of the Northeast Quarter a distance of 834.41 feet to a point 488.77 feet West of the Northeast corner of said Southeast Quarter of the Northeast Quarter; thence South 00°32'57" East a distance of 321.13 feet; thence South 54°48'13" West a distance of 83.90 feet; thence South 00°32'32" East parallel with the East line of said Southeast Quarter of the Northeast Quarter a distance of 443.78 feet; thence North 89°27'28" East perpendicular to said East line a distance of 557.75 feet to the point of beginning.

Containing 30.223 Acres and subject to a road right of way easement across the East 33.00 feet thereof and any other easements or restrictions of record.

##### PARCEL 3

A portion of the Southeast of the Northeast Quarter of Section 36, Township 19 South, Range 2 West of the 6th Principal Meridian, McPherson County, Kansas described as follows:

Commencing at the Northeast corner of said Southeast Quarter of the Northeast Quarter; thence on a NAD 83 Kansas South Zone bearing of South 00°32'32" East on the East line of said Southeast Quarter of the Northeast Quarter a distance of 318.00 feet to the point of beginning; thence continuing South 00°32'32" East on said East line a distance of 488.90 feet to the point of beginning; thence North 00°32'57" West a distance of 15.23 feet; thence South 89°02'41" East a distance of 488.90 feet to the point of beginning.

Containing 0.171 Acre and subject to a road right of way easement across the East 33.00 feet thereof and any other easements or restrictions of record.

#### NOTE:

Survey was made as per client request and no title work has been provided to the surveyor; therefore, the number and extent of easements and/or rights-of-way of record affecting the surveyed property has not been addressed by this survey.

#### SURVEYOR'S CERTIFICATE:

I hereby certify this plat to be a true, correct and complete representation of the property described hereon, as surveyed under my supervision, this 20th day of March, 2020.

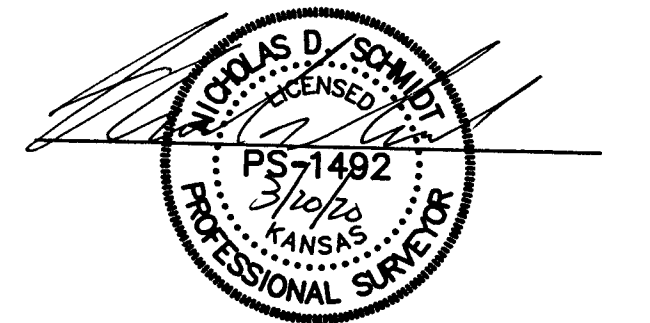

Prepared For:	DUANE BECKER			Description:	A PORTION OF THE SE 1/4, NE 1/4 SECTION 36, T19S, R2W McPHERSON COUNTY, KANSAS		
Prepared By:	GSS			Garber Surveying Service, P.A.			
Drawn By:	KDZ	Scale:	1"=200'	Date of Field Work:	February 2, 2020	Job No:	G2020-137
Checked By:	NDS	Date:	03/20/2020	Sheet	1 of 1 Sheet(s)		

HUTCHINSON (Main Office)	2908 North Plum St. 67502	Ph. 620-665-7032 Fax 620-663-7401
McPHERSON (Branch Office)	115 East Marlin 67460	Ph. 620-241-4441 Fax 620-241-4458
NEWTON (Branch Office)	511 North Poplar St. 67114	Ph. 316-283-5053 Fax 316-283-5073
MANHATTAN (Branch Office)	3226 Kimball Ave Ste. #2 66503	Ph. 785-320-4810