

DESCRIPTION:  
A portion of the Northwest Quarter of Section 35, Township 21 South, Range 5 West of the 6th Principal Meridian, McPherson County, Kansas described as follows:  
Commencing at the Southwest corner of said Northwest Quarter; thence North 00°16'52" East (basis of bearings is assumed) along the West line of said Northwest Quarter 524.00 feet for the point of beginning; thence continuing North 00°16'52" East along the West line of said Northwest Quarter 373.00 feet; thence South 88°33'01" East 346.00 feet; thence South 00°16'52" West parallel with the West line of said Northwest Quarter 10.00 feet; thence South 86°02'33" East 291.92 feet; thence South 00°16'52" West parallel with the West line of said Northwest Quarter 302.78 feet; thence South 87°11'12" West 638.18 feet to the point of beginning, containing 5.000 Acres, subject to a road right-of-way easement across the West 50.00 feet thereof and any other easements of record.

ADDRESS:  
62 4th Avenue, Inman, Kansas 67546

GENERAL NOTES:  
1) Section corner reference ties filed with the Kansas State Historical Society and the McPherson County Public Works Department as required by KSA 1987 Supp. 58-2001.  
2) No titlework was provided by client for subject property. Easements and rights-of-ways affecting subject property are not shown.

SURVEYORS CERTIFICATE:  
I hereby certify that this Survey was made under my supervision on February 7, 2008.

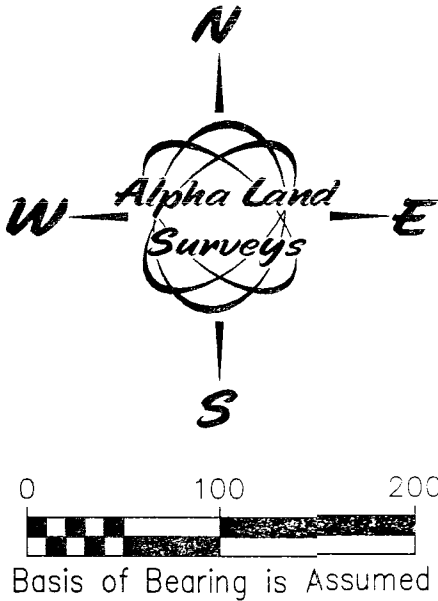

|   |                    |
|---|--------------------|
| BRAD KROEKER  |                    |
| Alpha Land Surveys, Inc.<br>One East Ninth Avenue<br>Hutchinson, Kansas 67501<br>Ph: (620) 728-0012 Fax: (620) 728-0413 |                    |
| Drawn By: LPD   | Sheet 1 Of 1       |
| Checked By: RDB   | Proj. No.: 080009B |