

# KIOWA ROAD

N 89°27'37" E 2,666.62 (M) 2,667.26 (PS)

P.O.C.  
NE Cor. NE 1/4  
Sec. 35, T19S, R4W  
Fd. 5/8" Rebar  
Origin: (PS)

N 89°27'37" E  
381.00 (C)(PS)

N 89°27'37" E 1,513.36 (C)(PS)

1,527.12 (M)

NW Cor. NE 1/4  
Sec. 35, T19S, R4W  
Fd. 5/8" Rebar w/ Aluminum KDOT Cap  
Origin: (PS)

N 89°27'37" E 772.26 (C) 772.90 (PS)

33' R/W Line

37.61 (C)  
488.78 (M) 488.98 (PS)  
N 24°48'28" E  
526.39 (C)  
525.50 (PS)

N 89°29'43" E  
125.27 (M) 125.00 (PS)

N 00°45'29" W  
93.71 (M) 94.00 (PS)

N 89°29'41" E  
87.29 (M) 88.10 (PS)

N 00°56'53" W  
600.68 (M) 600.30 (PS)

N 89°35'31" E  
329.71 (M)  
329.80 (PS)

## EXISTING PARCEL

(Bk. 253, Pg. 228)  
(129.17 Acres)

123.69 Acres Excluding New Tract

S 89°05'52" W  
24.93 (M) 25.00 (PS)

S 00°37'21" E  
265.61 (M)(PS)

Reset per (PS)

N 89°25'41" E  
406.00 (C)(PS)

## NEW TRACT 5.48 Acres

(To be joined with existing  
parcel to the South)

S 09°31'45" W  
534.64 (M)

S 00°39'11" E  
523.86 (M) 524.00 (PS)

S 89°23'10" W  
500.31 (C)  
500.00 (PS)

EXISTING PARCEL  
(Bk. 243, Pg. 656)

S 89°25'10" W  
500.23 (M) 500.00 (PS)

SE Cor. NE 1/4  
Sec. 35, T19S, R4W  
Fd. 5/8" Rebar  
Origin: (PS)

S 00°35'33" E 1,338.24 (C)(PS)

1,305.24 (M)(PS)

S 00°36'53" E 1,603.85 (C)(PS)

11th AVENUE

P.O.B.

S 00°36'53" E  
626.99 (C)

S 00°36'53" E 524.19 (C) 524.00 (PS)

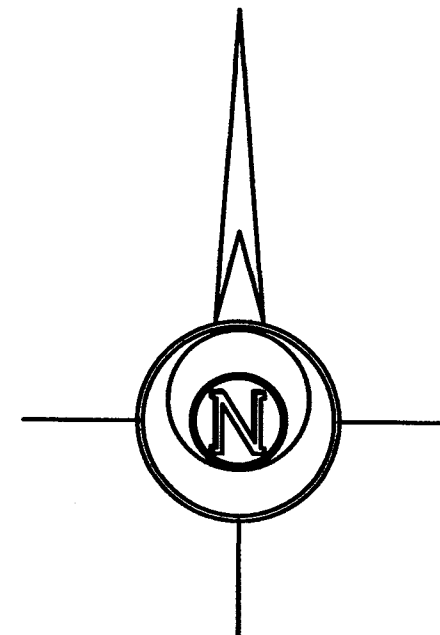

-200 0 200 400 600

BASIS OF BEARING = NAD 83 KANSAS SOUTH ZONE

## LEGEND

- △ - Sectional Monument Found
- - Survey Monument Found 5/8" Rebar from (PS) unless otherwise noted
- - 5/8" x 24" Iron Rebar Set w/GSS Cap
- (C) - Calculated
- (M) - Measured
- (PS) - Previous Survey GSS Project #G97-628 and Record measurement per (Bk. 253, Pg. 228)
- P.O.B. - Point of Beginning
- P.O.C. - Point of Commencement

## NEW TRACT DESCRIPTION:

A portion of the Northeast Quarter of Section 35, Township 19 South, Range 4 West of the 6th Principal Meridian, McPherson County, Kansas, described as follows by Nicholas D. Schmidt, PS #1492, this 6th day of September, 2024:

Commencing at the Northeast corner of said Northeast Quarter; thence on a NAD 83 Kansas South Zone bearing of South 00°36'53" East on the East line of said Northeast Quarter a distance of 1603.85 feet to the Southeast corner of a parcel described in Book 644, Page 6006 at the McPherson County Register of Deeds Office, being the point of beginning; thence continuing South 00°36'53" East on said East line a distance of 525.99 feet to the Northeast corner of a second parcel recorded in Book 243, Page 656 at the McPherson County Register of Deeds Office; thence South 89°23'10" West on the North line of said second parcel a distance of 500.31 feet to the Northwest corner of said second parcel; thence North 09°31'45" East a distance of 534.64 feet to the Southwest corner of said parcel recorded in Book 644, Page 6006; thence North 89°25'41" East on the South line thereof a distance of 406.00 feet to the point of beginning.

The above described tract contains 5.48 Acres and is subject to a road right of way easement along the East line thereof, and any other easements or restrictions of record.

## SURVEYOR'S CERTIFICATE:

I hereby certify this plat to be a true, correct and complete representation of the property described hereon, as surveyed under my supervision, this 10th day of September, 2024.

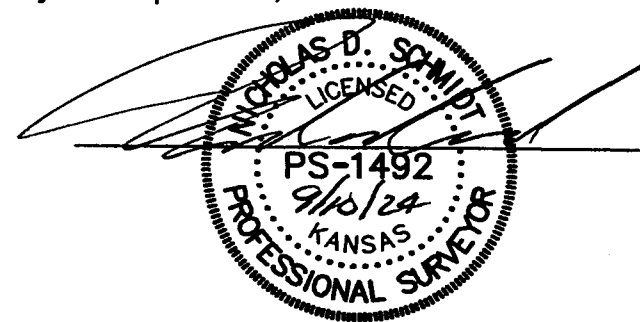

Prepared For:

WILLIAM SCHRAG TRUST

Description:

A PORTION OF THE NE 1/4  
SECTION 35, T19S, R4W  
MCPHERSON COUNTY, KANSAS

Prepared By:

Garber Surveying Service, P.A.



HUTCHINSON  
2908 North Plum St. 67502  
Ph. 620-665-7032  
(Main Office)

BRANCH OFFICES:  
MCPHERSON Ph. 620-241-4441  
SALINA Ph. 785-404-6302  
MANHATTAN Ph. 785-320-4810  
NEWTON Ph. 316-283-5053  
WICHITA Ph. 316-260-9933

Drawn By:

MGO

Scale: 1"=200'

Date of Field Work: August 19, 2024

Job No:

Checked By:

NDS

Date: 09/10/2024

Sheet 1 of 1 Sheet(s)

G2024-665