

-200 0 200 400 600

BASIS OF BEARING = NAD 83 KANSAS SOUTH ZONE

DESCRIPTION:

PARCEL 1

A portion of the North Half of the Southeast Quarter of Section 34, Township 21 South, Range 2 West of the 6th Principal Meridian, McPherson County, Kansas, described as follows by Nicholas D. Schmidt, PS #1492, this 22nd day of March, 2022:

Beginning at the Northeast corner of said Southeast Quarter; thence on a NAD 83 Kansas South Zone bearing of South 00°28'02" East on the East line of said Southeast Quarter a distance of 724.67 feet; thence South 89°28'09" West a distance of 1325.61 feet; thence North 00°43'22" East a distance of 724.67 feet to the North line of said Southeast Quarter; thence North 89°27'42" East on said North line a distance of 1310.56 feet to the point of beginning.

Containing 21.93 Acres and subject to a road right of way easement along the East line thereof and any other easements or restrictions of record.

PARCEL 2

A portion of the North Half of the Southeast Quarter of Section 34, Township 21 South, Range 2 West of the 6th Principal Meridian, McPherson County, Kansas, described as follows by Nicholas D. Schmidt, PS #1492, this 22nd day of March, 2022:

Commencing at the Northeast corner of said Southeast Quarter; thence on a NAD 83 Kansas South Zone bearing of South 00°28'02" East on the East line of said Southeast Quarter a distance of 724.67 feet to the point of beginning; thence continuing South 00°28'02" East on said East line a distance of 597.95 feet to the Southeast corner of the North Half of said Southeast Quarter; thence South 89°21'05" West on the South line of said North Half a distance of 2647.52 feet to the Southwest corner of said North Half; thence North 00°25'13" West on the West line of said Southeast Quarter a distance of 1327.72 feet to the Northwest corner of said Southeast Quarter; thence North 89°27'42" East on the North line of said Southeast Quarter a distance of 1335.86 feet; thence South 00°43'22" West a distance of 724.67 feet; thence North 89°28'09" East a distance of 1325.61 feet to the point of beginning.

Containing 58.60 Acres and subject to a road right of way easement along the East line thereof and any other easements or restrictions of record.

SURVEYOR'S CERTIFICATE:

I hereby certify this plat to be a true, correct and complete representation of the property described hereon, as surveyed under my supervision, this 22nd day of March, 2022.

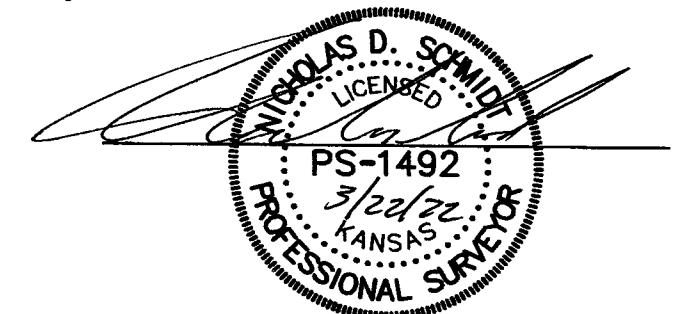

SURVEYOR'S NOTE:

- Survey was made as per client request and no title work has been provided to the surveyor; therefore, the number and extent of easements and/or rights-of-way of record affecting said property has not been verified by this Survey.

LEGEND

- △ - Sectional Monument Found
- ▲ - Section Monument Set (5/8" x 24" Iron Rebar w/GSS CLS 52 Cap)
- - Survey Monument Found
- - 5/8" x 24" Iron Rebar Set w/GSS CLS Cap
- (C) - Calculated
- (M) - Measured
- (PS) - Previous Survey GSS Project #G2013-191
- (PS1) - Previous Survey by Thrower LS 1297, 7/28/2001
- P.O.B. - Point of Beginning
- P.O.C. - Point of Commencement

Prepared For: FRANK BARNETT		Description: THE N 1/2, SE 1/4 SECTION 34, T21S, R2W McPHERSON COUNTY, KANSAS	
Prepared By: Garber Surveying Service, P.A.			
Drawn By: KDZ		Scale: 1"=200'	Date of Field Work: March 10, 2022
Checked By: NDS		Date: 03/22/2022	Sheet 1 of 1 Sheet(s)
		Job No: G2022-183	