

LEGEND

- △ - Sectional Monument Found
- ▲ - Section Monument Set (5/8" x 24" Iron Rebar w/G.S.S. Cap)
- x- - Fence
- (C) - Calculated
- (M) - Measured
- P.O.B. - Point of Beginning

DESCRIPTION:

PARCEL 1:

A portion of the Northwest Quarter of Section 34, Township 21 South, Range 1 West of the 6th Principal Meridian, McPherson County, Kansas more particularly described as follows: Beginning at the Northwest Corner of the Northwest Quarter of Section 34, Township 21 South, Range 1 West of the 6th Principal Meridian; thence with an assumed bearing North 89°30'46" East along the North line of said Northwest Quarter 652.48 feet; thence South 00°38'02" West 701.22 feet; thence South 77°24'42" East 19.00 feet; thence South 01°34'02" West 277.80 feet; thence South 04°12'14" West 375.53 feet; thence South 89°31'27" West 631.28 feet to the West line of said Northwest Quarter; thence North 00°10'04" East along the West line of said Northwest Quarter 1357.25 feet to the point of beginning, containing 20.257 Acres, subject to road rights-of-way across the West and North 33.00 feet thereof and any other easements of record.

PARCEL 2

A portion of the Northwest Quarter of Section 34, Township 21 South, Range 1 West of the 6th Principal Meridian, McPherson County, Kansas more particularly described as follows: Commencing at the Northwest Corner of the Northwest Quarter of Section 34, Township 21 South, Range 1 West of the 6th Principal Meridian; thence with an assumed bearing North 89°30'46" East along the North line of said Northwest Quarter 652.48 feet to the point of beginning; thence continuing North 89°30'46" East along the North line of said Northwest Quarter 1977.84 feet to the Northeast corner of said Northwest Quarter; thence South 00°17'14" East along the East line of said Northwest Quarter 2650.87 feet to the Southeast corner of said Northwest Quarter; thence South 89°32'08" West along the South line of said Northwest Quarter 2651.36 feet to the Southwest corner of said Northwest Quarter; thence North 00°10'04" East along the West line of said Northwest Quarter 1292.73 feet; thence North 89°31'27" East 631.28 feet; thence North 04°12'14" East 375.53 feet; thence North 01°34'02" East 277.80 feet; thence North 77°24'42" West 19.00 feet; thence North 00°38'02" East 701.22 feet to the point of beginning, containing 140.420 Acres, subject to road rights-of-way across the North and West 33.00 feet thereof and any other easements of record.

SURVEYOR'S CERTIFICATE:

I hereby certify this plat to be a true, correct and complete representation of the property described hereon, as surveyed under my supervision, this 19th day of June, 2007.

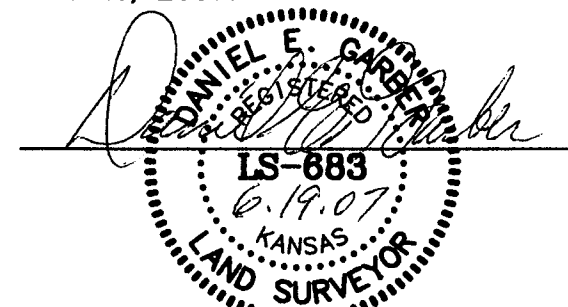

Daniel E. Garber LS

Prepared For: MILFORD WEAVER		Description: A PORTION OF THE NW 1/4 SEC. 34, T21S, R1W	
Prepared By: GSS		Garber Surveying Service, P.A. 423 West 1st Ave. 129 E. Broadway, Suite 300 Hutchinson, Kansas 67501 Newton, Kansas 67114 Phone (620) 665-7032 • FAX (620) 663-7401 Phone (316) 283-5053 • FAX (316) 283-5073	
Drawn By: AL	Scale: 1"=300'	Date of Field Work: May 8, 2007	Job No:
Checked By: DEG	Date: 06/12/2007	Sheet 1 of 1 Sheet(s)	G2007-221