



LEGEND

- △ - Section Monument Found
- ▲ - Section Monument Set (5/8" x 24" Iron Rebar w/G.S.S. Cap)
- - Survey Monument Found
- - 5/8" x 24" Iron Rebar Set w/G.S.S. Cap
- (C) - Calculated
- (M) - Measured
- (PS1) - Previous Survey By Macon Company, INC. Dated 6/13/1988
- (PS2) - Previous Survey GSS Project G97-37 Dated 1/22/1997
- (PS3) - Previous Survey GSS Project G12-58 Dated 10/5/2012
- (G.O) - General Land Office
- P.O.B. - Point of Beginning
- P.O.C. - Point of Commencement

DESCRIPTION:

A portion of the South Half of the Southwest Quarter of Section 34, Township 19 South, Range 1 West of the 6th Principal Meridian, McPherson County, Kansas described as follows:

Commencing at the Southwest corner of the Southwest Quarter of Section 34, Township 19 South, Range 1 West of the 6th Principal Meridian; thence on a Kansas State Plane Zone 1502 Bearing North 00°46'30" West along the West line of said Southwest Quarter 971.15 feet to the point of beginning; thence continuing North 00°46'30" West along said West line 335.50 feet to the Northwest corner of the South Half of said Southwest Quarter; thence North 89°34'11" East along the North line of said South Half 768.74 feet; thence South 00°46'30" East parallel with said West line 335.50 feet; thence South 89°34'11" West parallel with said North line 768.74 feet to the point of beginning, containing **5.921 Acres**, subject to a road right of way easement across the West 33.00 feet thereof and any other easements or restrictions of record.

SURVEYOR'S NOTES

- 1) Set by single proportionate measurement between Northeast and Northwest section corners in accordance with previous survey by Dan Garber (PS2).
- 2) Set by single proportionate measurement between Northeast and Southeast section corners in accordance with previous survey by Dan Garber (PS2).

SURVEYOR'S CERTIFICATE:

I hereby certify this plat to be a true, correct and complete representation of the property described hereon, as surveyed under my supervision, this 28th day of April, 2014.

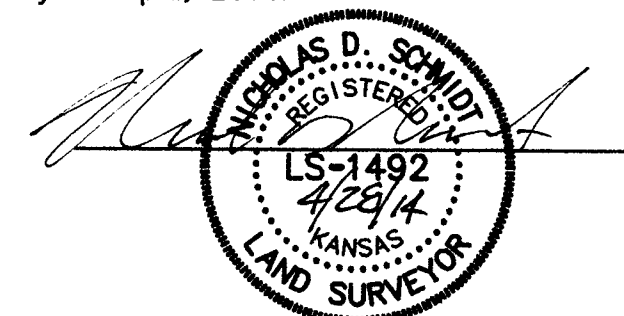

Prepared For:

WRAY RATZLAFF

Description:

**A PORTION OF THE S 1/2, SW 1/4
SECTION 34, T19S, R1W
MCPHERSON COUNTY, KANSAS**

Prepared By:

Garber Surveying Service, P.A.



HUTCHINSON (Main Office) MCPHERSON (Branch Office) NEWTON (Branch Office)	2908 North Plum St. 67502 115 East Marlin 67460 511 North Poplar St. 67114	Ph. 620-665-7032 Fax 620-663-7401 Ph. 620-241-4441 Fax 620-241-4458 Ph. 316-283-5053 Fax 316-283-5073
--	--	---

Drawn By: CSS

Scale: 1"=200'

Date of Field Work: April 21, 2014

Job No:

G2014-262

Checked By: NDS

Date: 4/28/2014

Sheet 1 of 1 Sheet(s)