

P.O.C.
NW Cor. NW 1/4
Sec. 34, T17S, R1W
Fd. 5/8" Rebar w/LS 1202 Cap
Origin: LS 1202

27th AVENUE

896.67 (C)

N 00°09'47" E 2648.15 (M)
N 00°09'47" W 354.52 (C)

33.00 (C)

1396.96 (C)

SW Cor. NW 1/4
Sec. 34, T17S, R1W
Fd. 3/4" Rebar
Origin Unknown

SEPTIC TANK

HOUSE

BARN

Silo Silo

Grain Bin Grain Bin

S 89°06'46" W 994.16 (C)

N 89°36'13" E 995.76 (C)

8.000 Acres

LEGEND

- △ - Sectional Monument Found
- - 5/8" x 24" Iron Rebar Set w/G.S.S. Cap
- (C) - Calculated
- (M) - Measured

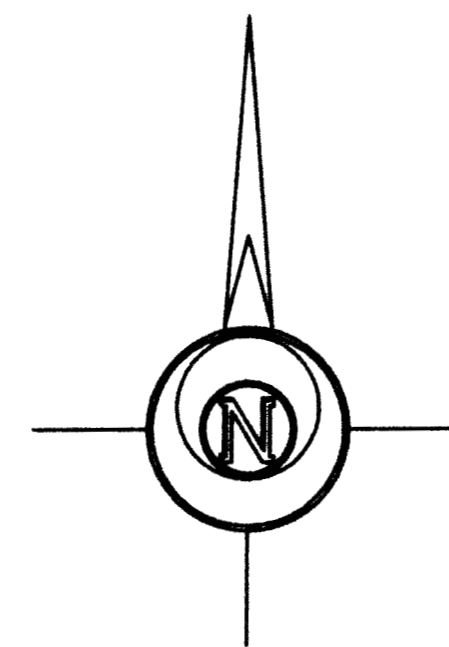

-80 0 80 160 240

BASIS OF BEARING = KANSAS STATE PLANE GRID

DESCRIPTION:

A portion of the Northwest Quarter of Section 34, Township 17 South, Range 1 West of the 6th Principal Meridian, McPherson County, Kansas described as follows:

Commencing at the Northwest corner of the Northwest Quarter of Section 34, Township 17 South, Range 1 West of the 6th Principal Meridian; thence on a Kansas State Plane Grid Bearing South 00°09'47" East along the West line of said Northwest Quarter 896.67 feet to the point of beginning; thence North 89°36'13" East 995.76 feet; thence South 00°06'52" West 346.02 feet; thence South 89°06'46" West 994.16 feet to the West line of said Northwest Quarter; thence North 00°09'47" West along said West line 354.52 feet to the point of beginning, containing 8.000 Acres, subject to a road right of way easement across the West 33.00 feet thereof and any other easements or restrictions of record.

SURVEYOR'S CERTIFICATE:

I hereby certify this plat to be a true, correct and complete representation of the property described hereon, as surveyed under my supervision, this 13th day of June, 2013.

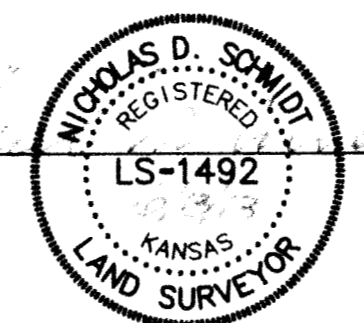

Prepared For: RYAN CHRISTIANSEN		Description: A PORTION OF THE NW 1/4 SECTION 34, T17S, R1W MCPHERSON COUNTY, KANSAS	
Prepared By: GSS		Garber Surveying Service, P.A.	
HUTCHINSON (Main Office) 2908 North Plum St. 67502 Ph. 620-665-7032 Fax 620-663-7401		McPHERSON (Branch Office) 115 East Marlin 67460 Ph. 620-241-4441 Fax 620-241-4458	
NEWTON (Branch Office) 511 North Poplar St. 67114 Ph. 316-283-5053 Fax 316-283-5073			
Drawn By: CSS	Scale: 1"=80'	Date of Field Work: June 6th, 2013	Job No:
Checked By: NDS	Date: 06/13/2013	Sheet 1 of 1 Sheet(s)	G2013-328