

- LEGEND**
- △ - Sectional Monument Found
 - - Found 5/8" Rebar w/G.S.S. Cap
 - - 5/8" x 24" Iron Rebar Set w/G.S.S. Cap
 - (C) - Calculated
 - (M) - Measured
 - (PS) - Previous Survey by GSS Project #62014-576
 - P.O.B. - Point of Beginning
 - P.O.C. - Point of Commencement

DESCRIPTION:

TRACT 1A

A portion of the Northeast Quarter of Section 33, Township 20 South, Range 1 West of the 6th Principal Meridian, McPherson County, Kansas described as follows:

Commencing at the Northwest corner of said Northeast Quarter; thence on a NAD 83 Kansas South Zone bearing of North 88°46'22" East on the North line of said Northeast Quarter a distance of 93.51 feet to the point of beginning; thence continuing North 88°46'22" East on said North line of said Northeast Quarter a distance of 1920.70 feet; thence South 00°03'41" East a distance of 1380.53 feet; thence South 89°01'10" West a distance of 714.74 feet; thence North 00°19'57" West a distance of 22.00 feet; thence South 89°28'09" West a distance of 1237.00 feet; thence North 37°56'37" West a distance of 39.39 feet; thence North 00°01'50" East parallel with the West line of said Northeast Quarter a distance of 1267.00 feet; thence North 51°12'00" East a distance of 68.66 feet to the point of beginning.

Containing **61.582 Acres** and subject to a road right of way easement across the North 33.00 feet thereof and any other easements or restrictions of record.

TRACT 1B

A portion of the Northeast Quarter of Section 33, Township 20 South, Range 1 West of the 6th Principal Meridian, McPherson County, Kansas described as follows:

Beginning at the Northwest corner of said Northeast Quarter; thence on a NAD 83 Kansas South Zone bearing of North 88°46'22" East on the North line of said Northeast Quarter a distance of 93.51 feet; thence South 51°12'00" West a distance of 68.66 feet; thence South 00°01'50" West parallel with the West line of said Northeast Quarter a distance of 1267.00 feet; thence South 37°56'37" East a distance of 39.39 feet; thence North 89°28'09" East a distance of 1237.00 feet; thence South 00°19'57" East a distance of 1306.46 feet to the South line of said Northeast Quarter; thence South 88°56'52" West on said South line a distance of 1309.69 feet to the Southwest corner of said Northeast Quarter; thence North 00°01'50" East on the West line of said Northeast Quarter a distance of 2658.10 feet to the point of beginning.

Containing **40.595 Acres** and subject to a road right of way easement across the North 33.00 feet thereof and any other easements or restrictions of record.

SURVEYOR'S CERTIFICATE:

I hereby certify this plat to be a true, correct and complete representation of the property described hereon, as surveyed under my supervision, this 1st day of February, 2018.

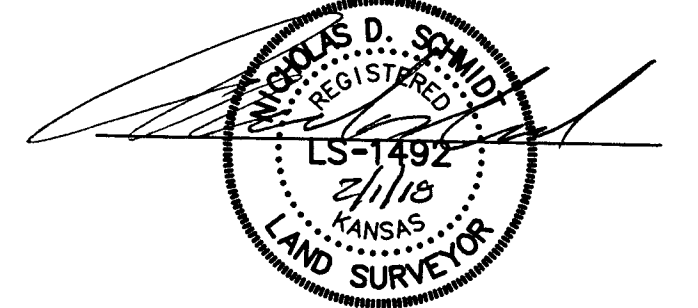

Prepared For: RICHARD MORGAN		Description: A PORTION OF THE NE 1/4 SECTION 33, T20S, R01W MCPHERSON COUNTY, KANSAS	
Prepared By: GSS		Garber Surveying Service, P.A.	
HUTCHINSON (Main Office) 2908 North Plum St. 67502 Ph. 620-665-7032 Fax 620-663-7401		McPHERSON (Branch Office) 115 East Martin 67460 Ph. 620-241-4441 Fax 620-241-4458	
NEWTON (Branch Office) 511 North Poplar St. 67114 Ph. 316-283-5053 Fax 316-283-5073			
Drawn By: KDZ	Scale: 1"=200'	Date of Field Work: January 25, 2018	Job No: G2018-44
Checked By: NDS	Date: 02/01/2018	Sheet 1 of 1 Sheet(s)	