

NW Corner
33-19S-4W
2" Metal Cap Found

1,433.72 (M), 1,433.63 (P)
S 00°-00'-00" E (ASSUMED)
S 00°-00'-00" E (P)

Scale: 1" = 400'

Fence is located
outside property

992.32' (P) *

670.81' (M), 671.11 (P)
S 89°-58'-57" W (M)

N 89°-59'-34" W (P)

168.09' (M), 167.95 (P)
N 00°-08'-52" W (M)

N 00°-10'-40" W (P)

111.87' (M), 112.50 (P)
N 18°-08'-12" W (M)

N 18°-08'-55" W (P)

316.58' (M), 316.77 (P)
N 82°-37'-24" W (M)

N 82°-37'-15" W (P)

1,481.82 (M)
S 89°-46'-02" E (M)

82.18' (M)
S 01°-22'-42" W (ASSUMED)

S 01°-23'-00" W (P)

S. Line of N 1/2, NW 1/4

21.07 (M & P)
N 89°-51'-19" W (M)
N 89°-50'-35" W (P)

N 1/4 Corner
33-19S-4W
2" Metal Cap Found

245'

110'

40' X 64' Metal Building

832.85 (M), 832.62 (P)
S 00°-11'-54" W (M)

S 00°-12'-16" W (P)

2,623.54

N 89°-50'-10" W

NE Corner
33-19S-4W
5/8" Rebar Found

30' County Road
Right-of-way

Area 30' Back from Ditch
Subject to Agreement (Volume Misc. 239, Page 335)

N 10°-28'-00" N

LEGAL DESCRIPTION:

North Half of the Northeast Quarter (N1/2, NE 1/4)

AND

North Half of the Northwest Quarter (N1/2, NW 1/4), Except
the following described property: That part of the following
described property lying within the N1/2 of the NW 1/4:

Beginning at the Northwest corner of Section 33; Thence South
1433.63 feet; Thence North 88°-07'-57" East, 1146.72 feet;
Thence North 01°-23'-00" East, 892.32 feet; Thence South
89°-59'-34" East, 671.11 feet; Thence South 00°-10'-40"
East, 167.95 feet; Thence South 87°-11'-50" East, 412.43
feet; Thence South 18°-08'-55" East, 112.50 feet; Thence
South 82°-37'-15" East, 316.77 feet; Thence North 00°-12'-
16" East, 832.62 feet; Thence North 89°-50'-35" West, 2,603.38
feet to the point of beginning.

All in Section 33, Township 19 South, Range 4 West of the 6th
P.M., in McPherson County, Kansas.

LEGEND:

- Government Corner Found
- Iron/Rebar Found
- 5/8" Rebar Set
- (M) Measured Distance or Bearing
- (P) Record Distance or Bearing
- Existing Fence

TO

Koch Industries, Inc.
McPherson County Abstract & Title Company
Chicago Title Insurance Company

The undersigned hereby certifies that to the best of his professional
knowledge, information and belief, this map or plat and the survey
on which it is based was made on the date shown below of the
premises specifically described in CHICAGO TITLE INSURANCE
COMPANY'S Commitment No. 56636, dated October 24, 1997,
at 8:00 A.M., and was made (i) in accordance with the
"Minimum Standard Detail Requirements and Classifications for
ALTA/ACSM Land Title Surveys", jointly established and adopted by
ALTA and ACSM in 1992; (ii) pursuant to accuracy standards
as adopted by ALTA and ACSM and in effect on the date of this
certification of a RURAL survey.

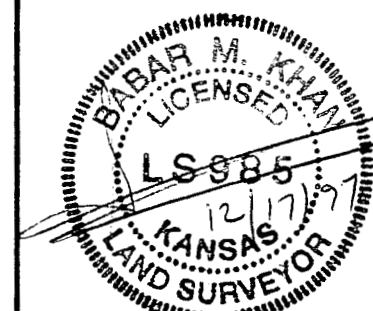

Babar M. Khan, L.S.
Register Land Surveyor No.: 985
In the State of Kansas
Date of Survey: December 17, 1997

* Revised 12-19-97 BCU

SCALE:	APPROVED:	DRAWN BY:
DATE:	CHECKED:	
PROJECT NO.:	SHEET NO.:	
97-158 (Municipal)		

ME MUNICIPAL ENGINEERS, P.A.
254-LAURA, SUITE 201
WICHITA, KANSAS 67211
316-282-3842

W 1/4 Corner
33-19S-4W
1/2" Rebar Found

EXCEPTIONS LISTED IN TITLE POLICY NOT SHOWN ON SURVEY:

- Item # 13: Document not legible
- Item # 14 thru 18: These are blanket grants and cover entire property.
- Item # 20 ~ 22: These are blanket grants and cover entire property.
- Item # 19: Ditch mentioned in document is outside property.

SW Corner
33-19S-4W
1/2" Rebar Found

Center
33-19S-4W
Not Found

33

S 1/4 Corner
33-19S-4W
Not Found

E 1/4 Corner
33-19S-4W
Not Found

SE Corner
33-19S-4W
Not Found

ALTA/ACSM SURVEY

FOR
N 1/2, NE 1/4 & PART OF N 1/2, NW 1/4
SECTION 33, TOWNSHIP 19 SOUTH, RANGE 4 WEST
MCPHERSON COUNTY, KANSAS

GENERAL NOTES:

- METAL BUILDING AREA = 2,560 S.F. (Outside), more or less
- LAND AREA = 102.9 Acres, More or Less
- Property is located in Zone 'C' according
to FIRM PANEL NO.: 200214 0200 B for
McPherson County, Kansas.

Theoretical location of this corner was
established by measurements taken from
previous country survey.