

#### LEGEND

- △ - Sectional Monument Found
- ▲ - Section Monument Set (5/8" x 24" Iron Rebar w/GSS CLS 52 Cap)
- - Fd. 5/8" Rebar w/GSS CLS 52 Cap (PS)
- - 5/8" x 24" Iron Rebar Set w/GSS CLS 52 Cap
- (c) - Calculated
- (M) - Measured
- (ps) - Previous Survey GSS Project #G2023-745
- P.O.B. - Point of Beginning

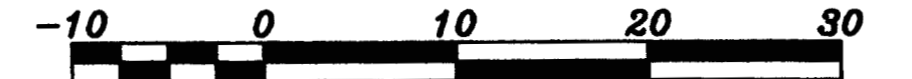
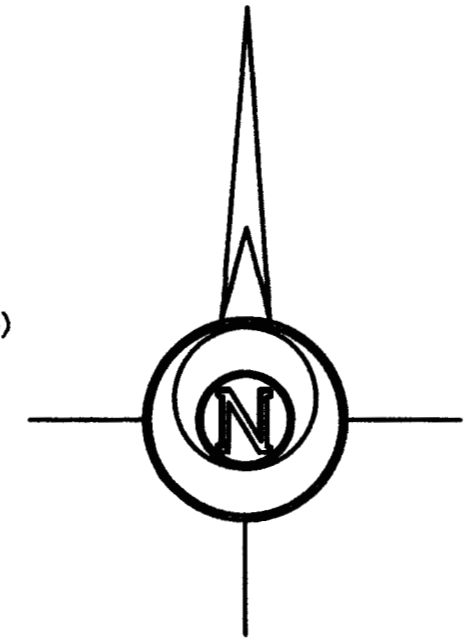

BASIS OF BEARING = NAD 83 KANSAS SOUTH ZONE

#### DESCRIPTION:

A portion of the Southeast Quarter of Section 33, Township 19 South, Range 2 West of the 6th Principal Meridian, McPherson County, Kansas, described as follows by Nicholas D. Schmidt, PS #1492, this 8th day of March, 2024:

Beginning at the Southwest corner of said Southeast Quarter; thence on a NAD 83 Kansas South Zone bearing of North 00°53'55" West on the West line of said Southeast Quarter a distance of 2237.78 feet; thence North 89°08'20" East parallel with the South line of said Southeast Quarter a distance of 1295.22 feet; thence South 00°07'09" East a distance of 1825.93 feet to the North line of a parcel described in Book 220, Page 61 at the McPherson County Register of Deeds Office; thence South 89°08'20" West on said North line a distance of 611.32 feet to the Northwest corner of said parcel; thence South 00°51'40" East on the West line of said parcel a distance of 412.00 feet to said South line; thence South 89°08'20" West on said South line a distance of 658.79 feet to the point of beginning.

Containing **60.00 Acres** and subject to a road right of way easement along the South line thereof and any other easements or restrictions of record.

#### SURVEYOR'S NOTES:

- Survey was made as per client request and no title work has been provided to the surveyor; therefore, the number and extent of easements and/or rights-of-way of record affecting said property has not been verified by this Survey.
- All measurements are in US Survey Feet.

#### SURVEYOR'S CERTIFICATE:

I hereby certify this plat to be a true, correct and complete representation of the property described hereon, as surveyed under my supervision, this 8th day of March, 2024.

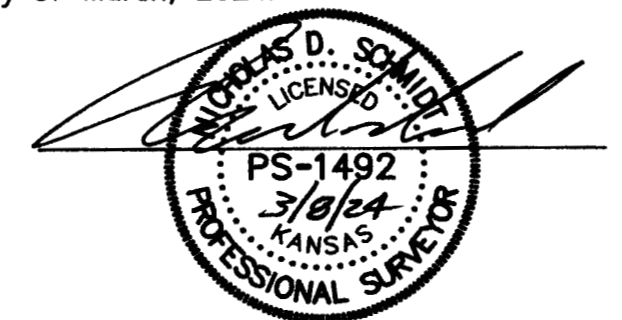

Prepared For: <b>SETH NIGHTINGALE</b>		Description: <b>A PORTION OF THE SE 1/4 SECTION 33, T19S, R2W McPHERSON COUNTY, KANSAS</b>	
Prepared By: <b>GSS HUTCHINSON</b> 2908 North Plum St. 67502 Ph. 620-665-7032 (Main Office)		BRANCH OFFICES: MCPHERSON Ph. 620-241-4441 SALINA Ph. 785-404-6302 MANHATTAN Ph. 785-320-4810 NEWTON Ph. 316-283-5053 WICHITA Ph. 316-260-9933	
Drawn By: <b>KDZ</b>	Scale: <b>1"=200'</b>	Date of Field Work: <b>February 27, 2024</b>	Job No: <b>G2024-137</b>
Checked By: <b>NDS</b>	Date: <b>03/08/2024</b>	Sheet <b>1 of 1</b> Sheet(s)	

Update To G2023-745