

Saved 2/7/2014 7:56:52 AM by KLOUTZEN  
Plot Date & Time Friday, February 07, 2014 11:42:34 AM Dwg Path U:\LDD\GSSFILES\2014\20140044 C3d.dwg\20140044 Auto S Ground

26th AVENUE

N 00°46'17" W 2640 (GLO) 2634.09 (PS) 2638.81 (M)

22.5' R/W Line

SW Cor. SW 1/4  
Sec. 33, T18S, R1W  
Fd. 1" Iron Pin (PS)  
Origin: Unknown

33' R/W Line

S 89°06'09" W 2640 (GLO) 2636.73 (M)  
**OVERLAND ROAD**

SW 1/4  
**159.521 Acres**

N 89°12'35" E 2644.78 (M)

NW 1/4

SE Cor. SW 1/4  
Sec. 33, T18S, R1W  
Fd. 1/2" Rebar w/Illegible Cap  
Origin: Brosemer LS 82

NE Cor. S 1/2 SW 1/4  
Sec. 33, T18S, R1W  
Fd. 4"x12" Sandstone on  
Edge in Line w/Fence Lines  
Origin: Unknown

NE Cor. SW 1/4  
Sec. 33, T18S, R1W

NE Cor. NW 1/4  
Sec. 33, T18S, R1W

S 00°46'49" E 1314.78 (M)

S 00°24'42" E 1314.13 (M)

NE Cor. SE 1/4  
Sec. 33, T18S, R1W  
Fd. Mag at Asphalt Surface  
Over 80 D Nail  
Origin: Unknown

N 89°12'35" E 2847.00 (M)

N 89°03'10" E 2852.52 (M)

NE Cor. NE 1/4  
Sec. 33, T18S, R1W  
Fd. Mag Nail at Surface  
Over 5/8" Rebar  
Origin: GSS

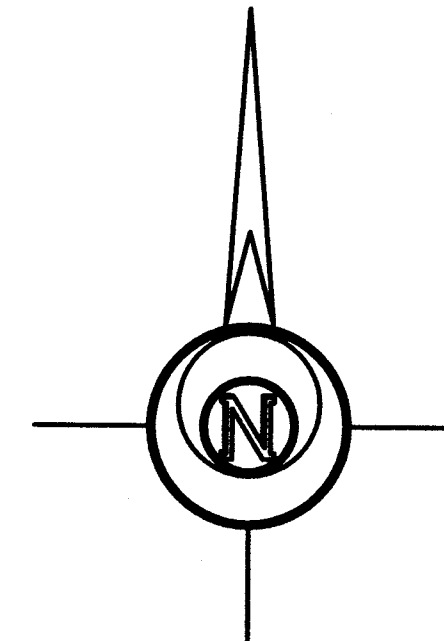

-200 0 200 400 600

BASIS OF BEARING = KANSAS STATE PLANE ZONE 1502

#### LEGEND

- △ - Sectional Monument Found
- ▲ - Section Monument Set (5/8" x 24" Iron Rebar w/G.S.S. Cap)
- - 5/8" x 24" Iron Rebar Set w/G.S.S. Cap
- (C) - Calculated
- (M) - Measured
- (PS) - Previous Survey GSS Project #G97-534
- (GLO) - General Land Office

#### DESCRIPTION:

The Southwest Quarter of Section 33, Township 18 South, Range 1 West of the 6th Principal Meridian, McPherson County, Kansas, containing 159.521 Acres and subject to road right of way easements across the South 33.00 feet and West 22.50 feet thereof and any other easements or restrictions of record.

#### SURVEYOR'S CERTIFICATE:

I hereby certify this plat to be a true, correct and complete representation of the property described hereon, as surveyed under my supervision, this 7th day of February, 2014.

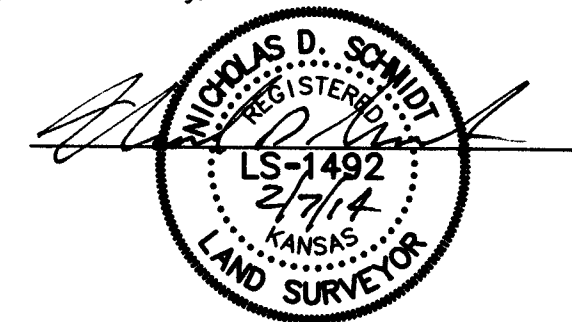

Prepared For: <b>GERALD JANZEN</b>		Description: <b>THE SW 1/4 SECTION 33, T18S, R1W MCPHERSON COUNTY, KANSAS</b>	
Prepared By: <b>GSS</b>		<b>Garber Surveying Service, P.A.</b>	
HUTCHINSON (Main Office) 2908 North Plum St. 67502 Ph. 620-665-7032 Fax 620-663-7401		McPHERSON (Branch Office) 115 East Marlin 67460 Ph. 620-241-4441 Fax 620-241-4458	
NEWTON (Branch Office) 511 North Poplar St. 67114 Ph. 316-283-5053 Fax 316-283-5073			
Drawn By: KLL	Scale: 1"=200'	Date of Field Work: January 24, 2014	Job No:
Checked By: NDS	Date: 02/07/2014	Sheet 1 of 1 Sheet(s)	<b>G2014-44</b>