

N

200 0 200 400 600

BASIS OF BEARING = KANSAS STATE PLANE ZONE 1502

LEGEND

- △ - Sectional Monument Found
- △ - Section Monument Set (5/8" x 24" Iron Rebar w/G.S.S. Cap)
- - Fd. 5/8" Rebar w/GSS Cap (PS)
- - 5/8" x 24" Iron Rebar Set w/G.S.S. Cap
- ⊙ - PVC Risers
- (C) - Calculated
- (M) - Measured
- (PS) - Previous Survey GSS Project # G95-867
- (R) - Record measurement (Bk. 650, Pg. 6073) (Bk. 651, Pg. 2164)

OVERALL DESCRIPTION:
The Southeast Quarter and a portion of the Southwest Quarter of Section 35, Township 21 South, Range 3 West of the 6th Principal Meridian, McPherson County, Kansas described as follows:

Beginning at the Southeast corner of the Southeast Quarter of Section 35, Township 21 South, Range 3 West of the 6th Principal Meridian; thence on a Kansas State Plane Grid Bearing South 89°35'20" West along the South line of said Southeast Quarter 2639.55 feet to the Southwest corner of said Southeast Quarter; thence South 89°33'17" West along the South line of the Southwest Quarter of said Section 35 a distance of 1732.50 feet (1732.00 Record); thence North 00°42'37" West parallel with the East line of said Southwest Quarter 66.00 feet (66.00 Record); thence North 89°33'17" East parallel with the South line of said Southwest Quarter 412.50 feet (412.50 Record); thence North 00°42'37" West parallel with the East line of said Southwest Quarter 792.00 feet (792.00 Record); thence South 89°33'17" West parallel with the South line of said Southwest Quarter 330.00 feet (330.00 Record); thence North 00°42'37" West parallel with the East line of said Southwest Quarter 1188.00 feet (1188.00 Record); thence North 89°33'17" East parallel with the South line of said Southwest Quarter 1650.00 feet (1650.00 Record) to the East line of said Southwest Quarter; thence North 00°42'37" West along the East line of said Southwest Quarter 580.64 feet to the Northeast corner of said Southwest Quarter; thence North 89°50'47" East along the North line of said Southwest Quarter 2632.23 feet to the Northeast corner of said Southeast Quarter; thence South 00°52'21" East along the East line of said Southeast Quarter 2614.86 feet to the point of beginning, containing **230.203 Acres**, subject to road right of way easements across the East and South 33.00 feet thereof and any other easements or restrictions of record.

SURVEYOR'S CERTIFICATE:
I hereby certify this plat to be a true, correct and complete representation of the property described hereon, as surveyed under my supervision, this 31st day of July, 2013.

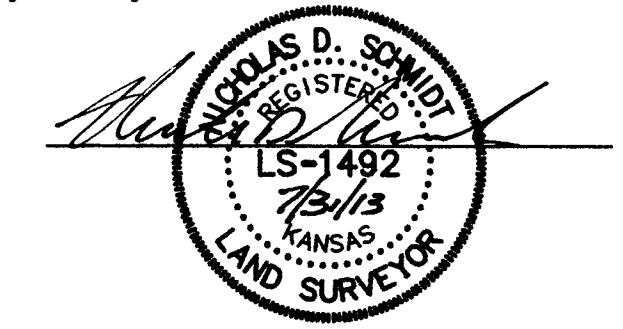

Prepared For: HARLEY MARSHALL		Description: PORTIONS OF THE SE 1/4 AND SW 1/4 SECTION 32, T21S, R3W MCPHERSON COUNTY, KANSAS	
Prepared By: GSS		Garber Surveying Service, P.A.	
HUTCHINSON (Main Office) 2908 North Plum St. 67502 Ph. 620-665-7032 Fax 620-663-7401		MCPHERSON (Branch Office) 115 East Marlin 67460 Ph. 620-241-4441 Fax 620-241-4458	
NEWTON (Branch Office) 511 North Poplar St. 67114 Ph. 316-283-5053 Fax 316-283-5073			
Drawn By: CSS	Scale: 1"=200'	Date of Field Work: July 08, 2013	Job No:
Checked By: NDS	Date: 07/31/2013	Sheet 1 of 1 Sheet(s)	G2013-400