

Saved 5/27/2014 7:57:25 AM by KLOUTZEN
Plot Date & Time Tuesday, May 27, 2014 7:57:34 AM Dwg Path \\Fs2\company\LOD\GSSFILES\2014\20140349 Auto S Ground

25th AVENUE

N 00°15'15" E 2639.54 (PS)(M)

33' R/W Line

33.00 (M)

SW Cor. NW 1/4
Sec. 32, T20S, R1W
Fd. 5/8" Rebar W/GSS Cap

CIMARRON ROAD

N 89°22'18" E 2636.77 (PS)(M)

NE Cor. NW 1/4
Sec. 32, T20S, R1W
Fd. 5/8" Rebar (PS)

P.O.B. 2

P.O.B. 1 N 89°22'18" E 1416.00 (C)

N 89°22'18" E 1220.77 (C)

PARCEL 2
24.159 Acres

S 00°37'42" E
342.38 (C)

33.00 (C)

121.4

128.2

33' R/W Line

Lagoon

C/L Berm

Building (Typical)

33.1

68.8

78.1

15.8

38.9

N 89°22'18" E 1146.66 (M)

33.00 (M)

S 00°41'18" W
522.54 (M)

S 53°25'42" W
151.77 (M)

S 01°04'49" W
520.90 (M)

S 52°17'08" W
119.82 (M)

S 00°38'03" W
385.72 (M)

S 75°15'20" W
85.80 (M)

S 00°42'33" W
279.84 (M)

S 39°38'29" W
534.74 (M)

S 89°26'37" W 1914.02 (M)

N 89°26'37" E 2644.25 (PS)(M)

S 89°26'37" W 730.23 (M)

SE Cor. NW 1/4
Sec. 32, T20S, R1W
Fd. 5/8" Rebar w/GSS Cap (PS)

- LEGEND**
- △ - Sectional Monument Found
 - - Survey Monument Found
 - - 5/8" x 24" Iron Rebar Set w/G.S.S. Cap
 - (C) - Calculated
 - (M) - Measured
 - (PS) - Previous Survey G2014-294

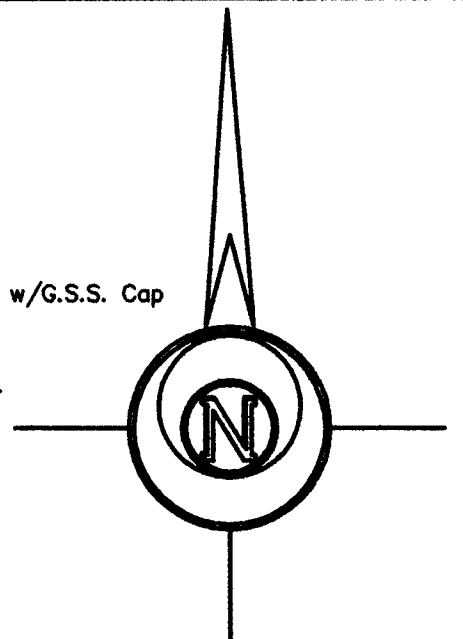

DESCRIPTION: BASIS OF BEARING = NAD 83 KANSAS ZONE 1502

PARCEL 1

A portion of the Northwest Quarter of Section 32, Township 20 South, Range 1 West of the 6th Principal Meridian, McPherson County, Kansas described as follows:

Beginning at the Northwest corner of the Northwest Quarter of Section 32, Township 20 South, Range 1 West of the 6th Principal Meridian; thence on a NAD 83 Kansas Zone 1502 bearing of North 89°22'18" East along the North line of said Northwest Quarter 1416.00 feet; thence South 00°37'42" East perpendicular to said North line 342.38 feet; thence North 89°22'18" East parallel with said North line 1146.66 feet; thence South 00°41'18" West 522.54 feet; thence South 53°25'42" West 151.77 feet; thence South 01°04'49" West 520.90 feet; thence South 52°17'08" West 119.82 feet; thence South 00°38'03" West 385.72 feet; thence South 75°15'20" West 85.80 feet; thence South 00°42'33" West 279.84 feet; thence South 39°38'29" West 534.74 feet to the South line of said Northwest Quarter; thence South 89°26'37" West along said South line 1914.02 feet to the Southwest corner of said Northwest Quarter; thence North 00°15'15" East along the West line of said Northwest Quarter 2639.54 feet to the point of beginning, containing **135.925 Acres**, subject to road right of way easements across the West and North 33.00 feet thereof and any other easements or restrictions of record.

PARCEL 2

A portion of the Northwest Quarter of Section 32, Township 20 South, Range 1 West of the 6th Principal Meridian, McPherson County, Kansas described as follows:

Beginning at the Northeast corner of the Northwest Quarter of Section 32, Township 20 South, Range 1 West of the 6th Principal Meridian; thence on a NAD 83 Kansas Zone 1502 bearing of South 00°05'27" West along the East line of said Northwest Quarter 2642.75 feet to the Southeast corner of said Northwest Quarter; thence South 89°26'37" West along the South line of said Northwest Quarter 730.23 feet to a point 1914.02 East of the Southwest corner of said Northwest Quarter; thence North 39°33'29" East 534.74 feet; thence North 00°42'33" East 279.84 feet; thence North 75°15'20" East 85.80 feet; thence North 00°38'03" East 385.72 feet; thence North 52°17'08" East 119.82 feet; thence North 01°04'49" East 520.90 feet; thence North 53°25'42" East 151.77 feet; thence North 00°41'18" East 522.54 feet; thence South 89°22'18" West parallel with the North line of said Northwest Quarter 1146.66 feet; thence North 00°37'42" West perpendicular to said North line 342.38 feet to a point on said North line, said point being 1416.00 feet East of the Northwest corner of said Northwest Quarter; thence North 89°22'18" East along said North line 1220.77 feet to the point of beginning, containing **24.159 Acres**, subject to a road right of way easement across the North 33.00 feet thereof and any other easements or restrictions of record.

SURVEYOR'S CERTIFICATE:

I hereby certify this plat to be a true, correct and complete representation of the property described hereon, as surveyed under my supervision, this 27th day of May, 2014.

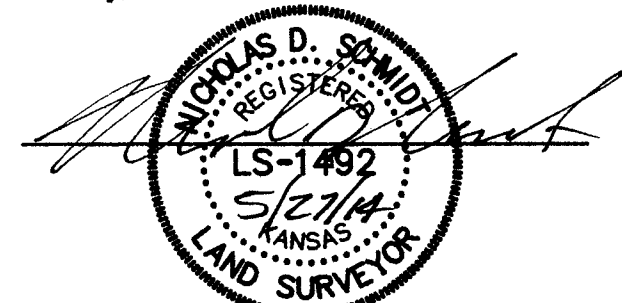

Prepared For: TY KAUFMAN		Description: PORTIONS OF THE NW 1/4 SECTION 32, T20S, R1W McPHERSON COUNTY, KANSAS	
Prepared By: GSS		Garber Surveying Service, P.A.	
HUTCHINSON (Main Office) 2908 North Plum St. 67502 Ph. 620-665-7032 Fax 620-663-7401 McPHERSON (Branch Office) 115 East Marlin 67460 Ph. 620-241-4441 Fax 620-241-4458 NEWTON (Branch Office) 511 North Poplar St. 67114 Ph. 316-283-5053 Fax 316-283-5073			
Drawn By: KLL	Scale: 1"=200'	Date of Field Work: May 20, 2014	Job No:
Checked By: NDS	Date: 05/27/2014	Sheet 1 of 1 Sheet(s)	G2014-349