

Copyright © 2025 Garber Surveying Service, P.A. Saved 4/21/2025 2:50:21 PM by KLVON
Plot Date & Time Tuesday, April 22, 2025 9:54:35 AM Dwg Path \\gis1\Company\LDN_GSSFILES\2025\20250187_C3d\dwg\20250187_KT_Auto_SPC_1502_(ModtoGnd)

25th AVENUE
N 00°16'09" E 2,639.46' (M)

NW Cor. SW 1/4
Sec. 32, T20S, R1W
Fd. 5/8" Rebar w/GSS Cap
from GSS G2017-816 dated 1-3-18

NE Cor. SW 1/4
Sec. 32, T20S, R1W
Fd. 5/8" Rebar w/GSS Cap
from GSS G2014-296 dated 5-5-14

1,339.82' (C)
1,372.82' (M)

1,271.48' (M)

N 89°26'40" E 2,644.30' (M)

S 00°33'23" E 2,145.26' (M)

Parcel 1
72.244 Acres

Parcel 2
82.168 Acres

- LEGEND**
- △ - Sectional Monument Found
 - - 5/8" x 24" Iron Rebar Set w/GSS Cap
 - - Survey Monument Found
 - (C) - Calculated
 - (M) - Measured
 - P.O.B. - Point of Beginning

-200 0 200 400 600

BASIS OF BEARING = NAD 83 KANSAS SOUTH ZONE

DESCRIPTION:

PARCEL 1:

A portion of the Southwest Quarter of Section 32, Township 20 South, Range 1 West of the 6th Principal Meridian, McPherson County, Kansas, more particularly described by Daniel E. Garber, Professional Surveyor #683, on April 18, 2025 as follows:

Beginning at the Southwest corner of the Southwest Quarter of Section 32, Township 20 South, Range 1 West of the 6th Principal Meridian; Thence with a bearing of North 00°15'09" East (basis of bearings is NAD-83 Kansas South Zone) along the West line of said Southwest Quarter a distance of 2,639.46 feet to the Northwest corner of said Southwest Quarter; Thence North 89°26'40" East along the North line of said Southwest Quarter a distance of 1,372.82 feet (said point being 1,271.48 feet West of the Northeast corner of said Southwest Quarter); Thence South 00°33'23" East a distance of 2,145.26 feet; Thence South 89°17'54" West a distance of 550.00 feet; Thence South 89°19'00" West a distance of 200.53 feet; Thence North 45°00'59" West a distance of 141.47 feet; Thence South 89°19'31" West a distance of 186.58 feet; Thence South 00°47'19" East a distance of 178.49 feet; Thence South 44°59'55" East a distance of 29.98 feet; Thence South 00°50'37" East a distance of 391.79 feet to the South line of said Southwest Quarter; Thence South 89°18'10" West along the South line of said Southwest Quarter a distance of 397.57 feet to the point of beginning, containing **72.244 Acres**, and subject to road right-of-way easements across the South and West 33.00 feet thereof and any other easements and restrictions of record.

PARCEL 2:

A portion of the Southwest Quarter of Section 32, Township 20 South, Range 1 West of the 6th Principal Meridian, McPherson County, Kansas, more particularly described by Daniel E. Garber, Professional Surveyor #683, on April 18, 2025 as follows:

Beginning at the Southeast corner of the Southwest Quarter of Section 32, Township 20 South, Range 1 West of the 6th Principal Meridian; Thence with a bearing of South 89°18'10" West (basis of bearings is NAD 83 Kansas South Zone) along the South line of said Southwest Quarter a distance of 1,789.31 feet (said point being 862.53 feet East of the Southwest corner of said Southwest Quarter); Thence North 00°50'29" West a distance of 490.40 feet; Thence North 89°17'54" East a distance of 550.00 feet; Thence North 00°33'23" West a distance of 2,145.26 feet to the North line of said Southwest Quarter; Thence North 89°26'40" East along the North line of said Southwest Quarter a distance of 1,271.48 feet to the Northeast corner of said Southwest Quarter; Thence South 00°05'27" West along the East line of said Southwest Quarter a distance of 2,632.80 feet to the point of beginning, containing **82.168 Acres**, and subject to a road right-of-way easement across the South 33.00 feet thereof and any other easements and restrictions of record.

SURVEYOR'S CERTIFICATE:

I hereby certify this plat to be a true, correct and complete representation of the property described hereon, as surveyed under my supervision, this 22nd day of April, 2025.

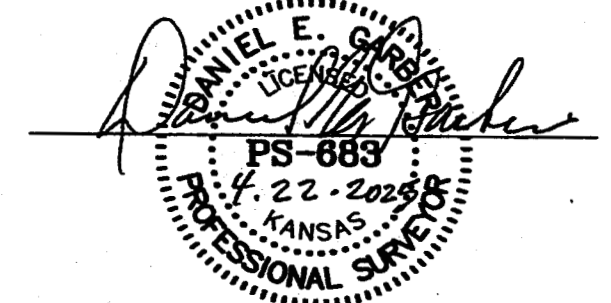

CHISHOLM ROAD

SW Cor. SW 1/4
Sec. 32, T20S, R1W
Fd. 5/8" Rebar
from GSS G2016-121 dated 2-29-16
P.O.B. 1

P.O.B. 2
SE Cor. SW 1/4
Sec. 32, T20S, R1W
Fd. 5/8" Rebar
from GSS G2016-121 dated 2-29-16

Prepared For:

CHRISTINE REINERT

Description:

**A PORTION OF THE SW 1/4
SECTION 32, T20S, R1W
MCPHERSON COUNTY, KANSAS**

Prepared By:

Garber Surveying Service, P.A.



HUTCHINSON
2908 North Plum St. 67502
Ph. 620-665-7032
(Main Office)

BRANCH OFFICES:
MANHATTAN Ph. 785-320-4810
MCPHERSON Ph. 620-241-4441
NEWTON Ph. 316-283-5053
SALINA Ph. 785-404-6302
WICHITA Ph. 316-260-9933

Drawn By: KLL

Scale: 1"=300'

Date of Field Work: April 3, 2025

Job No:

Checked By: DEG

Date: 04/22/2025

Sheet 1 of 1 Sheet(s)

G2025-187