

NORTH

SE 1/4 Section 32-T20S-R1W

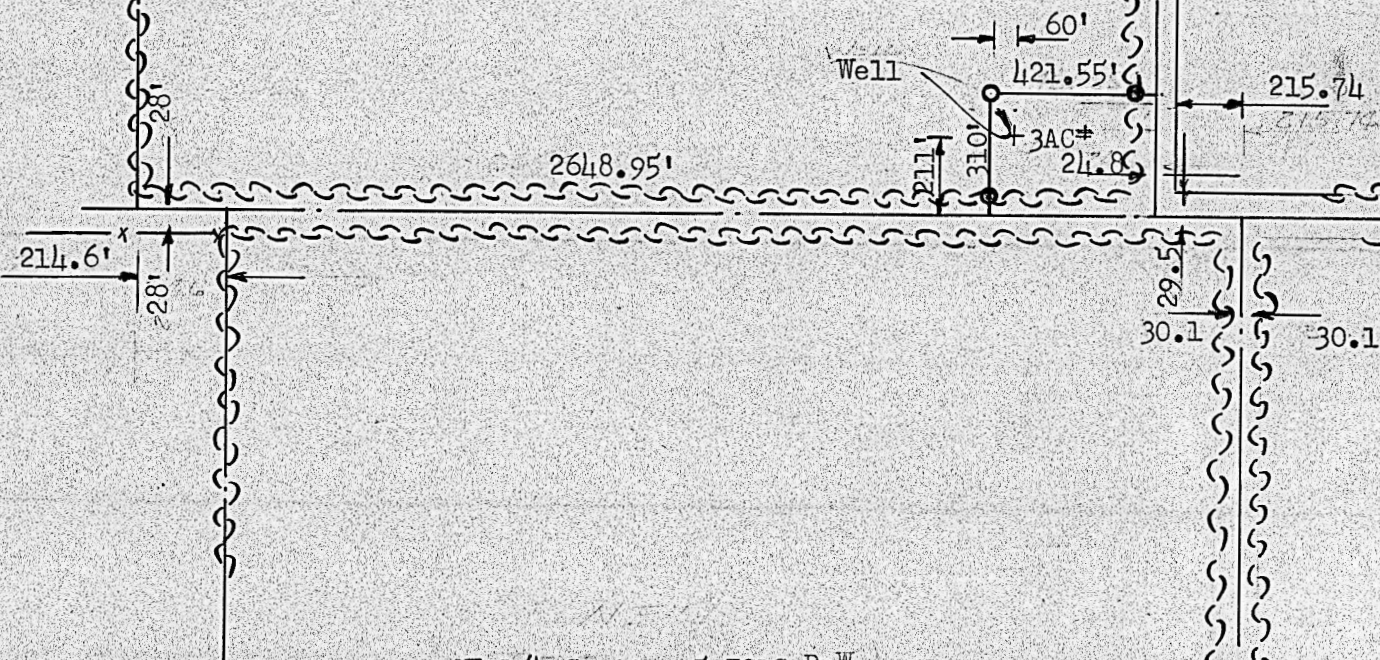

NE 1/4 Section 5-T21S-R1W

STATE OF KANSAS
COUNTY OF MCPHERSON

I, Francis D. Wagner, County Engineer of McPherson County, Kansas, do hereby certify that I did cause to be done on the 11th day of May, 1954 a survey to establish the corners of a tract of land in the Southeast quarter of Section 32-T20S-R1W of the 6th P. M. Described as follows:

Beginning at the Southeast corner of Section 32-T20S-R1W, thence 310' feet North along the section line between Sections 32 & 33-T20S-R1W, thence 421.55 feet west parallel to the South Section line of said SE quarter; thence 310 feet South to section line; thence 421.55' feet East along the South section line of Section 32-T20S-R1W to the place of beginning, tract of land contains 3.0AC±.

MICROFILM

2561.20'

30.4'

30.4'