

DESCRIPTION:

A portion of the West Half of the Southeast Quarter of Section 29, Township 21 South, Range 2 West of the 6th Principal Meridian, McPherson County, Kansas described as follows:

Commencing at the Southwest corner of said Southeast Quarter; thence on a NAD 83 Kansas South Zone bearing of North 89°34'33" East on the South line of said Southeast Quarter a distance of 592.49 feet to the point of beginning; North 00°25'27" West perpendicular to said South line a distance of 877.81 feet; thence North 89°34'33" East parallel with said South line a distance of 363.06 feet; thence South 00°25'27" East perpendicular to said South line a distance of 877.81 feet to said South line; thence South 89°34'33" West on said South line a distance of 363.06 feet to the point of beginning.

Containing 7.32 Acres and subject to a road right of way easement along the South line thereof, and any other easements or restrictions of record.

SURVEYOR'S NOTE:

- Survey was made as per client request and no title work has been provided to the surveyor; therefore, the number and extent of easements and/or rights-of-way of record affecting said property has not been verified by this Survey.

SURVEYOR'S CERTIFICATE:

I hereby certify this plat to be a true, correct and complete representation of the property described hereon, as surveyed under my supervision, this 13th day of September, 2021.

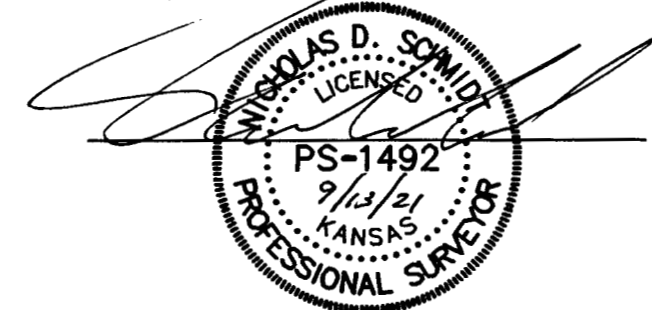

Prepared For: LYNN D. STUCKY		Description: A PORTION OF THE W 1/2, SE 1/4 SECTION 29, T21S, R2W McPHERSON COUNTY, KANSAS	
Prepared By: GSS HUTCHINSON 2908 North Plum St. 67502 Ph. 620-665-7032 (Main Office)		Branch Offices: MANHATTAN Ph. 785-320-4810 MCPHERSON Ph. 620-241-4441 NEWTON Ph. 316-283-5053 SALINA Ph. 785-404-6302 WICHITA Ph. 316-260-9933	
Drawn By: KDZ	Scale: 1"=100'	Date of Field Work: August 27, 2021	Job No: G2021-945
Checked By: NDS	Date: 09/13/2021	Sheet 1 of 1 Sheet(s)	