

LEGEND

- △ - Sectional Monument Found
- ▲ - Section Monument Set (5/8" x 24" Iron Rebar w/G.S.S. Cap)
- - Survey Monument Found (5/8" Rebar)
- - 5/8" x 24" Iron Rebar Set w/G.S.S. Cap
- (C) - Calculated
- (M) - Measured
- (R) - Record measurement
- (Book 218, page 288 and Book 611, Page 292)
- (PS) - Previous Survey GSS Project # G82-121
- P.O.C. - Point of Commencement
- P.O.B. - Point of Beginning

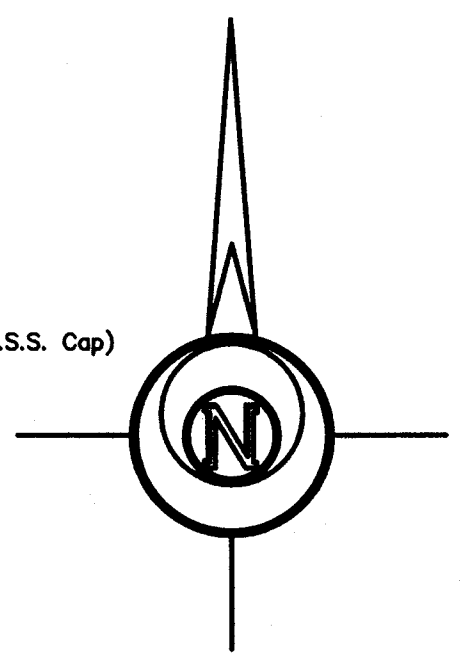

BASIS OF BEARING = ASSUMED

DESCRIPTION:
Parcel 1

A portion of the West Half of the Northwest Quarter of Section 29, Township 20 South, Range 3 West of the 6th Principal Meridian, McPherson County, Kansas described as follows:
Beginning at the Northwest Corner of the Northwest Quarter of Section 29, Township 20 South, Range 3 West of the 6th Principal Meridian; thence North 90°00'00" East along the North line of the West Half of said Northwest Quarter 1010.00 feet to the point of beginning; thence continuing North 90°00'00" East along the North line of said West Half 308.51 feet to the Northeast corner of said West Half; thence South 00°19'28" West along the East line of said West Half 2648.17 feet to the Southeast corner of said West Half; thence North 89°54'16" West along the South line of said West Half 358.51 feet; thence North 00°00'00" East perpendicular to the North line of said West Half 1814.52 feet; thence North 90°00'00" East parallel with the North line of said West Half 65.00 feet; thence North 00°00'00" East perpendicular to the North line of said West Half 833.00 feet to the point of beginning, containing **21.005 Acres** and subject to a road right-of-way easement across the North 50.00 feet thereof and any other easements of record.

Parcel 2

A portion of the West Half of the Northwest Quarter of Section 29, Township 20 South, Range 3 West of the 6th Principal Meridian, McPherson County, Kansas described as follows:
Beginning at the Northwest Corner of the Northwest Quarter of Section 29, Township 20 South, Range 3 West of the 6th Principal Meridian; thence North 90°00'00" East along the North line of the West Half of said Northwest Quarter 1010.00 feet; thence South 00°00'00" West perpendicular to the North line of said West Half 350.00 feet to the point of beginning; thence continuing South 00°00'00" West perpendicular to the North line of said West Half 483.00 feet; thence South 90°00'00" West parallel with the North line of said West Half 875.10 feet; thence North 03°35'23" West 843.16 feet; thence North 77°01'30" West 203.37 feet; thence North 52°35'20" West 235.15 feet; thence North 01°26'34" East 266.97 feet to a point that is 350.00 feet South of the North line of said West Half; thence North 90°00'00" East parallel with the North line of said West Half 519.28 feet to the point of beginning containing **5.954 Acres**, subject to easements of record.

SURVEYOR'S CERTIFICATE:

I hereby certify this plat to be a true, correct and complete representation of the property described herein, as surveyed under my supervision, this 26th day of October, 2011.

SE Cor. NE 1/4
Sec. 29, T20S, R3W
Fd. 5/8" Rebar
Origin Unknown

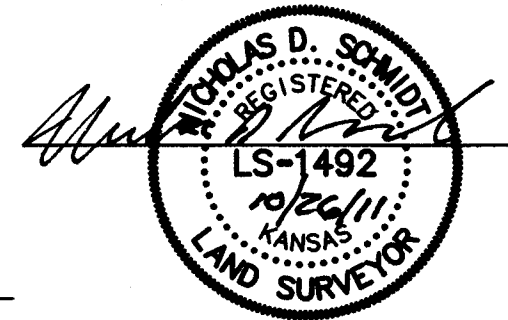

Prepared For: JEFF FOSTER		Description: A PORTION OF THE NW 1/4 SEC. 29, T20S, R3W MCPHERSON COUNTY, KS.	
Prepared By: GSS		Garber Surveying Service, P.A. 2908 North Plum St. Hutchinson, Kansas 67502 Phone (620) 665-7032 • FAX (620) 663-7401 811 North Poplar Street Newton, Kansas 67114 Phone (316) 283-5053 • FAX (316) 283-5073	
Drawn By: KLL	Scale: 1"=200'	Date of Field Work: October 14, 2011	Job No: G2011-564
Checked By: NDS	Date: 10/26/2011	Sheet 1 of 1 Sheet(s)	