

BASIS OF BEARING = NAD 83 KANSAS SOUTH ZONE

LEGEND

- △ - Sectional Monument Found
- ▲ - Section Monument Set (5/8" x 24" Iron Rebar w/GSS CLS 52 Cap)
- - Fd. 5/8" Rebar w/GSS Cap
- - 5/8" x 24" Iron Rebar Set w/GSS CLS 52 Cap
- ✱ - Proposed Fence
- (C) - Calculated
- (M) - Measured
- (PS) - Previous Survey GSS Project #G2004-237

DESCRIPTION:

The North Half of the Southeast Quarter of Section 29,
Township 20 South, Range 2 West of the 6th Principal Meridian
McPherson County, Kansas.

EXCEPT

A portion of the North Half of the Southeast Quarter of Section 29, Township 20 South, Range 2 West of the 6th Principal Meridian, McPherson County, Kansas described as follows:

Beginning at the Southeast corner of the North Half of said Southeast Quarter; thence West along the South line of the North Half of said Southeast Quarter 775.00 feet; thence with a deflection angle 89°42'40" right-North parallel with the East line of said Southeast Quarter 282.89 feet; thence with a deflection angle 90°17'00" right-East 229.62 feet; thence with a deflection angle 88°16'04" left-North 442.30 feet; thence with a deflection angle 88°48'26" right-East 529.87 feet to the East line of said Southeast Quarter; thence with a deflection angle 89°10'38" right-South along the East line of said Southeast Quarter 720.07 feet to the point of beginning, containing 10.460 Acres, subject to a road right-of-way easement across the East 33.00 feet thereof and any other easements of record.

SURVEYOR'S CERTIFICATE:

I hereby certify this plat to be a true, correct and complete representation of the property described hereon, as surveyed under my supervision, this 7th day of November, 2022.

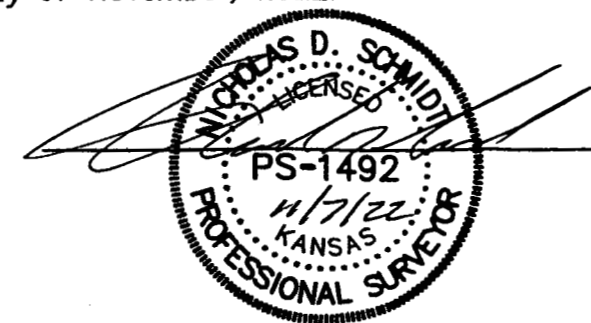

SURVEYOR'S NOTE:

- SURVEYOR'S NOTE:**
1. Survey was made as per client request and no title work has been provided to the surveyor; therefore, the number and extent of easements and/or rights-of-way of record affecting said property has not been verified by this Survey.
 2. Total Acreage = 69.44 Acres.
 3. Total Paddock Acreage = 53.51 Acres.
 4. Total Fence = 16,660 Feet.

Prepared For:

MONROE BECKER

Description:

Description:
A PORTION OF THE SE 1/4
SECTION 29, T20S, R2W
McPHERSON COUNTY, KANSAS

Prepared By:

Garber Surveying Service, P.A.



HUTCHINSON
2908 North Plum St. 6756
Ph. 620-665-7032
(Main Office)

BRANCH OFFICES: **MANHATTAN** Ph. 785-320-4810
MCPHERSON Ph. 620-241-4441 **NEWTON** Ph. 316-283-5053
SALINA Ph. 785-404-6302 **WICHITA** Ph. 316-260-9933

Drawn By:

Scale: 1"=200'

Date of Field Work: September 7, 2022

Job No:

Checked By:

Date: 11/7/2022

Sheet 1 of 1 Sheet(s)

G2022-757